

SONY

4-461-833-61(1)

Personal Audio System

Operating Instructions **GB**



©2013 Sony Corporation Printed in China

<http://www.sony.net/>

RDP-M7iPN

WARNING

To reduce the risk of fire or electric shock, do not expose this apparatus to rain or moisture.

To reduce the risk of fire, do not cover the ventilation of the apparatus with newspapers, tablecloths, curtains, etc. And do not place lighted candles on the apparatus.

To reduce the risk of fire or electric shock, do not expose this apparatus to dripping or splashing, and do not place objects filled with liquids, such as vases, on the apparatus.

Do not install the appliance in a confined space, such as a bookcase or built-in cabinet.

Do not expose the batteries (battery pack or batteries installed) to excessive heat such as sunshine, fire or the like for a long time.

As the main plug of AC adaptor is used to disconnect the AC adaptor from the mains, connect it to an easily accessible AC outlet. Should you notice an abnormality in it, disconnect it from the AC outlet immediately.

The unit is not disconnected from the AC power source (mains) as long as it is connected to the wall outlet, even if the unit itself has been turned off.

The nameplate and important information concerning safety are located on the bottom exterior of the main unit and on the surface of the AC adaptor.

CAUTION

Danger of explosion if battery is incorrectly replaced. Replace only with the same type.

Notice for customers: the following information is only applicable to equipment sold in countries applying EU directives

This product has been manufactured by or on behalf of Sony Corporation, 1-7-1 Konan Minato-ku Tokyo, 108-0075 Japan. Inquiries related to product compliance based on European Union legislation shall be addressed to the authorized representative, Sony Deutschland GmbH, Hedelfinger Strasse 61, 70327 Stuttgart, Germany. For any service or guarantee matters, please refer



Disposal of Old Electrical & Electronic Equipment (Applicable in the European Union and other European countries with separate collection systems)

This symbol on the product or on its packaging indicates that this product shall not be treated as household waste. Instead it shall be handed over to the applicable collection point for the recycling of electrical and electronic equipment. By ensuring this product is disposed of correctly, you will help prevent potential negative consequences for the environment and human health, which could otherwise be caused by inappropriate waste handling of this product. The recycling of materials will help to conserve natural resources. For more detailed information about recycling of this product, please contact your local Civic Office, your household waste disposal service or the shop where you purchased the product. Applicable accessory: Remote control



Disposal of waste batteries (applicable in the European Union and other European countries with separate collection systems)

This symbol on the battery or on the packaging indicates that the battery provided with this product shall not be treated as household waste. On certain batteries this symbol might be used in combination with a chemical symbol. The chemical symbols for mercury (Hg) or lead (Pb) are added if the battery contains more than 0.0005% mercury or 0.004% lead. By ensuring these batteries are disposed of correctly, you will help prevent potentially negative consequences for the environment and human health which could otherwise be caused by inappropriate waste handling of the battery. The recycling of the materials will help to conserve natural resources.

In case of products that for safety, performance or data integrity reasons require a permanent connection with an incorporated battery, this battery should be replaced by qualified service staff only.

To ensure that the battery will be treated properly, hand over the product at end-of-life to the applicable collection point for the recycling of electrical and electronic equipment.

For all other batteries, please view the section on how to remove the battery from the product safely. Hand the battery over to the applicable collection point for the recycling of waste batteries.

For more detailed information about recycling of this product or battery, please contact your local Civic Office, your household waste disposal service or the shop where you purchased the product.

If you have any questions or problems concerning your unit, please consult your nearest Sony dealer.

General Information

Troubleshooting

General

There is no power.

- Make sure the AC adaptor is connected to the wall outlet firmly.
- Make sure the batteries are inserted correctly.
- Replace all the batteries with new ones if they are weak.

There is no sound.

- Adjust **VOLUME +/-** (**VOL +/-** on the remote). **There is noise.**
- Make sure that the unit is not in the vicinity of in-use portable phones, etc.
- If you use an audio connecting cable, disconnect the cable when it is not in use.

Two different music sources are mixed together during playback.

- Stop playback of either the iPod or the optional component.

The OPR/BATT indicator flashes.

- The **OPR/BATT** indicator flashes when the unit receives a signal from the remote, or when the batteries are weak. In these cases, the flashing does not mean there is an error or fault.

iPod

There is no sound.

- Make sure the iPod is connected firmly.
- An operation is not performed.**
- Make sure the iPod is connected firmly.
 - Check that the iPod is compatible with this unit (see “Compatible iPod/iPhone models”).
- The iPod does not charge.**
- Make sure the iPod is connected firmly.
 - Make sure the AC adaptor is connected firmly.
 - Check that the iPod is compatible with this unit (see “Compatible iPod/iPhone models”).

Audio-in

There is no sound.

- Make sure the audio connecting cable is connected firmly.
 - Make sure that the connected component is on playback status.
- The sound is low.**
- Check the volume of the connected optional component.

Remote control

The remote does not function.

- Replace the battery in the remote with a new one if it is weak.
- Make sure that you are pointing the remote at the remote sensor on the unit.
- Do not cover or place any objects just in front of the  receiver.
- Remove any obstacles in the path of the remote and the unit.
- Make sure the remote sensor is not exposed to strong light such as direct sunlight or fluorescent lamp light.

If the problem persists, consult your nearest Sony dealer.

Specifications

iPod

Rated voltage: DC 5 V

Rated current: Max. 1 A

General

Speaker

Approx. 50 mm dia. × 2

Input

AUDIO IN jack (ø 3.5 mm stereo minijack)

Input impedance: 10 kΩ

Standard input level: 245 mV

Power output

2 W + 2 W (at 10% harmonic distortion)

Power source

Rated external power source: DC IN 6V, 1.3 A (With supplied AC adaptor (AC 230 V, 50 Hz)) or 4 × AAA/LR03 type batteries

Battery life:

Approx. 10 hours (Sony manufactured AAA/LR03 alkaline batteries)

Approx. 8 hours (Sony manufactured NH-AAA rechargeable batteries)

Dimensions

Approx. 226 mm × 165 mm × 151 mm (w/h/d)

(Including projecting parts and controls)

Mass

Approx. 1.1 kg (Including batteries)

Supplied accessories

AC adaptor (1)

Remote control (with a lithium battery) (1)

Operating Instructions (1)

Design and specifications are subject to change without notice.

Continued on the reverse side

Startup Guide

1

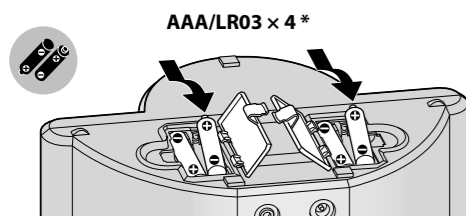
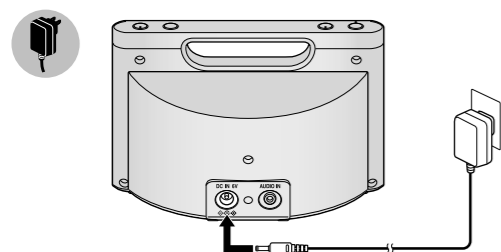

2

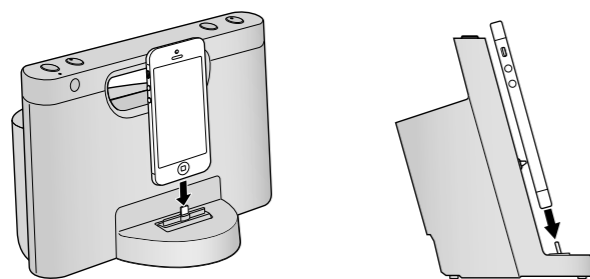

3

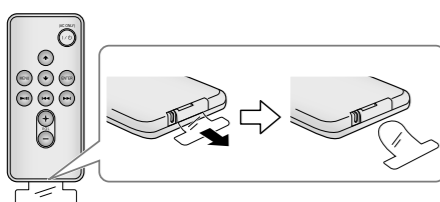

4

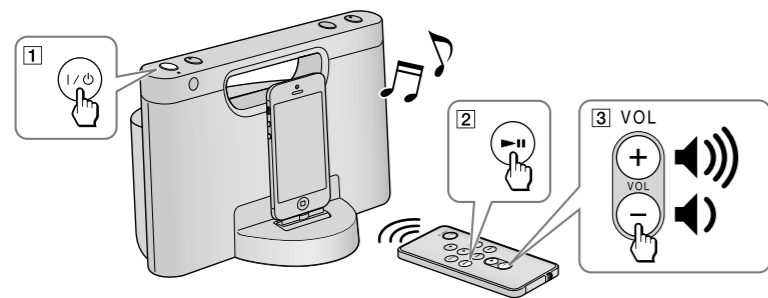

* Alkaline batteries are not supplied. Manganese batteries (R03) cannot be used. The unit cannot recharge any batteries.

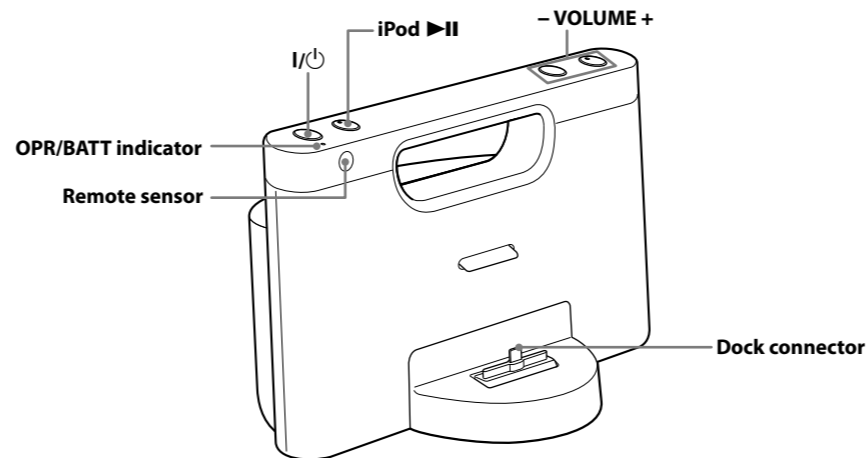

The VOLUME + and ►II buttons have a tactile dot.

Operations

How to handle an iPod

To set an iPod

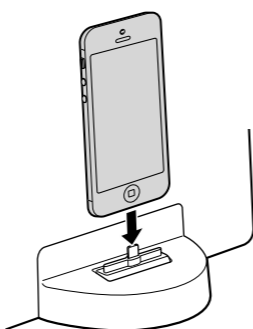

To remove an iPod

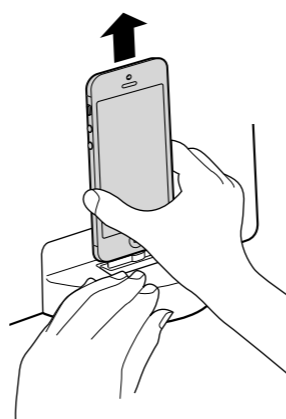

Notes

- An iPod in a case or cover can be set in this unit. However, if the case or cover interferes with the connection, remove the case or cover before setting the iPod on the dock connector.
- When placing or removing the iPod, hold it at the same angle as the dock connector on the unit. Do not pull the iPod forward too far.
- When placing or removing the iPod, hold the unit securely.
- Do not twist or bend the iPod as this may result in connector damage.
- Remove the iPod when transporting it; otherwise, a malfunction may result.

Power source

You can use this unit with mains electricity or with batteries.

Auto power off

After playback of an iPod (or component connected to the **AUDIO IN** jack) has finished, if no operation is performed for about 20 minutes, the unit will automatically turn off.

To use AC adaptor

Connect the supplied AC adaptor to the **DC IN 6V** jack on the back of this unit firmly, and then plug the adaptor into a wall outlet.

Note on the AC adaptor

- When operating the unit with internal batteries, remove the AC adaptor from the wall outlet and the **DC IN 6V** jack. Make sure that the plug of the external power source is disconnected before operating the unit.
- Use the supplied Sony AC adaptor only. The polarity of the plugs of other manufacturers may be different. Failure to use the supplied AC adaptor may cause the unit to malfunction.



To use batteries

Insert four AAA/LR03 alkaline batteries, or four NH-AAA rechargeable batteries (not supplied).

When to replace the batteries

When the batteries are weak, the **OPR/BATT** indicator will become faint, and the sound may be distorted.

Notes on batteries

- Manganese batteries cannot be used.
- The unit cannot recharge any batteries.
- Do not carry batteries with coins or other metallic objects. It can generate heat if the positive and negative terminals of the batteries are accidentally contacted by a metallic object.
- Be sure to observe the correct polarity when installing the battery.
- If you are not going to use the unit for a long time, remove the batteries to avoid damage from battery leakage and corrosion.
- Do not use different types of batteries at the same time.
- When you replace the batteries, replace all of them with new ones.
- Battery performance depends on manufacturer and type, and battery life may be reduced, especially when used in low temperature.

Remote control

Before using the supplied remote for the first time, remove the insulation film. Aim the remote at the  (Remote sensor) of the unit. The **OPR/BATT** indicator flashes when the remote's signal is received.

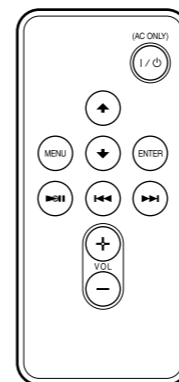

The VOL + and ►II buttons have a tactile dot.

I/⏻ (On/Standby)

- Turns the unit on/off. The **OPR/BATT** indicator lights up when the unit is turned on.
- When using batteries, press the I/⏻ button on the unit. The I/⏻ button of the remote works only when the AC adaptor is used.

►II (Play/Pause)

- Start playing an iPod. Press again to pause/resume playback.

▶▶ (Forward)

- Go to the next track.
- Press and hold while listening to the sound to locate a desired point.

◀◀ (Backward)

- Go back to the previous track. During playback, this operation returns to the beginning of the current track. To go back to the previous track, press twice.
- Press and hold while listening to the sound to locate a desired point.

MENU

- Go back to the previous menu.

▲ (Up)/▼ (Down)

- Select a menu item or track for playback.

ENTER

- Execute the selected menu item or begin playback.

VOL +/- (Volume plus/minus)

- Adjust the volume.

Note

- Some operations may differ or may not be available for different models of iPod.

When to replace the battery

With normal use, battery life (CR2025) should last for about 6 months. When the remote can no longer operate the unit, replace the battery with a new one.

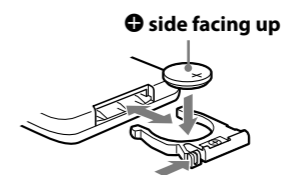

Note

- If you are not going to use the remote for a long time, remove the battery to avoid any damage that may be caused by leakage and corrosion.

Compatible iPod/iPhone models

The compatible iPod/iPhone models are as follows.

Update the software of the iPod/iPhone to the latest version before using it with this unit.

iPod touch (5th generation)
iPod nano (7th generation)*
iPhone 5

* The iPod nano (7th generation) cannot be controlled by the remote when the command of "MENU," "▲," "▼," and "ENTER" is pressed.

On copyrights

iPhone, iPod, iPod nano, and iPod touch are trademarks of Apple Inc., registered in the U.S. and other countries.

Lightning is a trademark of Apple Inc. "Made for iPod," and "Made for iPhone" mean that an electronic accessory has been designed to connect specifically to iPod or iPhone, respectively, and has been certified by the developer to meet Apple performance standards. Apple is not responsible for the operation of this device or its compliance with safety and regulatory standards. Please note that the use of this accessory with iPod or iPhone may affect wireless performance.

Note

- This unit is not specified for use with an iPad, and malfunction may result if used with one.

Operating an iPod

1 Set an iPod on the dock connector.

The dock connector can be tilted slightly. For details, see "How to handle an iPod."

2 Press ►II.

When using batteries, press I/⏻ on the unit, then press ►II.

The iPod begins playback.

You can operate the connected iPod via this unit or the iPod itself.

Notes

- If a pop-up message appears on the display of the iPod touch or iPhone, see "About App."
- If the battery of the iPod is extremely low, charge it for a while before operation.
- Sony cannot accept responsibility in the event that data recorded to an iPod is lost or damaged when using an iPod connected to this unit.
- For details of environmental conditions for operating the iPod, check the website of Apple Inc.

To remove the iPod

For details, see "How to handle an iPod."

To adjust the volume

Press **VOLUME +/-** (**VOL +/-** on the remote).

Tip

- The **OPR/BATT** indicator flashes three times when the sound is set to either maximum or minimum volume.

To charge an iPod (AC only)

You can use the unit as a battery charger for an iPod when the power is supplied by the AC adaptor. Charging begins when the iPod is connected to the unit. The charging status appears in the display on the iPod. For details, refer to the user's guide of the iPod.

Connecting optional components

You can enjoy the sound from an optional component, such as a portable digital music player, through the speakers of this unit. Be sure to turn off the power of each component before making any connections.

1 Firmly connect the line output jack of a portable digital music player (or other component) to the **AUDIO IN** jack on the back of the unit, using a suitable audio connecting cable (not supplied).

2 Press I/⏻ to turn on the unit.

3 Turn the connected component on.

4 Play the connected component.

The sound from the connected component is output from the speakers of this unit.

Notes

- The necessary type of audio connecting cable depends on the optional component. Make sure to use the correct type of cable.
- If the volume level is low, adjust the volume of the unit first. If the volume is still too low, adjust the volume of the connected component.
- When playing an optional component connected to the **AUDIO IN** jack, stop playback of an iPod.
- Disconnect the audio connecting cable from the unit when it is not in use.

About App

A dedicated Dock App for iPod touch/iPhone available at Apple App Store.

Search for "D-Sappli" and download the free App to find out more about the functions.

Features

- D-Sappli includes various timer functions: Alarm, Music Play Timer, and Sleep Timer.
- You can set up to 10 alarms, using songs in iPod or Preset Sound in D-Sappli for the alarm sound.

The Music Play Timer allows you to play/pause desired music at a desired time. The Sleep Timer allows you to specify a time at which to stop music playback. The Music Play Timer and Sleep Timer work in combination with the power supply of the unit.

Music Play Timer, Sleep Timer and Alarm are available only when D-Sappli is activated.

- D-Sappli also includes a clock display enlarge feature.

Notes

- If the App to link with this unit is not downloaded to your iPod touch/iPhone, a pop-up message prompting you to download D-Sappli may appear repeatedly. Deactivate the App's link function to stop the pop-up message.
- To deactivate the App's link function: Connect the AC adaptor, and then press I/⏻ to turn off the unit. Remove your iPod touch/iPhone from the dock connector. While holding down ►II, also press and hold I/⏻ on the unit for at least 2 seconds. (The **OPR/BATT** indicator flashes twice when the function is deactivated.)
- To re-activate the App's link function, repeat the above steps. (The **OPR/BATT** indicator flashes once when the function is activated.)