

## Personal Audio Docking System

Reference Guide GB

**DAB** **DAB+**

Made for  
**iPod** **iPhone**

Available on the  
**App Store**

NO POWER  
NO PROBLEM

No Power No Problem is a trademark of Sony Corporation.



\* 4 4 3 7 1 4 1 1 1 \* (1)

©2012 Sony Corporation Printed in China

<http://www.sony.net/>

XDR-DS16iP

## WARNING

To reduce the risk of fire or electric shock, do not expose this apparatus to rain or moisture.

To reduce the risk of fire, do not cover the ventilation of the apparatus with newspapers, tablecloths, curtains, etc. And do not place litged candles on the apparatus.

To reduce the risk of fire or electric shock, do not expose this apparatus to dripping or splashing, and do not place objects filled with liquids, such as vases, on the apparatus.

Do not install the appliance in a confined space, such as a bookcase or built-in cabinet.

Do not expose the batteries (battery pack or batteries installed) to excessive heat such as sunshine, fire or the like for a long time.

As the main plug is used to disconnect the unit from the mains, connect the unit to an easily accessible AC outlet. Should you notice an abnormality in the unit, disconnect the main plug from the AC outlet immediately.

The unit is not disconnected from the AC power source (mains) as long as it is connected to the wall outlet, even if the unit itself has been turned off.

The nameplate and important information concerning safety are located on the bottom exterior.

### CAUTION

Danger of explosion if battery is incorrectly replaced. Replace only with the same type.

**Notice for customers: the following information is only applicable to equipment sold in countries applying EU directives**  
The manufacturer of this product is Sony Corporation, 1-7-1 Konan, Minato-ku, Tokyo, 108-0075 Japan. The Authorized Representative for EMC and product safety is Sony Deutschland GmbH, Hedelfinger Strasse 61, 70327 Stuttgart, Germany. For any service or guarantee matters, please refer to the addresses given in separate service or guarantee documents.

### On copyrights

iPhone, iPod, iPod classic, iPod nano, and iPod touch are trademarks of Apple Inc., registered in the U.S. and other countries. "Made for iPod," and "Made for iPhone" mean that an electronic accessory has been designed to connect specifically to iPod or iPhone, respectively, and has been certified by the developer to meet Apple performance standards. Apple is not responsible for the operation of this device or its compliance with safety and regulatory standards. Please note that the use of this accessory with iPod or iPhone may affect wireless performance.

### Note

- This unit is not specified for use with an iPad, and malfunction may result if used with one.

## Precautions

- To disconnect AC power, grasp the plug itself, not the cord.
- Since a strong magnet is used for the speaker, keep credit cards using magnetic coding or spring-wound watches, CRT-based TVs, or projectors, etc., away from the unit to prevent possible damage from the magnet.
- Do not leave the unit in a location near a heat source such as a radiator or airduct, or in a place subject to direct sunlight, excessive dust, mechanical vibration, or shock.
- Allow adequate air circulation to prevent internal heat build-up. Do not place the unit on a surface (a rug, a blanket, etc.) or near materials (a curtain) which might block the ventilation holes.
- Should any solid object or liquid fall into the unit, unplug the unit and have it checked by qualified personnel before operating it any further.
- During a thunderstorm, do not touch the antenna (aerial) and plug.
- Do not touch the unit with wet hands.
- Do not place the unit anywhere near water.

### NOTES ON LITHIUM BATTERY

- Wipe the battery with a dry cloth to assure a good contact.
- Be sure to observe the correct polarity when installing the battery.
- Do not hold the battery with metallic tweezers, otherwise a short-circuit may occur.

### Note

- In the Reference Guide, "iPod" is used as a general reference to functions on an iPod or iPhone, unless otherwise specified by the text or illustrations.



**Disposal of Old Electrical & Electronic Equipment (Applicable in the European Union and other European countries with separate collection systems)**

This symbol on the product or on its packaging indicates that this product shall not be treated as household waste. Instead it shall be handed over to the applicable collection point for the recycling of electrical and electronic equipment. By ensuring this product is disposed of correctly, you will help prevent potential negative consequences for the environment and human health, which could otherwise be caused by inappropriate waste handling of this product. The recycling of materials will help to conserve natural resources. For more detailed information about recycling of this product, please contact your local Civic Office, your household waste disposal service or the shop where you purchased the product. Applicable accessory: Remote control.



**Disposal of waste batteries (applicable in the European Union and other European countries with separate collection systems)**

This symbol on the battery or on the packaging indicates that the battery provided with this product shall not be treated as household waste. On certain batteries this symbol might be used in combination with a chemical symbol. The chemical symbols for mercury (Hg) or lead (Pb) are added if the battery contains more than 0.0005% mercury or 0.004% lead. By ensuring these batteries are disposed of correctly, you will help prevent potentially negative consequences for the environment and human health which could otherwise be caused by inappropriate waste handling of the battery. The recycling of the materials will help to conserve natural resources.

In case of products that for safety, performance or data integrity reasons require a permanent connection with an incorporated battery, this battery should be replaced by qualified service staff only.

To ensure that the battery will be treated properly, hand over the product at end-of-life to the applicable collection point for the recycling of electrical and electronic equipment.

For all other batteries, please view the section on how to remove the battery from the product safely. Hand the battery over to the applicable collection point for the recycling of waste batteries.

For more detailed information about recycling of this product or battery, please contact your local Civic Office, your household waste disposal service or the shop where you purchased the product.

If you have any questions or problems concerning your unit, please consult your nearest Sony dealer.

## General information

## Specifications

### Time display

Switching between 12-hour system (default) and 24-hour system

### iPod

DC out: 5V

MAX: 1A

### Radio

Band	Frequency	Frequency step
DAB (Band-III)	174.928 MHz - 239.200 MHz	
FM	87.5 MHz - 108 MHz	0.05 MHz

### DAB (Band-III) frequency table (MHz)

No.	Channel	Frequency
1	5A	174.928
2	5B	176.640
3	5C	178.352
4	5D	180.064
5	6A	181.936
6	6B	183.648

7	6C	185.360
8	6D	187.072
9	7A	188.928
10	7B	190.640
11	7C	192.352
12	7D	194.064
13	8A	195.936

14	8B	197.648
15	8C	199.360
16	8D	201.072
17	9A	202.928
18	9B	204.640
19	9C	206.352
20	9D	208.064

21	10A	209.936
22	10B	211.648
23	10C	213.360
24	10D	215.072
25	11A	216.928
26	11B	218.640
27	11C	220.352
28	11D	222.064
29	12A	223.936
30	12B	225.648

31	12C	227.360
32	12D	229.072
33	13A	230.784
34	13B	232.496
35	13C	234.208
36	13D	235.776
37	13E	237.488
38	13F	239.200

### General

**Speaker**  
Approx. 57 mm dia. 6 Ω (2)

**Input**  
AUDIO IN jack (ø 3.5 mm stereo minijack)

**Power output**  
3.5 W + 3.5 W (at 10% harmonic distortion)

**Power source**  
230 V AC, 50 Hz  
For clock back up: 3V DC, CR2032 battery (1)

**Dimensions**  
Approx. 290 mm × 165 mm × 145 mm (w/h/d) including projecting parts and controls

**Mass**  
Approx. 1.65 kg including power supply unit

**Supplied accessories**  
Remote control (with a lithium battery) (1)  
Startup Guide (1)

**Reference Guide** (this document) (1)  
Cushion for small-size iPod (1)

### Compatible iPod/iPhone models

The compatible iPod/iPhone models are as follows. Update the software of the iPod/iPhone to the latest version before using it with this unit.

iPod touch (4th generation)  
iPod touch (3rd generation)  
iPod touch (2nd generation)  
iPod nano (6th generation)\*  
iPod nano (5th generation)  
iPod nano (4th generation)  
iPod nano (3rd generation)  
iPod classic  
iPhone 4S  
iPhone 4  
iPhone 3GS  
iPhone 3G

- \* The iPod nano (6th generation) cannot be controlled by the remote when the command of “MENU,” “▶,” “◀,” and “ENTER” is pressed.

Design and specifications are subject to change without notice.

## Troubleshooting

Should any problem persist after you have made the following checks, consult your nearest Sony dealer.

**The clock flashes “AM 12:00” or “0:00” due to a power interruption.**

- The battery is low. Replace the battery. Remove the old battery and install a new one.
- Be sure to remove the insulation film of the backup battery before use.

**The alarm of the radio, iPod or buzzer does not sound at the preset alarm time.**

- Check that alarm “A” or alarm “B” is properly displayed.

**The alarm of the radio or iPod is activated but no sound comes on at the preset alarm time.**

- Check the alarm volume setting.
- There is no sound from the iPod.**
  - Make sure the iPod is securely connected.
  - Adjust the **VOLUME +** or – (**VOL +** or – on the remote).

**The iPod cannot be operated with this unit.**

- Make sure the iPod is securely connected.
- Check that the iPod is compatible with this unit (see “Compatible iPod/iPhone models”).

**The iPod cannot be charged.**

- Make sure the iPod is securely connected.
- Check that the iPod is compatible with this unit (see “Compatible iPod/iPhone models”).

## Preparations

## Power source

This unit contains a CR2032 battery as a backup power source to keep the alarm operating during a power interruption (No Power No Problem system).

### When to replace the battery

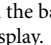
When the battery becomes weak, “” appears in the display.

If a power interruption occurs while the battery is weak, the current time will be erased. Replace the battery with a Sony CR2032 lithium battery. Use of another battery may cause a fire or explosion.

### To replace the battery

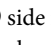
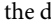
- Keep the AC plug connected to the AC outlet, remove the screw of the battery compartment on the bottom of the unit, and open the lid (see Fig. ❶).
- Remove the old battery and insert a new one in the battery compartment with the  side facing up (see Fig. ❷).
- Replace the battery compartment lid and tighten the screw.
- Press **▶■**, **DAB/FM**, **AUDIO IN** or **SNOOZE/BRIGHTNESS** to turn “” off in the display.

### Note

- When you replace the battery, do not disconnect the plug from the AC outlet.
- Otherwise, the current date and current time will be erased.

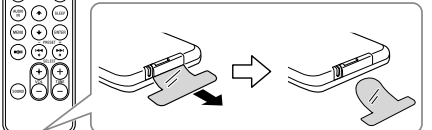
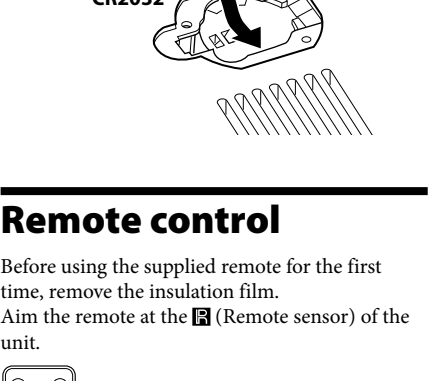
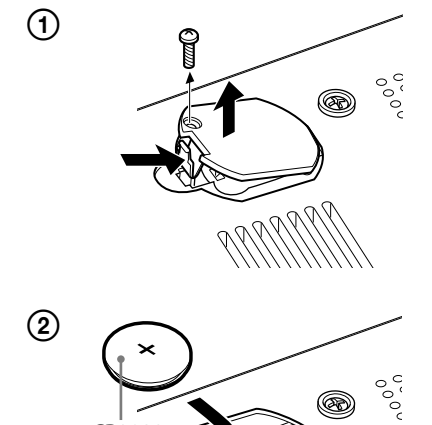

### When to replace the battery

With normal use, the battery (CR2025) should last for about 6 months. When the remote can no longer operate the unit, replace the battery with a new one.

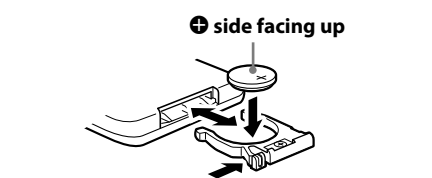

### Note

- If you are not going to use the remote for a long time, remove the battery to avoid any damage that may be caused by leakage or corrosion.

## Operations

## Setting the clock

### To set the clock for the first time

When you first purchase the unit, do the following.

- Remove the insulation film of the backup battery on the bottom of the unit.

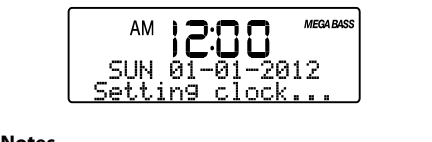
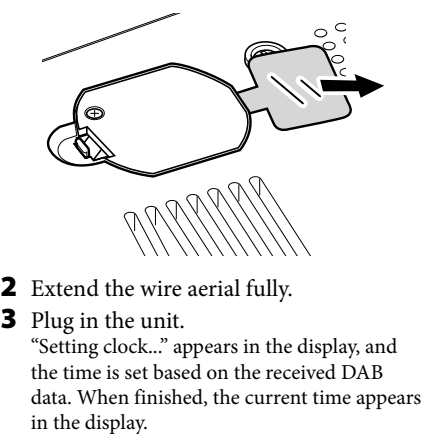

**Notes**

- Do not operate the unit before “Setting clock..” disappears from the display.
- If the clock cannot be set as a result of no DAB signal being received, “AM 12:00,” year and date flash in the display. The clock cannot be set. In this case, set Time synchronization to “iPod” or “None” (for details, see “Time synchronization”).

### Time synchronization

You can synchronize time from DAB broadcasts and iPod in clock mode.

- Press **MENU** and **SELECT ◀** or **▶** to select “Synced Time By,” then press **DSPL/ENT** (**ENTER** on the remote).
- Press **SELECT ◀** or **▶** to select “DAB,” “iPod” or “None,” then press **DSPL/ENT** (**ENTER** on the remote). Select “DAB” to synchronize time by DAB (default). Select “iPod” to synchronize time by iPod. Select “None” if time synchronization is not needed.
- Perform one of the following operations according to your selection above:
  - If “DAB” is selected, set the radio band to DAB.
  - If “iPod” is selected, connect an iPod to the unit.
  - If “None” is selected, perform steps 2 to 4 in “To set the clock manually.”

### To set the clock manually

Do the following if you wish to set the clock manually, instead of synchronizing time by DAB or iPod.

- Plug in the unit.
- Press **MENU** and **SELECT ◀** or **▶** to select “Date & Time,” then press **DSPL/ENT** (**ENTER** on the remote). The year flashes in the display.
- Press **SELECT ◀** or **▶** to set the year, then press **DSPL/ENT** (**ENTER** on the remote).
- Repeat step 3 to set the month, day, hour and minute. The seconds start incrementing from zero.

### Notes

- The clock setting is available in clock state only. (When using radio, iPod or Audio-in, press **OFF** before setting the clock.)
- When “iPod” or “DAB” is selected in Time synchronization, the clock will be overwritten via iPod or DAB time automatically. Select “None” in step 2 to deactivate time synchronization via iPod or DAB.
- When the clock is set via DAB, daylight saving time (summer time) will be adjusted automatically. Otherwise, set daylight saving time manually or via iPod.
- When the clock is set via DAB, the clock will be reset via DAB after a power interruption. The clock will not be reset if it has been set manually or via iPod.
- If you do not press any button for about 1 minute while setting the clock, the clock setting will be cancelled.
- An 88-year calendar (2012-2099) is installed in the unit. When the date is set, the day of the week is automatically displayed. MON = Monday, TUE = Tuesday, WED = Wednesday, THU = Thursday, FRI = Friday, SAT = Saturday, SUN = Sunday

### To change the time format

You can choose a time format between 12-hour system (default) and 24-hour system.

- Press **MENU** and **SELECT ◀** or **▶** to select “Time Format,” then press **DSPL/ENT** (**ENTER** on the remote).
- Press **SELECT ◀** or **▶** to select the desired time format, then press **DSPL/ENT** (**ENTER** on the remote). The time format toggles between 12-hour system (“AM 12:00” = midnight) and 24-hour system (“0:00” = midnight).
- To change the date format**
  - Press **MENU** and **SELECT ◀** or **▶** to select “Date Format,” then press **DSPL/ENT** (**ENTER** on the remote).
  - Press **SELECT ◀** or **▶** to select the desired date format, then press **DSPL/ENT** (**ENTER** on the remote).

**To display the year and date when using the radio**  
Press **DATE**.

After a few seconds, the display will change back to the current service or station automatically.

## Improving the reception

### DAB Band-III/FM

Extend the wire aerial fully to increase reception sensitivity.

Keep the wire aerial away from the power cord. Do not bundle the wire aerial and power cord together.

For DAB reception, press **DSPL/ENT** to show the signal strength in order to adjust the aerial for optimal reception.

### Notes on radio reception

- Keep digital music players or mobile phones away from the aerial, as this may lead to reception interference.
- When you are listening to the radio with an iPhone connected to the unit, interference with radio reception may occur.
- When you are listening to the radio while charging an iPod, interference with radio reception may occur.

### Tip

- If an FM broadcast is noisy, press **MENU** and **SELECT ◀** or **▶** to select “Mode,” then press **DSPL/ENT** (**ENTER** on the remote). Press **SELECT ◀** or **▶** to select “MONO” instead of “AUTO STEREO,” then press **DSPL/ENT** (**ENTER** on the remote) again. To resume stereo reception, perform the above steps again.

## Operating the radio

The unit can receive DAB service and FM stations.

- Press **DAB/FM** repeatedly to select the desired band.

Each press changes the band as follows:



If a list of receivable DAB broadcasts has not been created when you select DAB, “Scanning...” will appear in the display, and the unit starts scanning automatically.

- Press **TUNE +** or – to tune to the desired service or station. If a selected DAB service has finished broadcasting, sound stops and “NO SERVICE” appears. In this case, press **TUNE +** or – to select another service.
- Adjust the volume using **VOLUME +** or – (**VOL +** or – on the remote). To turn off the radio, press **OFF**.

### Note on FM usage

The frequency step is set to 0.05 MHz on FM.

### Notes on DAB usage

- “NO SERVICE” appears when the selected service cannot be received.
- DAB broadcasts with poor quality reception may not be selected when Auto scan is performed. In this case, perform Manual tune, which may improve reception.

### About the SC (Secondary Component)

If the selected primary component has a secondary component, “>>” lights up in the display.

Press **TUNE +** to receive the desired secondary component. “<<” lights up while the secondary component is being received.

### Note

- When the selected secondary component ends, the unit returns automatically to the primary component.

### Preset tuning

You can preset up to 20 services in DAB and 20 stations in FM.

#### To preset a service or station

- Follow steps 1 to 2 in “Operating the radio” and manually tune in to the station you want to preset.
- Press **MENU** and **SELECT ◀** or **▶** to select “Manual Preset,” then press **DSPL/ENT** (**ENTER** on the remote).
- Press **PRESET +** or – to select the desired preset number, and press **DSPL/ENT** (**ENTER** on the remote). The service or station is stored.

### Notes

- To preset another service or station, repeat these steps.
- To go back to the previous status, press **MENU** instead of **DSPL/ENT** (**ENTER** on the remote) in step 2.
- To change a preset service or station, tune in to the desired service or station, then repeat steps 1 to 3. The new service or station will replace the previous service or station.

### To tune in to a preset service or station

- Press **DAB/FM** repeatedly to select the desired band.
- Press **PRESET +** or – to select the desired preset number. When the service or station is not registered, “PRESET BLANK” appears in the display. The preset service or station can also be selected by **PRESET +**



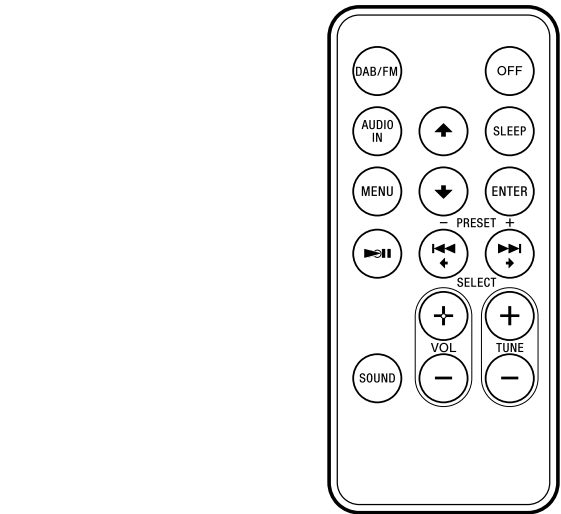
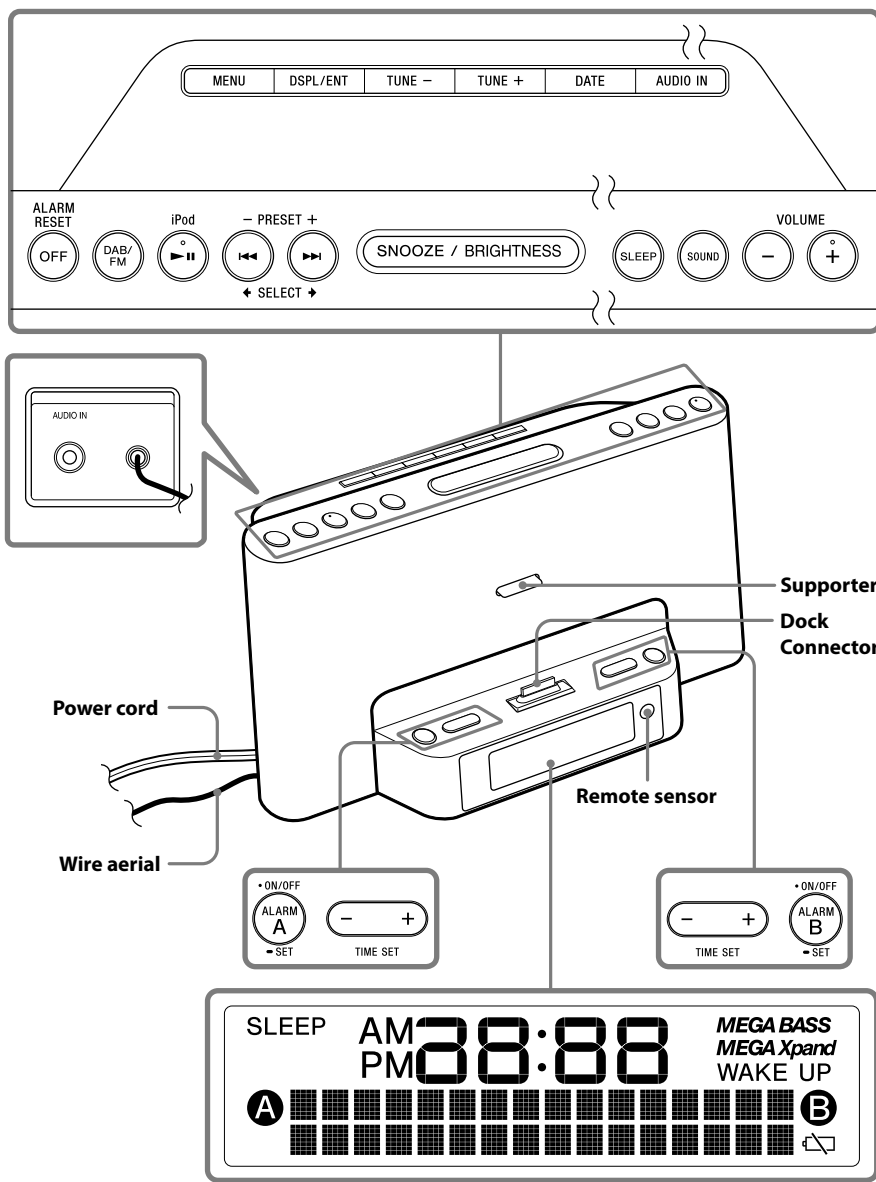

VOLUME + (VOL + on the remote control) and ►|II buttons have a tactile dot.

## How to handle an iPod

### To set an iPod

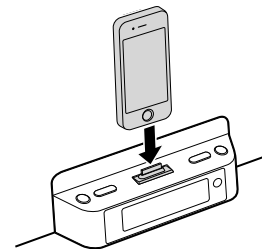

### To remove an iPod

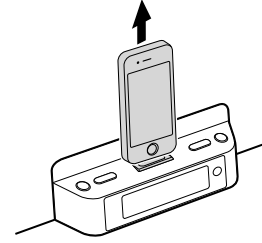

#### Notes

- An iPod in a case or cover can be set on this unit. However, if the case or cover interferes with the connection, remove the case or cover before setting the iPod on the Dock Connector.
- Set the iPod onto the Dock Connector firmly.
- When placing or removing the iPod, hold it at the same angle as the Dock Connector on the unit. Do not pull the iPod forward too far.
- When placing or removing the iPod, hold the unit securely.
- Do not twist or bend the iPod, as this may result in connector damage.
- Remove the iPod when transporting it; otherwise, a malfunction may result.
- If the iPod does not reach the supporter on the front of the unit, attach the supplied cushion below the supporter.

## Operating an iPod

### 1 Set the iPod on the Dock Connector.

The Dock Connector can be tilted slightly. For details, see “How to handle an iPod.”

### 2 Press ►|II.

The iPod begins to play back.

If the iPod does not start playing back, operate directly on the iPod.

You can operate the connected iPod via this unit or the iPod itself.

### 3 Adjust the volume using VOLUME + or – (VOL + or – on the remote).

To	Press
Turn off the iPod	OFF, or press and hold ► II
Pause playback	► II
Go to the next track	► II (forward)
Go back to the previous track	◄ II (backward)*
Locate a point while listening to the sound	► II (forward) or ◄ II (backward) while playing and hold it until you find the point.
Go back to the previous menu	MENU
Select a menu item or a track for playback	▲ (up)/▼ (down) on the remote
Execute the selected menu or begin playback	DSPL/ENT (ENTER on the remote)

\* During playback, this operation returns you to the beginning of the current track. To go back to the previous track, press twice.

#### Notes

- If a pop-up message appears in the display of the iPod touch or iPhone, see “About App.”
- Some operations may differ or may not be available on some models of iPod.
- If the iPod is already playing when set onto the unit, the sound from the iPod will be output from the unit speakers, even if the unit was playing sound from another function.
- If the battery of the iPod is extremely low, charge it for a while before operation.
- Sony cannot accept responsibility in the event that data recorded to an iPod is lost or damaged when using the iPod connected to this unit.
- For details of environmental conditions for operating an iPod, check the website of Apple Inc.

### To remove the iPod

For details, see “How to handle an iPod.”

### To charge an iPod

You can use the unit as a battery charger for an iPod.

Charging begins when the iPod is connected to the unit. The charging status appears in the display of the iPod. For details, refer to the user’s guide of the iPod.

### 7 Press ► ALARM SET A or B.

The alarm mode setting is entered.

### 8 Press TIME SET + or – repeatedly until the desired alarm mode flashes.

You can choose one of 4 settings: “iPod,” “DAB,” “FM” or “BUZZER.”

Set the alarm mode as follows:

– iPod: see “A” To set the alarm as iPod.”

– DAB or FM: see “B” To set the radio alarm.”

– BUZZER: see “C” To set the buzzer alarm.”

### A To set the alarm as iPod

#### 1 Perform steps 1 to 8 in “To set the alarm.”

2 Press ► ALARM SET A or B to select alarm mode for “iPod.” “ALARM VOLUME:” and the volume level indication flash in the display.

3 Press TIME SET + or – to adjust the volume.

4 Press ► ALARM SET A or B. The setting is entered.

5 If “A” or “B” does not appear in the display, press ► ALARM SET A or B again. The iPod will sound at the set time.

#### When using an iPod touch/iPhone

- To wake up to music stored in an iPod touch/iPhone, connect the iPod touch/iPhone to the unit first, follow the steps above to set alarm time, then select the music function.

- Even if the alarm setting for iPod is complete, if you turn the iPod touch/iPhone power off after inserting the iPod touch/iPhone into the unit, the alarm will be the buzzer.

### B To set the radio alarm

#### 1 Perform steps 1 to 8 in “To set the alarm.”

2 Press ► ALARM SET A or B to select the radio band (“DAB” or “FM”).



Preset number

The preset number or “--” flashes in the display.

3 Press TIME SET + or – to set a preset number or “--” as the station to be used as the alarm sound. “DAB --” or “FM --” indicates the last station received.

#### Tips

- If the selected preset number is not set, “PRESET BLANK” flashes twice, then “ALARM VOLUME:” and the volume level indication flash in the display. Then jump to the step 5.
- If there is no last station, “NO LAST STATION” flashes twice, then “ALARM VOLUME:” and the volume level indication flash in the display. Then jump to the step 5.

4 Press ► ALARM SET A or B. “ALARM VOLUME:” and the volume level indication flash in the display.

5 Press TIME SET + or – to adjust the volume.

6 Press ► ALARM SET A or B. The setting is entered.

7 If “A” or “B” does not appear in the display, press ► ALARM SET A or B again. The radio will turn on at the set time.

### To set the alarm

#### C To set the buzzer alarm

#### 1 Perform steps 1 to 8 in “To set the alarm.”

2 Press ► ALARM SET A or B to select “BUZZER” alarm mode. The setting is entered.

3 If “A” or “B” does not appear in the display, press ► ALARM SET A or B again. The buzzer will sound at the set time.

#### Note

- The volume of the buzzer is not adjustable.

### To confirm an alarm time setting

Press TIME SET + or –. The setting will be displayed for about 4 seconds.

### To change an alarm setting

Press and hold TIME SET + for at least 2 seconds to move the alarm time forwards. Press and hold TIME SET – for at least 2 seconds to move the alarm time back.

When you release the button, the changed time will flash for about 2 seconds. To change the alarm time again, press TIME SET + or – within these 2 seconds, otherwise the setting change will be fixed as displayed.

### To doze for a few more minutes

#### Press SNOOZE/BRIGHTNESS.

The sound turns off but will automatically come on again after about 10 minutes.

You can change the snooze time by pressing SNOOZE/BRIGHTNESS repeatedly within 4 seconds.

The maximum length of the snooze time is 60 minutes.

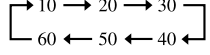

To stop the snooze timer, press OFF.

### To stop the alarm

Press OFF to stop the alarm.

The alarm will sound again at the same time the next day.

### To deactivate the alarm

Press ► ALARM ON/OFF A or B to turn off the alarm A or B indicator in the display.

### To activate the alarm

Press ► ALARM ON/OFF A or B to turn on the alarm A or B indicator in the display.

#### Notes

- When the alarm is set as iPod, only the buzzer alarm will sound if there is no iPod on the Dock Connector, music is not stored in the iPod, or the iPod touch/iPhone is turned off.
- If the selected preset number is not set, or there is no last station, the buzzer will sound when alarm time is met. If you want to change the buzzer alarm, set a preset station or tune to a radio station (see “Operating the radio”).
- If the same alarm time is set for both alarm A and B, alarm A takes priority.
- If no operation is performed while the alarm is occurring, the alarm will stop after about 60 minutes.

### Note on the alarm in the event of a power interruption

In the event of a power interruption, the buzzer alarm will last about 5 minutes if the battery is not weak.

However, certain functions will be affected as follows:

- The backlight will not light up.
- If the alarm mode is set to iPod or radio, it will change to buzzer automatically.
- If OFF/ALARM RESET is not pressed, the alarm will sound for about 5 minutes.
- If “☐” appears in the display, the alarm will not sound in the event of a power interruption. Replace the battery if “☐” appears.
- The snooze function cannot be set during a power interruption.
- During a power interruption, each alarm will sound at the set time only once.

## Setting the sleep timer

You can fall asleep to music, etc., using the sleep timer. The unit stops playback or the radio automatically after a preset duration.

### 1 Press SLEEP while the unit is turned on. “SLEEP:” and the sleep time flash in the display.

2 Press SLEEP to set the sleep timer duration.

Each time you press SLEEP, the duration (in minutes) changes as follows:

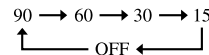

The display returns to clock mode for about 4 seconds after you have finished the duration setting and released SLEEP, then the sleep timer starts.

The unit plays for the duration you set, then stops.

### To turn off the unit before the preset time

Press OFF.

To change the sleep timer setting

You can press SLEEP repeatedly to select the desired sleep timer setting, even after the sleep timer has been activated.

To deactivate the sleep timer

Press SLEEP repeatedly to set the sleep timer to “OFF” in step 2.

## Connecting optional component

### To listen to sound

You can enjoy the sound from an optional component, such as a portable digital music player, through the speakers of this unit. Be sure to turn off the power of each component before making any connections.

1 Firmly connect the line output jack of the portable digital music player (or other component) to the AUDIO IN jack on the back of the unit, using a suitable audio connecting cable (not supplied).

2 Press AUDIO IN to activate the Audio-in function.

3 Turn the connected component on.

4 Play the connected component. The sound from the connected component is output from the speakers of this unit.

5 Adjust the volume using VOLUME + or – (VOL + or – on the remote).

To return to the radio

Press DAB/FM.

To return to the iPod

Press ►|II.

To stop listening

Press OFF and stop playback on the connected unit.

#### Notes

- The MENU cannot be operated while Audio-in is used.
- The necessary type of audio connecting cable depends on the optional component. Be sure to use the correct type of cable.
- If the volume level is low, adjust the volume of the unit first. If the volume is still too low, adjust the volume of the connected component.
- Disconnect the audio connecting cable from the unit when it is not in use.
- When you listen to the radio with an optional component connected, turn off the connected component to prevent noise. If noise occurs, even when the component is turned off, disconnect and place the optional component away from the unit.

## Other useful functions

### Other useful functions for DAB

To change the display

To change the display mode, press DSPL/ENT during DAB reception. The selected display mode remains even if you turn the unit off and on again, or change the band.

The display can be up to 16 characters. A dynamic label can be up to 128 characters. Each time you press DSPL/ENT, the display changes as follows:

#### Function and Preset number



Component Label

#### Dynamic

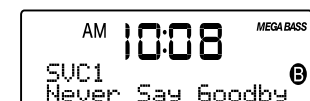

#### PTY (Programme Type)



#### Ensemble



#### Channel/Frequency/Signal Strength

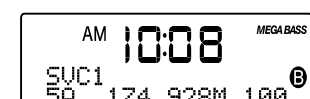

#### Broadcasting type/Bit/Mode

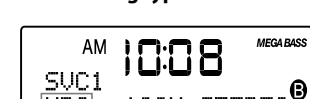

DAB broadcasting: MP2

DAB\* broadcasting: AAC

#### Notes

- If there is no dynamic label, the lower line of the display is blank.
- Depending on the broadcasting station, the characters in the dynamic label may not be displayed properly.

#### Manual tune

This function allows you to tune and add various DAB Band-III channels to your station list. This function can be used to assist the positioning of the aerial or the unit to obtain the optimum reception for a specific channel/frequency.

1 Press DAB/FM repeatedly to select the DAB band.

2 Press MENU and SELECT ◄ or ► to select “Manual Tune,” then press DSPL/ENT (ENTER on the remote).

3 Press SELECT ◄ or ► to select the desired DAB channel, then press DSPL/ENT (ENTER on the remote). The signal strength bars move left and right as you adjust reception.

4 Press DSPL/ENT (ENTER on the remote).

#### Notes

- If the signal of the selected DAB service cannot be received, no signal strength bars will be displayed. In this case, press MENU to select another channel.
- The larger signal strength bar indicates the audio quality threshold. If the signal strength drops below this threshold, the audio quality will deteriorate.
- A station name is saved to the station list when the station name starts scrolling in step 3.

### DRC value (DYNAMIC RANGE CONTROL)

DRC can make quieter sounds easier to hear when the unit is used in a noisy environment.

For DAB broadcasts with dynamic range compression, you can adjust the dynamic range.

1 Press DAB/FM repeatedly to select the DAB band.

2 Press MENU and SELECT ◄ or ► to select “DRC Value,” then press DSPL/ENT (ENTER on the remote).

3 Press SELECT ◄ or ► to select the DRC level.

The DRC level changes as follows:

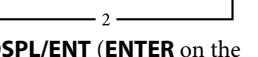

4 Press DSPL/ENT (ENTER on the remote).

#### Notes

- DRC is effective only for broadcasts with dynamic range compression.
- When you adjust the DRC level, sounds can be heard more clearly.

#### Auto scan

This function allows you to automatically scan and create a list of receivable DAB broadcasts.

1 Press DAB/FM repeatedly to select the DAB band.

2 Press MENU and SELECT ◄ or ► to select “Auto Scan,” then press DSPL/ENT (ENTER on the remote).

3 Press SELECT ◄ or ► to select “Yes,” then press DSPL/ENT (ENTER on the remote). “Scanning...” appears in the display.

Auto scan takes about 30 - 90 seconds, depending on the signal strength and station number. When finished, the unit creates a list in alphabetical order.

#### Tip

- To cancel Auto scan, press MENU while processing.

#### Note

- When Auto scan is performed, the existing list will be updated and the preset services will be cleared. In this case, preset your favourite services again.

#### Trim stations

You can delete the stations that are not currently being received.

1 Press DAB/FM repeatedly to select the DAB band.

2 Press MENU and SELECT ◄ or ► to select “Prune,” then press DSPL/ENT (ENTER on the remote).

When finished, “FINISH” appears for about 1 second, then changes to the current station automatically.

#### Select station

Another service can be selected while listening to a broadcast.

1 Press MENU and SELECT ◄ or ► to select “Select Station,” then press DSPL/ENT (ENTER on the remote).

2 Press SELECT ◄ or ► to select a desired service, then press DSPL/ENT (ENTER on the remote).

## PTY (Programme Type)

This function indicates services in programme type, such as NEWS, SPORTS of the PTY list, transmitted in a DAB broadcast.

Programme type	Display
No programme type	None
News	News
Current Affairs	Current Affairs
Information	Information
Sport	Sport
Education	Education
Drama	Drama
Culture	Arts
Science	Science
Varied	Talk
Pop Music	Pop Music
Rock Music	Rock Music
Easy Listening Music	Easy Listening
Light Classical	Light Classical
Serious Classical	Classical Music
Other Music	Other Music
Weather/meteorology	Weather
Finance/Business	Finance
Children’s programmes	Children’s
Social Affairs	Factual
Religion	Religion
Phone In	Phone In
Travel	Travel
Leisure	Leisure
Jazz Music	Jazz and Blues
Country Music	Country Music
National Music	National Music
Oldies Music	Oldies Music
Folk Music	Folk Music
Documentary	Documentary

## About App

A dedicated Dock App for iPod touch/iPhone available at Apple App Store.

Search for “D-Sappli” and download the free App to find out more about the functions.

#### Features

- D-Sappli includes various timer functions: Music Play Timer and Sleep Timer.
- Music Play Timer allows you to play/pause desired music at a desired time. Sleep Timer allows you to specify a time at which to stop music playback.
- Music Play Timer and Sleep Timer are available only when D-Sappli is activated.
- D-Sappli can display a list of Radio Preset Stations programmed in this unit. You can rename the FM Radio Preset Stations, and change their preset numbers on the D-Sappli. Preset numbers and order will also be changed accordingly in the unit.
- D-Sappli also includes a clock display enlarge feature.

#### Notes

- If the App to link with this unit is not downloaded to the iPod touch/iPhone, a pop-up message prompting you to download D-Sappli may appear repeatedly. Deactivate the App’s link function to stop the pop-up message.
- To deactivate the App’s link function: Remove the iPod touch/iPhone from the Dock Connector. Press ►|II (to enter the function for iPod). Press MENU, then press DSPL/ENT (ENTER on the remote). Press ◄ or ► to select “OFF,” then press DSPL/ENT (ENTER on the remote).
- To re-activate the App’s link function, repeat the above steps and select “ON” instead of “OFF” in the last step.

## Enjoying the bass or expansion sound effect

Bass and expansion sound effects can be selected as desired by pressing SNOOZE.

Each time you press the button, the sound effect changes as follows:

“MEGA BASS”: Provides high quality bass sound. “MEGA BASS” and “MEGA Xpand”: Enables both effects.

“MEGA Xpand”: Expands the sound field width. To return to standard sound, press the button until the display of the sound effect disappears.

## Setting the brightness of the display