

# Personal Audio Docking System

## Operating Instructions

RDP-X60iP



©2011 Sony Corporation

Printed in China

<http://www.sony.net/>



## WARNING

**To reduce the risk of fire or electric shock, do not expose this apparatus to rain or moisture.**

To reduce the risk of fire, do not cover the ventilation of the apparatus with newspapers, tablecloths, curtains, etc. And do not place lighted candles on the apparatus.

To reduce the risk of fire or electric shock, do not expose this apparatus to dripping or splashing, and do not place objects filled with liquids, such as vases, on the apparatus.

Do not install the appliance in a confined space, such as a bookcase or built-in cabinet.

Do not expose the batteries (battery pack or batteries installed) to excessive heat such as sunshine, fire or the like for a long time.

As the main plug is used to disconnect the unit from the mains, connect the unit to an easily accessible AC outlet. Should you notice an abnormality in the unit, disconnect the main plug from the AC outlet immediately.

The unit is not disconnected from the AC power source (mains) as long as it is connected to the wall outlet, even if the unit itself has been turned off.

The nameplate and important information concerning safety are located on the bottom exterior of the main unit and on the surface of the AC power adaptor.

### CAUTION

Danger of explosion if battery is incorrectly replaced. Replace only with the same type.

**Notice for customers: the following information is only applicable to equipment sold in countries applying EU directives**

The manufacturer of this product is Sony Corporation, 1-7-1 Konan, Minato-ku, Tokyo, 108-0075 Japan. The Authorized Representative for EMC and product safety is Sony Deutschland GmbH, Hedelfinger Strasse 61, 70327 Stuttgart, Germany. For any service or guarantee matters, please refer to the addresses given in separate service or guarantee documents.



Hereby, Sony Corp., declares that this equipment is in compliance with the essential requirements and other relevant provisions of Directive 1999/5/EC. For details, please access the following URL: <http://www.compliance.sony.de/>

### On Copyrights and Licenses

The Bluetooth word mark and logos are owned by the Bluetooth SIG, Inc. and any use of such marks by Sony Corporation is under license. Other trademarks and trade names are those of their respective owners. iPhone, iPod, iPod classic, iPod nano, and iPod touch are trademarks of Apple Inc., registered in the U.S. and other countries. "Made for iPod" and "Made for iPhone" mean that an electronic accessory has been designed to connect specifically to iPod or iPhone, respectively, and has been certified by the developer to meet Apple performance standards. Apple is not responsible for the operation of this device or its compliance with safety and regulatory standards. Please note that the use of this accessory with iPod or iPhone may affect wireless performance.

Use of this radio equipment is not allowed in the geographical area within a radius 20km from the centre of Ny-Alesund, Svalbard in Norway.

## Features

- Wireless Music Streaming
- Compatible with iPod and iPhone
- MEGA BASS
- Wireless remote commander supplied

## Precautions

- To disconnect the AC power cord (mains lead), pull it out by the plug, not the cord.
- Since a strong magnet is used for the speaker, keep credit cards using magnetic coding or spring-wound watches, CRT-based TVs, or projectors, etc., away from the unit to prevent possible damage from the magnet.
- Do not leave the unit in a location near a heat source such as a radiator or airt duct, or in a place subject to direct sunlight, excessive dust, mechanical vibration, or shock.
- Allow adequate air circulation to prevent internal heat build-up. Do not place the unit on a surface (a rug, a blanket, etc.) or near materials (a curtain) which might block the ventilation holes.
- Should any solid object or liquid fall into the unit, unplug the unit and have it checked by qualified personnel before operating it any further.
- Do not handle the unit with wet hands.
- Do not place the unit anywhere near water.

### NOTES ON LITHIUM BATTERY

- Wipe the battery with a dry cloth to assure a good contact.
- Be sure to observe the correct polarity when installing the battery.
- Do not hold the battery with metallic tweezers, otherwise a short-circuit may occur.



**Disposal of Old Electrical & Electronic Equipment (Applicable in the European Union and other European countries with separate collection systems)**

This symbol on the product or on its packaging indicates that this product shall not be treated as household waste. Instead it shall be handed over to the applicable collection point for the recycling of electrical and electronic equipment. By ensuring this product is disposed of correctly, you will help prevent potential negative consequences for the environment and human health, which could otherwise be caused by inappropriate waste handling of this product. The recycling of materials will help to conserve natural resources. For more detailed information about recycling of this product, please contact your local Civic Office, your household waste disposal service or the shop where you purchased the product. Applicable accessory: Remote Commander.



**Disposal of waste batteries (applicable in the European Union and other European countries with separate collection systems)**

This symbol on the battery or on the packaging indicates that the battery provided with this product shall not be treated as household waste. On certain batteries this symbol might be used in combination with a chemical symbol. The chemical symbols for mercury (Hg) or lead (Pb) are added if the battery contains more than 0.0005% mercury or 0.004% lead. By ensuring these batteries are disposed of correctly, you will help prevent potentially negative consequences for the environment and human health which could otherwise be caused by inappropriate waste handling of the battery. The recycling of the materials will help to conserve natural resources.

In case of products that for safety, performance or data integrity reasons require a permanent connection with an incorporated battery, this battery should be replaced by qualified service staff only. To ensure that the battery will be treated properly, hand over the product at end-of-life to the applicable collection point for the recycling of electrical and electronic equipment.

For all other batteries, please view the section on how to remove the battery from the product safely. Hand the battery over to the applicable collection point for the recycling of waste batteries.

For more detailed information about recycling of this product or battery, please contact your local Civic Office, your household waste disposal service or the shop where you purchased the product.

### On Bluetooth communication

- Bluetooth wireless technology operates within a range of about 10 meters. Maximum communication range may vary depending on obstacles (human body, metal, wall, etc.) or electromagnetic environment.

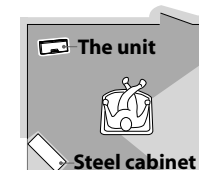

- The following conditions may affect the sensitivity of Bluetooth communication.
  - There is an obstacle such as a person, metal, or wall between this unit and iPod.
  - A device using 2.4 GHz frequency, such as a wireless LAN device, cordless telephone, or microwave oven, is in use near the unit.
  - The unit is installed on a shelf made of steel.
- Because Bluetooth devices and wireless LAN (IEEE802.11b/g/n) use the same frequency, microwave interference may occur and resulting in communication speed deterioration, noise, or invalid connection if this unit is used near a wireless LAN device. In such as case, perform the following.
  - Use this unit at least 10 m away from any wireless LAN device.
  - If this unit is used within 10 m of a wireless LAN device, turn off the wireless LAN device.
  - Install this unit and iPod as near to each other as possible.
- Microwaves emitting from a Bluetooth device may affect the operation of electronic medical devices. Turn off this unit and iPod in the following locations, as it may cause an accident.
  - where inflammable gas is present, in a hospital, train, airplane, or a petrol station
  - near automatic doors or a fire alarm
- This unit supports security capabilities that comply with the Bluetooth standard to provide a secure connection when the Bluetooth wireless technology is used, but security may be insufficient, depending on the setting. Be careful when communicating using Bluetooth wireless technology.
- We do not take any responsibility for leakage of information during Bluetooth communication.
- Connection with all Bluetooth devices cannot be guaranteed.
  - A device featuring Bluetooth function is required to conform to the Bluetooth standard specified by Bluetooth SIG, Inc. and be authenticated.
  - Even if the connected device conforms to the above mentioned Bluetooth standard, some devices may not be connected or work correctly, depending on the features or specifications of the device.
- Depending on the device to be connected, it may require some time to start communication.

### Note

- In the Operating Instructions, "iPod" is used as a general reference to functions on an iPod, iPhone or iPad, unless otherwise specified by the text or illustrations.

If you have any questions or problems concerning your unit, please consult your nearest Sony dealer.

## Power sources

### Preparing a power source

- 1 Connect the AC power cord (supplied) to the AC power adaptor (supplied).
- 2 Connect the AC power adaptor to the **DC IN 20V** jack on the back of this unit firmly and plug it into a wall outlet.

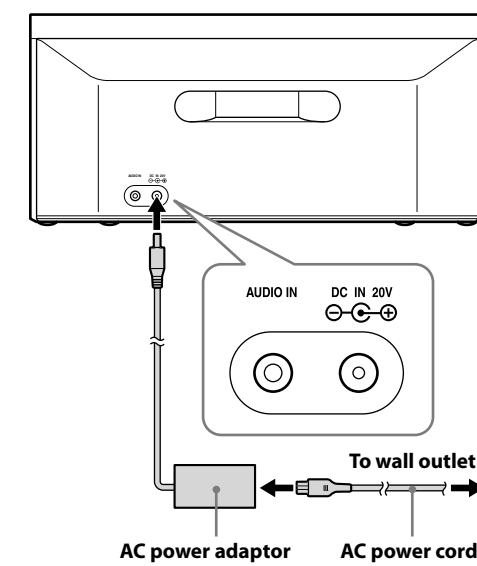

#### Note on the AC power adaptor

- Use the supplied Sony AC power adaptor only. The polarity of the plugs of other manufactures may be different. Failure to use the supplied AC power adaptor may cause the unit to malfunction.

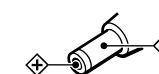

### Preparing the remote commander

Before using the remote commander for the first time, remove the insulation film.

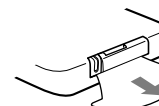

### When to replace the battery

With normal use, the battery (CR2025) should last for about 6 months. When the remote commander no longer operates the unit, replace the battery with a new one.



the **+** side facing up

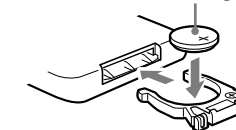

### Notes

- Do not attempt to charge the battery.
- If you are not going to use the remote commander for a long time, remove the battery to avoid any damage that may be caused by leakage and corrosion.

# Operations

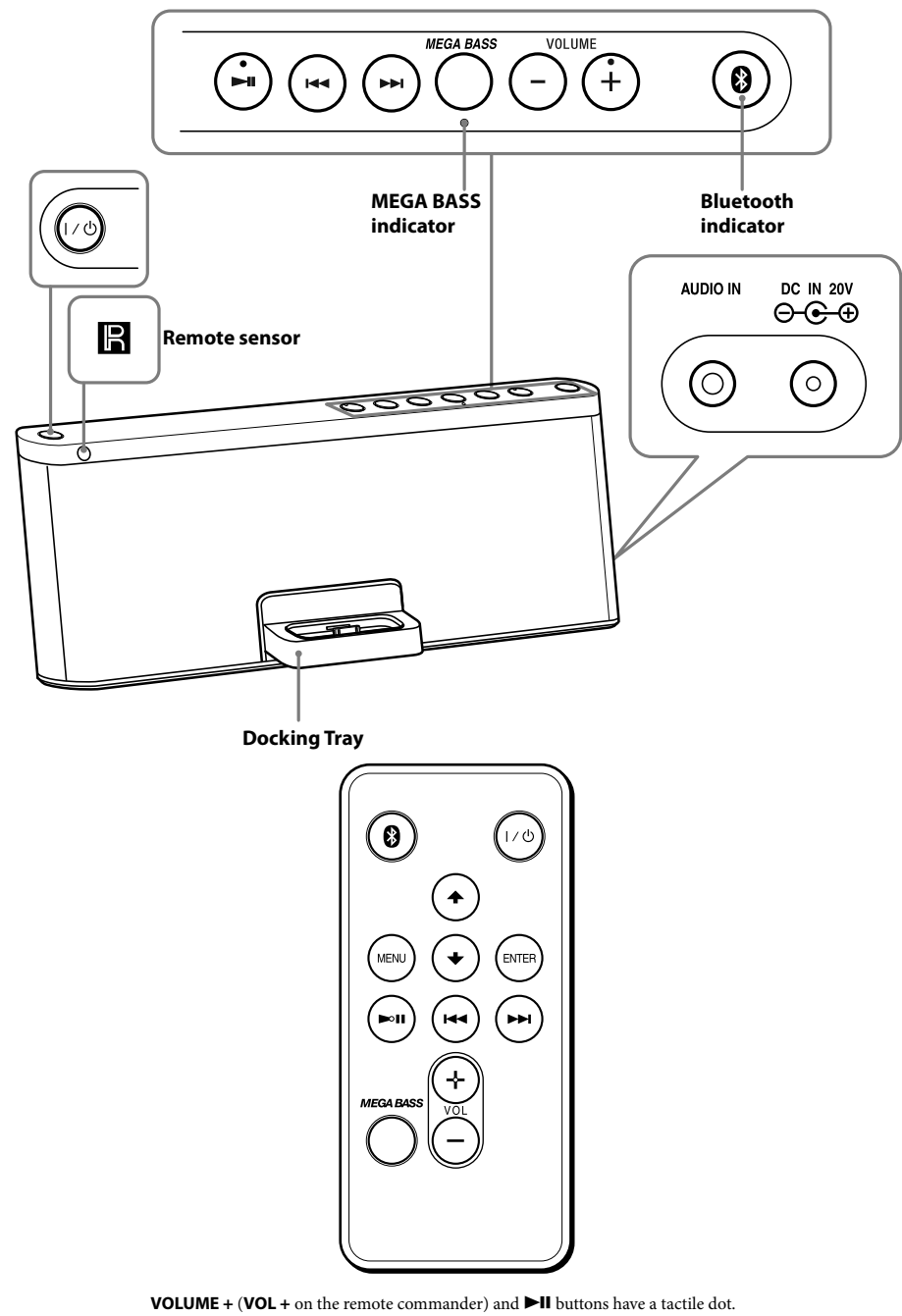

VOLUME + (VOL + on the remote commander) and ►► buttons have a tactile dot.

## Before using the unit

### To turn on/off the unit

Press I/⏻ (power). The I/⏻ button indicator will light up in green when the unit is turned on.

### To adjust the volume

Press **VOLUME +/-** (**VOL +/-** on the remote commander).

**Tip**

- The I/⏻ button indicator flashes three times when the sound is set to either maximum or minimum volume.

### To reinforce the bass sound

Press **MEGA BASS**. The MEGA BASS indicator lights up. You can achieve high quality bass sound. To return to normal sound, press the button again.

### Auto power off

After playback of the iPod (or component connected to **AUDIO IN** jack) has finished, if no operation is performed for about 30 minutes, the unit will automatically turn off.

## Operating an iPod on the Dock

You can enjoy audio from iPod by setting it in the Docking Tray of this unit. When setting an iPod in the unit, use the supplied universal dock adapter with your iPod or commercially available products from Apple Inc. If you are using an iPhone, iPhone 3G, iPhone 3GS or iPhone 4, attach the supplied universal dock adapter ⑫, ⑮, or ⑲. The respective adapter number is located on the underside of each adapter.

### Supplied Universal Dock Adapter

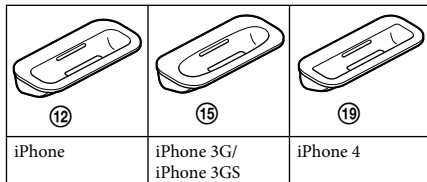

**Notes**

- To use an iPod, refer to the user's guide of your iPod.
- Sony cannot accept responsibility in the event that data recorded on an iPod is lost or damaged when using an iPod connected to this unit.
- For details of environmental conditions for operating your iPod, check the website of Apple Inc.

1 Attach the adapter for your iPod.

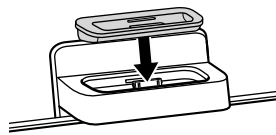

2 Set your iPod in the Docking Tray.

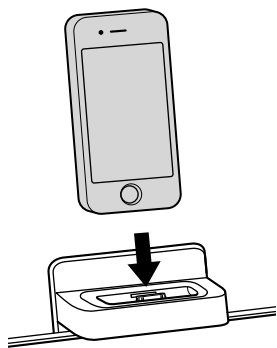

**Tip**

- Remove the case or cover from your iPod before setting it in the tray to ensure a stable connection.

3 Press Ⓜ to turn off the Bluetooth when the Bluetooth indicator is on.

4 Press ►►. The iPod begins to play back. You can operate the connected iPod via this unit or the iPod itself.

To	Press
Turn off the iPod	Press and hold ►►.
Pause playback	►► To resume play, press it again.
Go to the next track	►►► (forward)
Go back to the previous track	◄◄◄ (backward)*1
Locate a point while listening to the sound	►►► (forward) or ◄◄◄ (backward) while playing and hold it until you find the point.
Locate a point while observing the display on iPod	►►►► (forward) or ◄◄◄◄ (backward) in pause and hold it until you find the point then press ►►.
Go back to the previous menu	MENU*2
Go back to the main menu	Press and hold MENU*2
Select a menu item or a track for playback	♦ (up)/♦ (down)*2
Execute the selected menu item or begin playback	ENTER*2

\*1 During playback, this operation returns to the beginning of the current track. To go back to the previous track, press twice.

\*2 These operations are available only when using the supplied remote commander. In addition, for iPod touch and iPhone, operation video or music mode is required for these operations to be available.

**Notes**

- When placing or removing the iPod, hold the iPod at the same angle as that of the connector on this unit, and do not twist or bend the iPod as it may result in connector damage.
- Do not carry the unit with an iPod set on the Docking Tray. Doing so may cause a malfunction.
- When placing or removing the iPod, hold the Docking Tray securely.
- If the battery of your iPod is extremely low, charge it for a while before operation.
- An iPod touch/iPhone will not work unless it is turned on. Be sure to turn on the power of the iPod touch/iPhone before operation.
- Some operations may differ depending on the iPod models and/or software version. For details, refer to the user's guide of your iPod.

## To use this unit as a battery charger for your iPod

You can use the unit as a battery charger for your iPod. Charging begins when the iPod is set on the Dock. The charging status appears in the display on iPod. For details, see the user's guide of your iPod.

## Operating an iPod by wireless music streaming

By using the Bluetooth connection, you can listen to the sound from an iPod with the unit wirelessly.

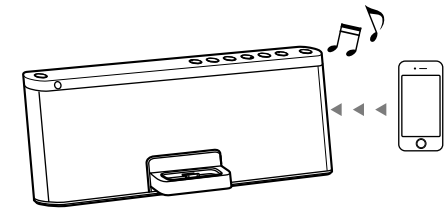

### On pairing

**What is pairing?** Bluetooth devices need to be "paired" with each other beforehand. Once Bluetooth devices are paired, there is no need for pairing again, unless pairing information is deleted.

### On Bluetooth indicator

Status	Bluetooth indicator (blue)
Bluetooth off	Off
Bluetooth on but not connected	Flashes slowly
Pairing mode	Flashes quickly
Connected or communicating	Lights up

### To pair with an iPod

Keep the iPod and the unit within 1 meter of each other for this operation.

1 Press I/⏻ to turn on the unit.

2 Press Ⓜ to turn on the Bluetooth when the Bluetooth indicator is off. The Bluetooth indicator flashes slowly.

3 Press and hold Ⓜ. When pairing starts, a double-beep sound will be heard and the Bluetooth indicator will flash quickly. Pairing mode of the unit is activated.

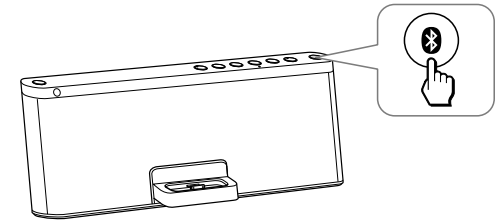

4 Perform the pairing procedure on your iPod to detect the unit. Select "Settings → General → Bluetooth" and turn on Bluetooth.

**Example: iPhone 4**



A list of detected devices appears on the display. The unit is displayed as "RDP-X60iP". If "RDP-X60iP" is not displayed, repeat from step 3.

5 Select "RDP-X60iP" on the display of the iPod while the Bluetooth indicator flashes quickly. When "Connected" appears on the display of the iPod, pairing and connection are complete.

**Example: iPhone 4**

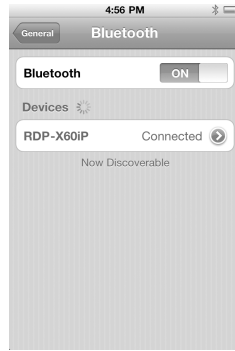

**Notes**

- The operation and display may differ depending on the iPod model and/or software version. For details, refer to the user's guide of your iPod.
- Pairing mode is canceled after about 5 minutes. If pairing mode is canceled halfway, start over from step 3.
- If pairing is not complete, start over from step 3.
- To pair with another iPod, repeat steps 1 to 5.
- In step 3, if a double-beep sound is not heard or the Bluetooth indicator does not flash quickly, press and hold Ⓜ again.
- If you turn off the unit or the iPod before the Bluetooth connection is complete, pairing information will not be memorized, and pairing will not be completed.
- If Passcode input is required in the display, input "0000."
- Operation of Bluetooth devices other than iPod is not guaranteed.

### To listen to the sound

Keep the iPod and the unit within 10 meters of each other for this operation. Check the following before operating the unit.

- The Bluetooth of your iPod is on.
- Pairing of the unit and your iPod is complete, if pairing is not completed, perform pairing again. (Refer to "To pair with an iPod")

1 Press I/⏻ to turn on the unit.

2 Press Ⓜ to turn on the Bluetooth. The last connected iPod will be reconnected automatically. If you connect another already-paired iPod model when Bluetooth is disconnected, select the model name of this unit from your iPod. (Perform steps 4 to 5 under the title "To pair with an iPod.")

3 Select your desired music, video, game, etc., to play on your iPod. For details, refer to the user's guide of your iPod.

### Tips

- When the last connected iPod is not reconnected automatically, press ►►. If it is still not reconnected, perform steps 4 to 5 under the title "To pair with an iPod."
- You can charge your iPod on the dock while listening to music with Bluetooth connection.

### To finish listening

Terminate the Bluetooth connection by any of the operations below.

- Press Ⓜ to turn off the Bluetooth. (Bluetooth indicator turns off.)
- Turn off the unit.
- Turn off the iPod.
- Operate the iPod to terminate the connection. For details, refer to the user's guide of your iPod.

## To clear the list of iPod models already-paired and memorized in the unit

1 Press I/⏻ to turn on the unit.

2 Press Ⓜ to turn on the Bluetooth.

3 Press and hold Ⓜ first, and then press and hold I/⏻ immediately. The MEGA BASS indicator flashes and then the list is cleared.

**Notes**

- You can perform step 3 to clear the list even during Bluetooth connection.
- This operation cannot be performed when the unit is pairing.
- To pair with this unit again, delete the unit from your iPod and perform pairing again. (Refer to "To pair with an iPod")

## Connecting optional components

You can enjoy the sound from an optional component, such as a portable digital music player, through the speakers of this unit. Be sure to turn off the power of each component before making any connections.

1 Firmly connect the line output jack of a portable digital music player (or other component) to the **AUDIO IN** jack on the back of the unit, using a suitable audio connecting cable (not supplied).

2 Press I/⏻ to turn on the unit.

3 Turn the connected component on.

4 Play the connected component. The sound from the connected component is output from the speakers of this unit.

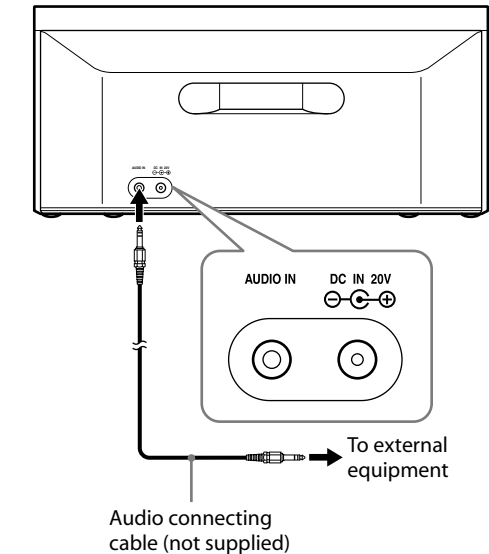

**Notes**

- The audio connecting cable required depends on the external equipment. Make sure the cable is correct for the external equipment to be connected.
- If the volume level is low, adjust the volume of the unit first. If the volume is still too low, adjust the volume of the connected equipment.
- When playing an external component connected to the **AUDIO IN** jack, stop playback of your iPod.
- Disconnect the audio connecting cable when audio-in is not in use.

## Troubleshooting

### General

**The power is not on.**

- Make sure the AC power cord is connected to the wall outlet firmly.

**There is no audio.**

- Adjust **VOLUME +/-** (**VOL +/-** on the remote commander).

**Noise is heard.**

- Ensure that the unit is not in the vicinity of in-use portable phones, etc.
- Disconnect the audio connecting cable.

**The two different music sources will be mixed together during playback.**

- Stop playback of your iPod or external component.

**The I/⏻ button indicator flashes.**

- The I/⏻ button indicator flashes when the remote commander's command is received. In this case, it does not mean any error or fault.
- If the unit often turns off automatically after flashing, even though the AC power cord is reconnected, consult your nearest Sony dealer.

### When using an iPod on the Dock

**There is no audio.**

- Make sure the iPod is connected firmly.
- Make sure Bluetooth is turned off. Otherwise, press Ⓜ to turn off Bluetooth.

**Operation is not performed.**

- Make sure the iPod is connected firmly.

**The iPod does not charge.**

- Make sure the iPod is connected firmly.
- Make sure the AC power adaptor is connected firmly.

### Audio-in

**There is no audio.**

- Make sure the Audio connecting cable is connected firmly.

### Remote commander

**The remote commander does not function.**

- Replace the battery in the remote commander with a new one if it is weak.
- Make sure that you are pointing the remote commander at the remote sensor on the unit.
- Remove any obstacles in the path of the remote commander and the unit.
- Make sure the remote sensor is not exposed to strong light such as direct sunlight or fluorescent lamp light.
- Move closer to the unit when using the remote commander.

### When using the Bluetooth connection

**There is no audio**

- Ensure that this unit is not too far from the iPod, or this unit is not receiving interference from a wireless LAN, other 2.4 GHz wireless device, or microwave oven.
- Check that the Bluetooth connection is made properly between this unit and the iPod.
- Pair this unit and the iPod again.
- Keep away from metal objects or surfaces.
- Make sure Bluetooth is turned on. Otherwise, press Ⓜ to turn on Bluetooth.

### Sound skips or the correspondence distance is short.

- If a device that generates electromagnetic radiation, such as a wireless LAN, other Bluetooth device(s), or a microwave oven is nearby, move away from such sources.
- Remove any obstacle between this unit and iPod or move away from the obstacle.
- Locate this unit and iPod as near as possible.
- Re-position this unit.
- Re-position iPod.

**Connecting cannot be done.**

- Perform pairing again. (Refer to "To pair with an iPod")

**Pairing cannot be done.**

- Bring this unit and the iPod closer together.
- Delete the unit from your iPod and perform pairing again.

If the problem persists, consult your nearest Sony dealer.

# Specifications

### Section for iPod

DC out: 5V  
MAX: 1A

### Section for Bluetooth

**Output**  
Bluetooth Specification Power Class 2  
**Maximum communication range**  
Line of sight approx. 10 m\*1  
**Frequency band**  
2.4 GHz band (2.4000 GHz – 2.4835 GHz)  
**Communication System**  
Bluetooth Specification Version 2.1 + EDR (Enhanced Data Rate)  
**Compatible Bluetooth Profiles**\*2  
A2DP (Advanced Audio Distribution Profile)  
AVRCP\*3 (Audio Video Remote Control Profile)  
**Supported codec**\*4  
SBC\*5

\*1 The actual range will vary depending on factors such as obstacles between devices, magnetic fields around a microwave oven, static electricity, reception sensitivity, aerial's performance, operating system, software application, etc.

\*2 Bluetooth standard profiles indicate the purpose of Bluetooth communication between devices.

\*3 Some operations may not be available due to different iPod models.

\*4 Codec: Audio signal compression and conversion format  
\*5 Subband Coding

### General

**Speaker**  
Approx. 7.6 cm dia. 4 Ω  
**Input**  
AUDIO IN jack (ø 3.5 mm stereo minijack)  
**Power output**  
20 W + 20 W (at 1% harmonic distortion)  
**Power requirements**  
DC IN 20V  
**Dimensions**  
Approx. 356.0 mm × 158.3 mm × 151.9 mm (w/h/d)  
(incl. projecting parts and controls)  
**Mass**  
Approx. 1.8 kg

**Supplied accessories**  
Remote commander (1)  
AC power adaptor (1)  
AC power cord (1)  
Universal Dock Adapter ⑫ for iPhone (1)  
Universal Dock Adapter ⑮ for iPhone 3G/iPhone 3GS (1)  
Universal Dock Adapter ⑲ for iPhone 4 (1)

Design and specifications are subject to change without notice.

## Compatible iPod/iPhone models

The compatible iPod/iPhone models are as follows. Update software of your iPod/iPhone to the latest version before using it with this unit.

iPod touch 4th generation  
iPod touch 3rd generation  
iPod touch 2nd generation  
iPod touch 1st generation  
iPod nano 5th generation (video camera)  
iPod nano 4th generation (video)  
iPod nano 3rd generation (video)  
iPod nano 2nd generation (aluminum)  
iPod 5th generation (video)  
iPod classic  
iPhone 4  
iPhone 3GS  
iPhone 3G  
iPhone

### Wireless music streaming compatible models

iPod touch 4th generation  
iPod touch 3rd generation  
iPhone 4  
iPhone 3GS  
iPhone 3G  
iPad