

Micro HI-FI Component System

Operating Instructions
CMT-BX77DBi



© 2010 Sony Corporation Printed in China

<http://www.sony.net/>

WARNING

To reduce the risk of fire, do not cover the ventilation opening of the apparatus with newspapers, tablecloths, curtains, etc. Do not place the naked flame sources such as lit candles on the apparatus.

To reduce the risk of fire or electric shock, do not expose this apparatus to dripping or splashing, and do not place objects filled with liquids, such as vases, on the apparatus. Do not install the appliance in a confined space, such as a bookcase or built-in cabinet.

As the main plug is used to disconnect the unit from the mains, connect the unit to an easily accessible AC outlet. Should you notice an abnormality in the unit, disconnect the main plug from the AC outlet immediately.

Do not expose batteries or apparatus with battery-installed to excessive heat such as sunshine, fire or the like. Excessive sound pressure from earphones and headphones can cause hearing loss.

CAUTION

The use of optical instruments with this product will increase eye hazard.

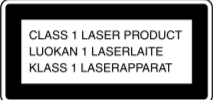

This appliance is classified as a CLASS 1 LASER product. This marking is located on the rear exterior.

Notice for customers: the following information is only applicable to equipment sold in countries applying EU directives.

The manufacturer of this product is Sony Corporation, 1-7-1 Konan Minato-ku, Tokyo, 108-0075 Japan. The Authorized Representative for EMC and product safety is Sony Deutschland GmbH, Hedelfinger Strasse 61, 70327 Stuttgart, Germany. For any service or guarantee matters, please refer to the addresses given in separate service or guarantee documents.



Disposal of Old Electrical & Electronic Equipment (Applicable in the European Union and other European countries with separate collection systems)

This symbol on the product or on its packaging indicates that this product shall not be treated as household waste. Instead it shall be handed over to the applicable collection point for the recycling of electrical and electronic equipment. By ensuring this product is disposed of correctly, you will help prevent potential negative consequences for the environment and human health, which could otherwise be caused by inappropriate waste handling of this product. The recycling of materials will help to conserve natural resources. For more detailed information about recycling of this product, please contact your local Civic Office, your household waste disposal service or the shop where you purchased the product.

Applicable accessories: Remote commander



Disposal of waste batteries (applicable in the European Union and other European countries with separate collection systems)

This symbol on the battery or on the packaging indicates that the battery provided with this product shall not be treated as household waste. On certain batteries this symbol might be used in combination with a chemical symbol. The chemical symbols for mercury (Hg) or lead (Pb) are added if the battery contains more than 0.0005% mercury or 0.004% lead. By ensuring these batteries are disposed of correctly, you will help prevent potentially negative consequences for the environment and human health which could otherwise be caused by inappropriate waste handling of the battery. The recycling of the materials will help to conserve natural resources.

In case of products that for safety, performance or data integrity reasons require a permanent connection with an incorporated battery, this battery should be replaced by qualified service staff only. To ensure that the battery will be treated properly, hand over the product at end-of-life to the applicable collection point for the recycling of electrical and electronic equipment.

For all other batteries, please view the section on how to remove the battery from the product safely. Hand the battery over to the applicable collection point for the recycling of waste batteries.

For more detailed information about recycling of this product or battery, please contact your local Civic Office, your household waste disposal service or the shop where you purchased the product.

Note on DualDiscs

A DualDisc is a two sided disc product which mates DVD recorded material on one side with digital audio material on the other side. However, since the audio material side does not conform to the Compact Disc (CD) standard, playback on this product is not guaranteed.

Music discs encoded with copyright protection technologies

This product is designed to playback discs that conform to the Compact Disc (CD) standard. Recently, various music discs encoded with copyright protection technologies are marketed by some record companies. Please be aware that among those discs, there are some that do not conform to the CD standard and may not be playable by this product.

License and Trademark Notice

- iPod is a trademark of Apple Inc., registered in the U.S. and other countries.
- "Made for iPod" means that an electronic accessory has been designed to connect specifically to iPod and has been certified by the developer to meet Apple performance standards.
- Apple is not responsible for the operation of this device or its compliance with safety and regulatory standards.
- MPEG Layer-3 audio coding technology and patents licensed from Fraunhofer IIS and Thomson.
- All other trademarks and registered trademarks are of their respective holders. In this manual, ™ and ® marks are not specified.

Basic Operations

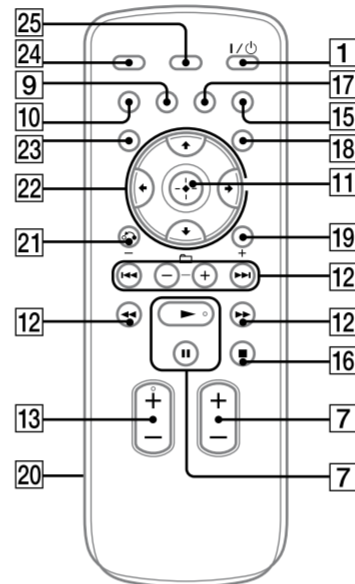
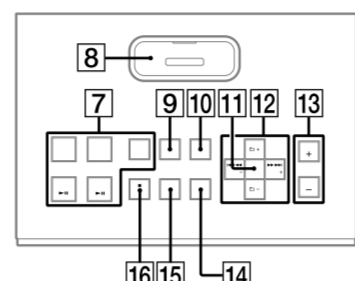
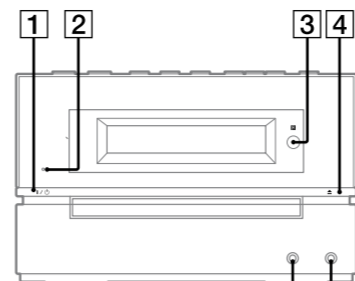

Notes

- If your country or region does not support DAB broadcast, "No Service" appears.
- Do not press any button on the unit or the remote during DAB Automatic Scan. If scanning is interrupted, run the DAB Automatic Scan again.
- If you move to another area, repeat this procedure to store the stations for your new area.
- This procedure clears all previously stored presets.
- Before unplugging the DAB antenna, make sure the system is turned off to preserve your own DAB settings.
- This tuner does not support data services.

To use the iPod

Insert an iPod Dock Adapter into the unit's connector **8** before use.

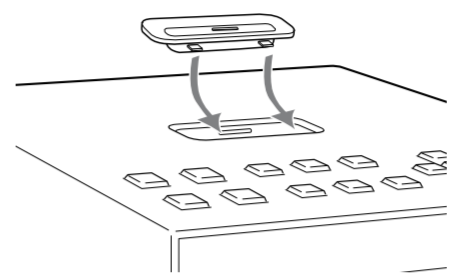

To remove the iPod Dock Adapter, pull it up with your fingernail or a flat object using the slot inside the adapter.

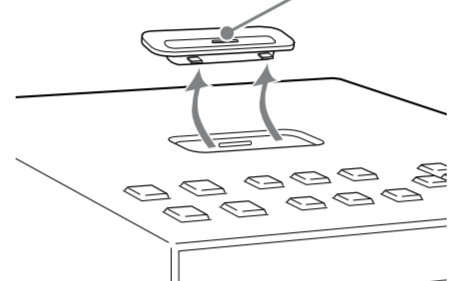

Note

The iPod Dock Adapter is not supplied with the system. Use the adapter supplied with your iPod when using an iPod model. For details on the iPod Dock Adapters, refer to the instructions supplied with the iPod Dock Adapters.

Adjusting the sound

To adjust the volume

Press VOLUME +/- (or VOL +/- on the unit) **13**.

To add a sound effect

To	Press
Generate a more dynamic sound (Dynamic Sound Generator X-tra)	DSGX 15 on the unit.
Set the sound effect	EQ 15 repeatedly to select "BASS" or "TREBLE," and then press +/- 12 repeatedly to adjust the level.

Playing a CD/MP3 disc

- Select the CD function.
Press FUNCTION +/- (or FUNCTION on the unit) **7** repeatedly.
- Place a disc.
Press **4** (open/close) **4** on the unit, and place a disc with the label side up on the disc tray.

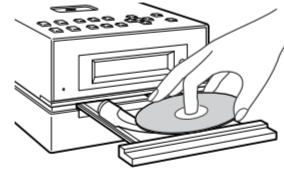

To close the disc tray, press **4** (open/close) **4** on the unit.

Do not force the disc tray closed with your finger, as this may damage the unit.

- Start playback.
Press **12** (play) (or CD **12** (play/pause) on the unit) **7**.

To	Press
Pause playback	12 (pause) (or CD 12 (play/pause) on the unit) 7 . To resume play, press the button again.
Stop playback	16 (stop) (or 16 /CANCEL on the unit) 16 .
Select a folder on an MP3 disc	14 +/- (select folder) 12 .
Select a track or file	12 (go back/go forward) 12 .
Find a point in a track or file	Hold down 12 (rewind/fast forward) 12 during playback, and release the button at the desired point.
Select Repeat Play	REPEAT 9 repeatedly until "REP" or "REPI" appears.

To change the play mode

Press PLAY MODE **10** repeatedly while the player is stopped. You can select normal play ("□"), for all MP3 files in the folder on the disc, shuffle play ("SHUF" or "SHUF**"), or program play ("PGM").

* When playing a CD-DA disc, **10** (SHUF) Play performs the same operation as normal (shuffle) play.



When scanning is complete, a list of available services is created.

To	Press
Choose the selected item	11 (enter) (or ENTER on the unit) 11 . You can choose the selected item much like the center button on the iPod or the touch operation of the iPod touch.
Find a point in a track or chapter of audiobook/podcast	12 (fast rewind/fast forward) 12 during playback, and release the button at the desired point.
Return to the previous menu or select a menu	19 (TOOL MENU) 19 (return) 21 . You can return to the previous menu or select a menu much like the Menu button on the iPod or the touch operation of the iPod touch.

To use the system as a battery charger

You can use the system as a battery charger for the iPod when the system is both on and off. The charging begins when the iPod is placed on the unit's connector **8**. The charging status appears in the iPod display. For details, see the user's guide of your iPod.

To stop charging the iPod

Remove the iPod. If you stop charging the iPod when the system is off, press DISPLAY **25** until the clock disappears in the display.

Notes

- When placing or removing the iPod, handle the iPod in the same angle as that of the iPod connector **8** on the unit and do not twist or sway the iPod to prevent connector damage.
- Do not carry the unit with an iPod set on the connector. Doing so may cause a malfunction.
- When placing or removing the iPod, brace the unit with one hand and take care not to press the controls of the iPod by mistake.
- Before disconnecting the iPod, pause playback.
- While playing video, you cannot use **12**. You can fast rewind (fast forward) by holding down **12**.
- To change the volume level, use VOLUME +/- (or VOL +/- on the unit) **13**. The volume level does not change even if adjusted on the iPod.
- This system is designed for iPod only. You cannot connect any other portable audio players.
- To use an iPod, refer to the user's guide of your iPod.
- Sony cannot accept responsibility in the event that data recorded to iPod is lost or damaged when using an iPod with this unit.

Changing the display

To	Press
Change information on the display ¹⁾	DISPLAY 25 repeatedly when the system is on.
Check the clock when the system is off ²⁾	DISPLAY 25 when the system is off ³⁾ . The clock is displayed for 8 seconds.

¹⁾ For example, you can view CD/MP3 disc information, such as:
 - track or file number during normal play.
 - track or file name ("JT") during normal play.
 - artist name ("J") during normal play.
 - album or folder name ("□") during normal play.
 - total playing time while the player is stopped.

You can also view DAB station information such as the service name, channel label, preset number, frequency, DLS (Dynamic Label Segment), or ensemble label.

²⁾ The clock is displayed continuously while the iPod is being charged. To turn off the clock display, press DISPLAY **25** (See "To stop charging the iPod").

³⁾ The STANDBY indicator **2** on the unit lights up when the system is off.

Notes on the display information

- Characters that cannot be displayed appear as ".".
- The following are not displayed:
 - total playing time for a CD-DA disc depending on the play mode.
 - total playing time and remaining playing time for an MP3 disc.
- The following are not displayed correctly:
 - folder and file names that do not follow either ISO9660 Level 1, Level 2 or Joliet in the expansion format.
- The following is displayed:
 - ID3 tag information for MP3 files when ID3 version 1 and version 2 tags are used (up to 62 characters).
 - up to 8 characters of service name, up to 128 characters of DLS (Dynamic Label Segment) and up to 16 characters of ensemble label.

Using optional audio components

To connect an optional headphones

Connect headphones to the PHONES jack **6** on the unit.

To connect an optional component

Connect additional audio component to the AUDIO IN jack **5** on the unit using an audio analog cord (not supplied). Turn down the volume on the system, and then select the AUDIO IN function.

Hooking up the system securely

Antennas

Find a location and an orientation that provide good reception, and then set up the antenna. Keep the antennas away from the speaker cords and the power cord to avoid picking up noise.

With a DAB external antenna (not supplied), you can obtain higher DAB broadcast sound quality. We recommend that you use the supplied FM/DAB lead antenna only temporarily until you install a DAB external antenna.

Before unplugging the DAB antenna, make sure the system is turned off to preserve your own DAB settings.

When carrying this system

- Remove a disc to protect the CD mechanism.
- Press FUNCTION +/- (or FUNCTION on the unit) **7** repeatedly to select the CD function.
- Hold down VOL + **13** and DSGX **15** on the unit, and press **4** on the unit until "STANDBY" appears.
- After "LOCK" appears, unplug the power cord.

Speakers

Make sure the metal leads (not the part covered with vinyl insulation) are securely inserted into the speaker jacks.

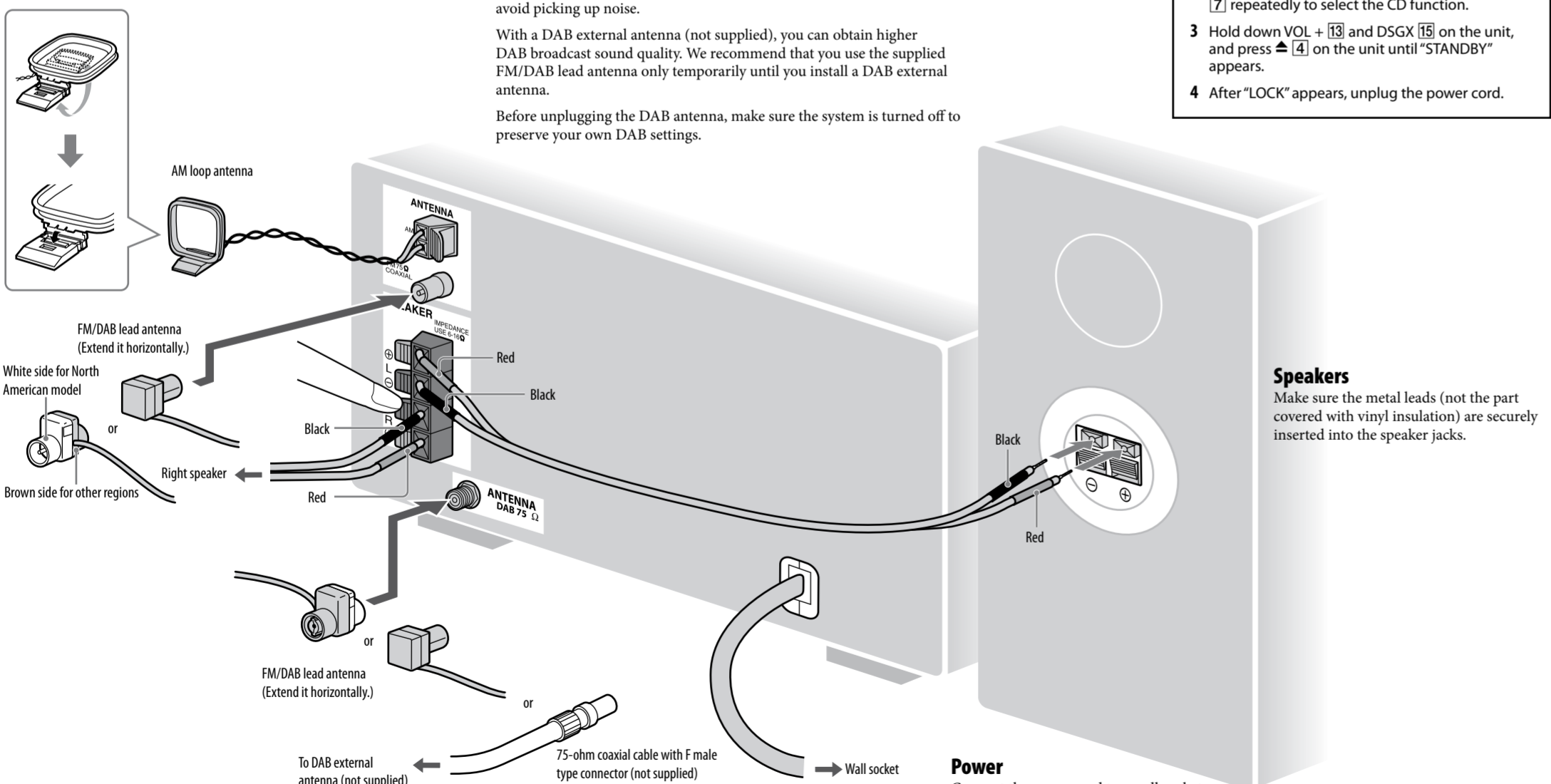

Power

Connect the power cord to a wall socket. If the plug does not fit the wall socket, detach the supplied plug adaptor (only for models equipped with an adaptor).

