

# Personal Audio Docking System

## Operating Instructions

RDP-XF100iP



©2010 Sony Corporation Printed in China

<http://www.sony.net/>



### WARNING

To reduce the risk of fire or electric shock, do not expose this apparatus to rain or moisture.

To reduce the risk of fire, do not cover the ventilation of the apparatus with newspapers, tablecloths, curtains, etc. And do not place lighted candles on the apparatus.

To reduce the risk of fire or electric shock, do not expose this apparatus to dripping or splashing, and do not place objects filled with liquids, such as vases, on the apparatus.

Do not install the appliance in a confined space, such as a bookcase or built-in cabinet.

Do not expose the batteries (battery pack or batteries installed) to excessive heat such as sunshine, fire or the like for a long time.

As the main plug is used to disconnect the unit from the mains, connect the unit to an easily accessible AC outlet. Should you notice an abnormality in the unit, disconnect the main plug from the AC outlet immediately.

The unit is not disconnected from the AC power source (mains) as long as it is connected to the wall outlet, even if the unit itself has been turned off.

The nameplate and important information concerning safety are located on the bottom exterior of main unit and on the surface of AC power adaptor.

### CAUTION

Danger of explosion if battery is incorrectly replaced. Replace only with the same type.

**Notice for customers: the following information is only applicable to equipment sold in countries applying EU directives**

The manufacturer of this product is Sony Corporation, 1-7-1 Konan Minato-ku Tokyo, 108-0075 Japan. The Authorized Representative for EMC and product safety is Sony Deutschland GmbH, Hedelfinger Strasse 61, 70327 Stuttgart, Germany. For any service or guarantee matters please refer to the addresses given in separate service or guarantee documents.

The validity of the CE marking is restricted to only those countries where it is legally enforced, mainly in the countries EEA (European Economic Area).

### Features

- Compatible with iPod/iPhone
- FM tuner with 20 station presets
- Rechargeable battery for portable use
- Audio in function
- Wireless remote commander supplied

### Precautions

- Operate the unit on the power source specified in "Specifications."
- To disconnect the AC power cord (mains lead), pull it out by the plug, not the cord.
- Since a strong magnet is used for the speaker, keep personal credit cards using magnetic coding or spring-wound watches away from the unit to prevent possible damage from the magnet.
- Do not leave the unit in a location near a heat source such as a radiator or a duct, or in a place subject to direct sunlight, excessive dust, mechanical vibration, or shock.
- Allow adequate air circulation to prevent internal heat build-up. Do not place the unit on a surface (a rug, a blanket, etc.) or near materials (a curtain) which might block the ventilation holes.
- Should any solid object or liquid fall into the unit, unplug the unit and have it checked by qualified personnel before operating it any further.
- To clean the casing, use a soft cloth dampened with a mild detergent solution.

### NOTES ON LITHIUM BATTERY

- Wipe the battery with a dry cloth to assure a good contact.
- Be sure to observe the correct polarity when installing the battery.
- Do not hold the battery with metallic tweezers, otherwise a short-circuit may occur.

### Disposal of Old Electrical & Electronic Equipment (Applicable in the European Union and other European countries with separate collection systems)

This symbol on the product or on its packaging indicates that this product shall not be treated as household waste. Instead it shall be handed over to the applicable collection point for the recycling of electrical and electronic equipment. By ensuring this product is disposed of correctly, you will help prevent potential negative consequences for the environment and human health, which could otherwise be caused by inappropriate waste handling of this product. The recycling of materials will help to conserve natural resources. For more detailed information about recycling of this product, please contact your local Civic Office, your household waste disposal service or the shop where you purchased the product. Applicable accessory: Remote Commander.

### Disposal of waste batteries (applicable in the European Union and other European countries with separate collection systems)

This symbol on the battery or on the packaging indicates that the battery provided with this product shall not be treated as household waste.

On certain batteries this symbol might be used in combination with a chemical symbol. The chemical symbols for mercury (Hg) or lead (Pb) are added if the battery contains more than 0.0005% mercury or 0.004% lead.

By ensuring these batteries are disposed of correctly, you will help prevent potentially negative consequences for the environment and human health which could otherwise be caused by inappropriate waste handling of the battery. The recycling of the materials will help to conserve natural resources.

In case of products that for safety, performance or data integrity reasons require a permanent connection with an incorporated battery, this battery should be replaced by qualified service staff only. To ensure that the battery will be treated properly, hand over the product at end-of-life to the applicable collection point for the recycling of electrical and electronic equipment.

For all other batteries, please view the section on how to remove the battery from the product safely. Hand the battery over to the applicable collection point for the recycling of waste batteries.

For more detailed information about recycling of this product or battery, please contact your local Civic Office, your household waste disposal service or the shop where you purchased the product.

If you have any questions or problems concerning your unit, please consult your nearest Sony dealer.

### Power sources

#### Preparing a power source

Charge the rechargeable battery before using this unit for the first time, or when the battery is depleted. You can operate the unit while charging.

- 1 Connect the AC power cord (supplied) to the AC power adaptor (supplied).
- 2 Connect the AC power adaptor to the **DC IN 20V** jack on the back of this unit firmly and plug it into a wall outlet.

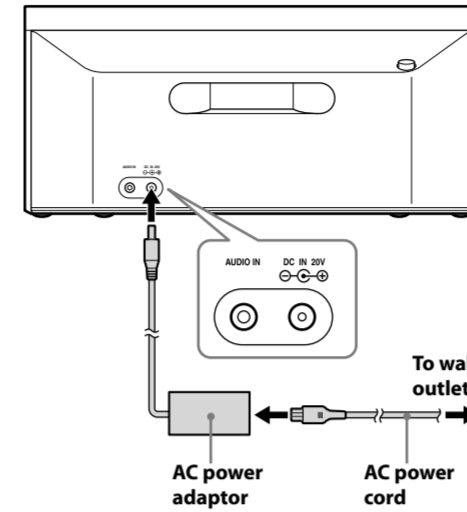

#### Note on the AC power adaptor

- Use the Sony supplied AC power adaptor only. The polarity of the plugs of other manufactures may be different. Failure to use the supplied AC power adaptor may cause the unit to malfunction.



- 3 Confirm that charging has started.

When charging start, the battery indicator appears. While charging, the charging indicator animation loops.

#### When the unit is turned off

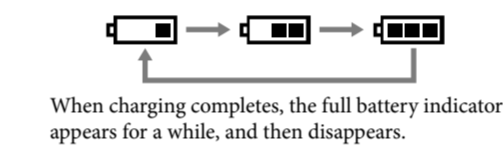

When charging completes, the full battery indicator appears for a while, and then disappears.



#### Notes

- If you connect the AC power adaptor when the battery is fully charged, the full battery indicator appears for a while, and then disappears.
- If you connect the AC power adaptor when the battery power is low, charging starts and the low battery and charging indicator animation loops.

The unit cannot perform operations without the AC power adaptor while the low battery indicator appears.



#### When the unit is turned on

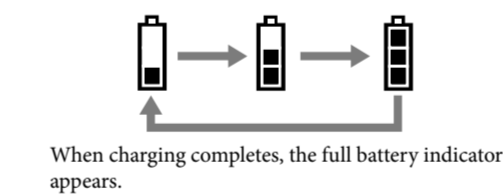

When charging completes, the full battery indicator appears.

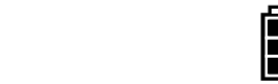

#### Note

- It will take approximately 7 hours to charge the battery.

#### Using the rechargeable battery

You can operate the unit with the rechargeable battery instead of the AC power adaptor.

#### Note

- The maximum output will be lower when the AC power adaptor is disconnected.

#### To check the remaining power of the battery

The remaining power of the battery will be indicated when the unit is turned on. As the remaining battery power depletes, the battery indicator decreases.

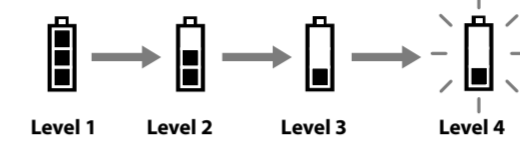

When the battery becomes almost fully depleted, "LOW BATT" flashes and the unit will turn off. To charge the battery, connect the AC power adaptor. (See "Preparing a power source.")



#### Notes

- The remaining battery power will not be indicated when the unit is turned off.
- The unit requires at least 30 minutes to charge the battery if "LOW BATT" appears.
- The battery indicator shows approximate remaining battery power.
- Operating conditions will affect the rate of battery depletion.

#### Battery life

When	Battery life
Playback of iPod	approx. 7hours*
FM reception	approx. 7hours

Measured in accordance with the JEITA (Japan Electronics and Information Technology Industries Association) standard.

\* Playback time measured using a fully charged rechargeable battery with a fully charged iPod classic.

#### When to replace the rechargeable battery pack

Repeated recharging causes the capacity of the rechargeable battery power to decrease over time. Replace the rechargeable battery pack when its capacity becomes half the usual time, even after charging the battery fully.

#### Note

- The rechargeable battery pack is not a commercially available product. To purchase a rechargeable battery pack (NH - 2000 RDP), consult with your nearest Sony dealer.

#### Replacing the rechargeable battery pack

- 1 Slide the latch to **UNLOCK**, and slide **RELEASE** in the direction of the arrow on the bottom of this unit. The battery compartment cover opens, then remove the cover.
- 2 Use a coin, etc., to pull out the rechargeable battery pack.
- 3 Remove the rechargeable battery pack and disconnect the lead from the jack inside the battery compartment.
- 4 Connect the lead of a new rechargeable battery pack to the jack and insert the battery in the unit.
- 5 Close the battery compartment cover and slide the latch to **LOCK**.

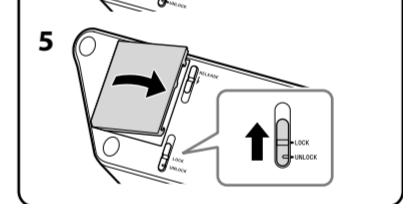
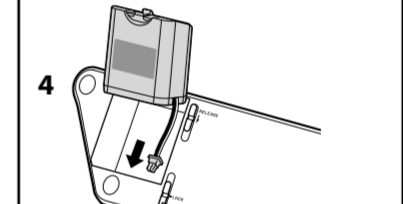
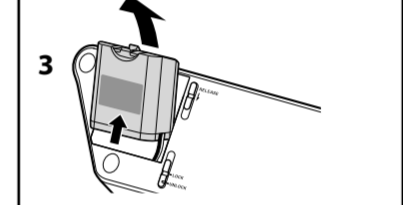
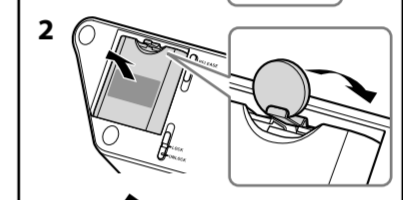
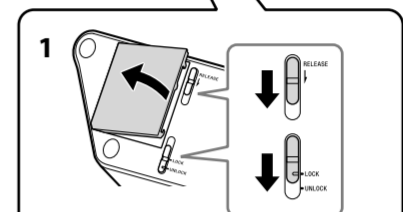
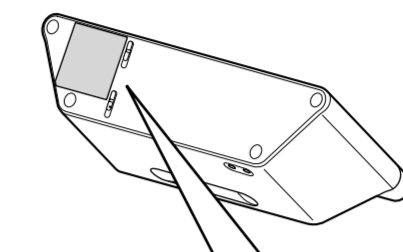

#### Notes

- Charge a new battery pack before use. See "Preparing a power source" for details.
- Turn off the unit, before replacing the rechargeable battery pack.
- When replacing the rechargeable battery pack, place a soft cloth, etc., under the unit.

#### Preparing the remote commander

Before using the remote commander for the first time, remove the insulation film.

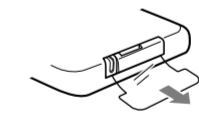

#### To know when to replace the battery

With normal use, the battery (CR2025) should last for about 6 months. When the remote commander no longer operates the unit, replace the battery with a new one.

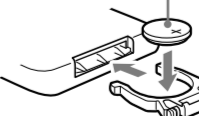
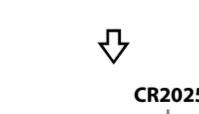

#### Notes

- Do not attempt to charge the battery.
- If you are not going to use the remote commander for a long time, remove the battery to avoid any damage that may be caused by leakage and corrosion.

