

S-MASTER
Digital Amplifier



CMT-CPZ3

© 2010 Sony Corporation Printed in China
http://www.sony.net/

WARNING

To reduce the risk of fire, do not cover the ventilation opening of the apparatus with newspapers, tablecloths, curtains, etc. Do not place the naked flame sources such as lighted candles on the apparatus.

To reduce the risk of fire or electric shock, do not expose this apparatus to dripping or splashing, and do not place objects filled with liquids, such as vases, on the apparatus.

Do not install the appliance in a confined space, such as a bookcase or built-in cabinet.

As the main plug is used to disconnect the unit from the mains, connect the unit to an easily accessible AC outlet. Should you notice an abnormality in the unit, disconnect the main plug from the AC outlet immediately.

Do not expose batteries or apparatus with battery-installed to excessive heat such as sunshine, fire or the like.

Excessive sound pressure from earphones and headphones can cause hearing loss.

CAUTION

The use of optical instruments with this product will increase eye hazard.

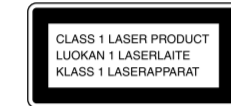

This appliance is classified as a CLASS 1 LASER product. This marking is located on the rear exterior.

Notice for customers: the following information is only applicable to equipment sold in countries applying EU directives.

The manufacturer of this product is Sony Corporation, 1-7-1 Konan Minato-ku, Tokyo, 108-0075 Japan. The Authorized Representative for EMC and product safety is Sony Deutschland GmbH, Hedelfinger Strasse 61, 70327 Stuttgart, Germany. For any service or guarantee matters, please refer to the addresses given in separate service or guarantee documents.



Disposal of Old Electrical & Electronic Equipment (Applicable in the European Union and other European countries with separate collection systems)

This symbol on the product or on its packaging indicates that this product shall not be treated as household waste. Instead it shall be handed over to the applicable collection point for the recycling of electrical and electronic equipment. By ensuring this product is disposed of correctly, you will help prevent potential negative consequences for the environment and human health, which could otherwise be caused by inappropriate waste handling of this product. The recycling of materials will help to conserve natural resources. For more detailed information about recycling of this product, please contact your local Civic Office, your household waste disposal service or the shop where you purchased the product.

Applicable accessories: Remote commander



Disposal of waste batteries (applicable in the European Union and other European countries with separate collection systems)

This symbol on the battery or on the packaging indicates that the battery provided with this product shall not be treated as household waste. On certain batteries this symbol might be used in combination with a chemical symbol. The chemical symbols for mercury (Hg) or lead (Pb) are added if the battery contains more than 0.0005% mercury or 0.004% lead. By ensuring these batteries are disposed of correctly, you will help prevent potentially negative consequences for the environment and human health which could otherwise be caused by inappropriate waste handling of the battery. The recycling of the materials will help to conserve natural resources.

In case of products that for safety, performance or data integrity reasons require a permanent connection with an incorporated battery, this battery should be replaced by qualified service staff only. To ensure that the battery will be treated properly, hand over the product at end-of-life to the applicable collection point for the recycling of electrical and electronic equipment.

For all other batteries, please view the section on how to remove the battery from the product safely. Hand the battery over to the applicable collection point for the recycling of waste batteries.

For more detailed information about recycling of this product or battery, please contact your local Civic Office, your household waste disposal service or the shop where you purchased the product.

Note on DualDiscs

A DualDisc is a two sided disc product which mates DVD recorded material on one side with digital audio material on the other side. However, since the audio material side does not conform to the Compact Disc (CD) standard, playback on this product is not guaranteed.

Music discs encoded with copyright protection technologies

This product is designed to playback discs that conform to the Compact Disc (CD) standard. Recently, various music discs encoded with copyright protection technologies are marketed by some record companies. Please be aware that among those discs, there are some that do not conform to the CD standard and may not be playable by this product.

MPEG Layer-3 audio coding technology and patents licensed from Fraunhofer IIS and Thomson.

Basic Operations

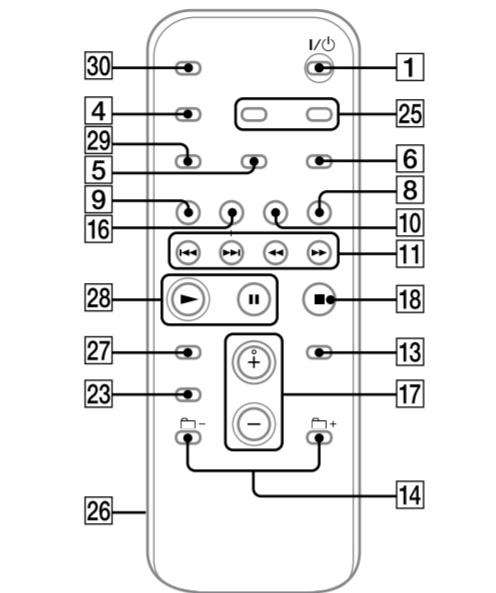
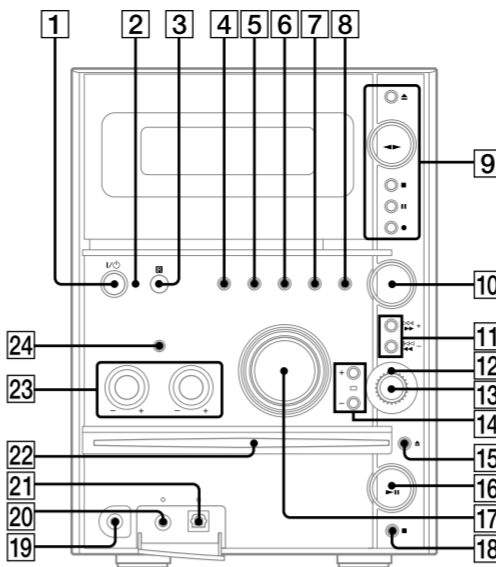

Before using the system

To use the remote

Slide and remove the battery compartment lid 26, and insert the two supplied R6 (size AA) batteries, + side first, matching the polarities shown below.

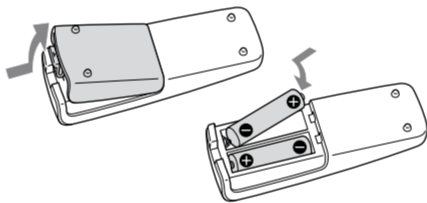

Notes on using the remote

- With normal use, the batteries should last for about six months.
- Do not mix an old battery with a new one or mix different types of batteries.
- If you do not use the remote for a long period of time, remove the batteries to avoid damage from battery leakage and corrosion.

To set the clock

- 1 Turn on the system.
Press I/O (power) 1.
- 2 Select the clock set mode.
Press CLOCK/TIMER SET 25 on the remote. If the current mode appears on the display, press <<< 11 on the remote repeatedly to select "CLOCK SET" and then press ENTER 13 on the remote.
- 3 Set the time.
Press <<< 11 on the remote repeatedly to set the hour, and then press ENTER 13 on the remote. Use the same procedure to set the minute. The clock settings are lost when you disconnect the power cord or if a power failure occurs.

Speaker pads

Attach the supplied speaker pads to the bottom of the speakers to prevent slipping.

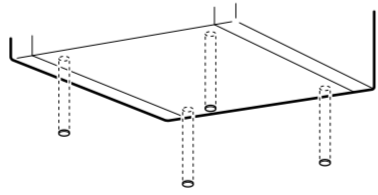

To display the clock when the system is off

Press DISPLAY 4. The clock is displayed for about 8 seconds.

Selecting a music source

Press the following buttons (or press FUNCTION 8 repeatedly).

To select	Press
CD	CD 16 on the remote.
Tuner	TUNER/BAND 10.
Tape	TAPE 9 on the remote.
Component (connected using an audio cord)	FUNCTION 8 repeatedly until "MD" appears.

Adjusting the sound

To adjust the volume

Press VOLUME +/- on the remote (or turn the VOLUME control on the unit) 17.

To add a sound effect

To	Press
Generate a more dynamic sound (Dynamic Sound Generator X-tra)	DSGX 24 on the unit.
Set the sound effect	EQ 23 on the remote repeatedly to select "BASS" or "TREBLE," and then press +/- 11 on the remote repeatedly (or turn the BASS or TREBLE control 23 on the unit) to adjust the level.

Playing a CD/MP3 disc

- 1 Select the CD function.
Press CD 16 on the remote.
- 2 Load a disc.
Insert a disc in the disc slot 22 with the label side up.

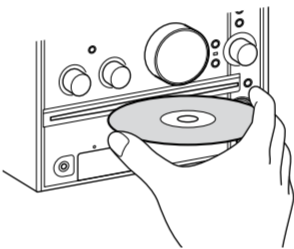

- 3 Start playback.
Press >>> (play) 28 on the remote (or CD >>> (play/pause) 16 on the unit).

To	Press
Pause playback	II (pause) 28 on the remote (or CD >>> (play/pause) 16 on the unit). To resume play, press the button again.
Stop playback	■ (stop) 18.
Remove a disc	CD ▲ (eject) 15 on the unit.
Select a group on an MP3 disc	□ +/- 14. Or turn the jog dial 12 on the unit and press PUSH ENTER 13 on the unit (turn the jog dial 12 on the unit during playback until "GROUP" appears, and then press PUSH ENTER 13 on the unit to select the desired group).
Select a track or file	◀◀ (go back/go forward) 11. Or turn the jog dial 12 on the unit and press PUSH ENTER 13 on the unit. To cancel, press CANCEL 18 on the unit.
Find a point in a track or file	Hold down <<< (rewind/fast forward) 11 during playback, and release the button at the desired point.
Select Repeat Play	REPEAT 6 repeatedly until "REP" or "REP 1" appears.

To change the play mode

Press PLAY MODE 5 repeatedly while the player is stopped. You can select normal play ("□") for all MP3 files in the group on the disc, shuffle play ("SHUF" or "SHUF**"), or program play ("PGM").
*When playing a CD-DA disc, □ (SHUF) Play performs the same operation as SHUF Play.

Notes on loading discs

- When you turn on the system, the disc is not pulled into the disc slot until "NO DISC" appears in the display. Do not attempt to push in the disc until "NO DISC" appears.
- If you load a disc that is not playable by this system, it will be ejected automatically.
- Do not load an 8 cm disc with an adaptor. Doing so may cause the system to malfunction.
- When you remove a disc, handle the disc by its edge and pull it straight out of the disc slot. Do not touch the surface.

Note on the jog dial

Only the first 9 characters are displayed when performing the group search, track search, or file search.

Notes on Repeat Play

- All tracks or files on a disc are played repeatedly up to five times.
- "REP 1" indicates that a single track or file is repeated until you stop it.

Notes on playing MP3 discs

- Do not save other types of files or unnecessary groups on a disc that has MP3 files.
- Groups that have no MP3 files are skipped.
- MP3 files are played back in the order that they are recorded onto the disc.
- The system can only play MP3 files that have a file extension of ".MP3".
- If there are files on the disc that have the "MP3" file extension, but that are not MP3 files, the unit may produce noise or may malfunction.
- The maximum number of:
 - groups is 256 (including the root folder).
 - MP3 files is 511.
 - MP3 files and groups that can be contained on a single disc is 512.
 - directory levels (the tree structure of files) is 8.
- Compatibility with all MP3 encoding/writing software, recording device, and recording media cannot be guaranteed. Incompatible MP3 discs may produce noise or interrupted audio or may not play at all.

Notes on playing multisession discs

- If the disc begins with a CD-DA (or MP3) session, it is recognized as a CD-DA (or MP3) disc, and other sessions are not played back.
- A disc with a mixed CD format is recognized as a CD-DA (audio) disc.

Listening to the radio

- 1 Select "FM" or "AM."
Press TUNER/BAND 10 repeatedly.
- 2 Select the tuning mode.
Press TUNING MODE 5 repeatedly until "AUTO" appears.
- 3 Tune in the desired station.
Press +/- on the remote (or TUNING +/- on the unit) 11. Scanning stops automatically when a station is tuned in, and then "TUNED" and "STEREO" (for stereo programs) appear.

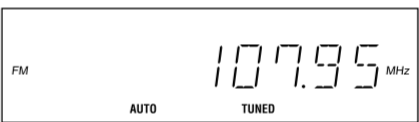

When you tune in a station that provides RDS services, the station name appears on the display.

To stop automatic scanning

Press ■ (stop) 18 on the remote.

To tune in a station with a weak signal

If "TUNED" does not appear and the scanning does not stop, press TUNING MODE 5 repeatedly until "AUTO" and "PRESET" disappear, and then press +/- on the remote (or TUNING +/- on the unit) 11 repeatedly to tune in the desired station.

To reduce static noise on a weak FM stereo station

Press FM MODE 6 repeatedly until "MONO" appears to turn off stereo reception.

Playing a tape

- 1 Select the tape function.
Press TAPE 9 on the remote.
- 2 Insert a tape.
Press TAPE ▲ (eject) 9 on the unit, and load a TYPE I (normal) tape into the cassette holder with the side you want to play facing forward. Make sure there is no slack in the tape to avoid damaging the tape or the tape deck.
- 3 Press DIRECTION 5 on the unit repeatedly to select "←" to play one side. Select "→" or "↔" to play both sides.
- 4 Start playback.
Press >>> (play) 28 on the remote (or TAPE <<< (play) 9 on the unit). Press the button again to play the reverse side.

To	Press
Pause playback	II (pause) 28 on the remote (or TAPE II (pause) 9 on the unit). To resume play, press the button again.
Stop playback	■ (stop) 18 on the remote (or TAPE ■ (stop) 9 on the unit).
Rewind or fast forward	<<< (rewind/fast forward) 11.

Tip

If you select "↔," the tape deck stops automatically after repeating the sequence five times.

Changing the display

To	Press
Change information on the display ¹⁾	DISPLAY 4 repeatedly when the system is on.
Check the clock when the system is off ²⁾	DISPLAY 4 when the system is off ²⁾ . The clock is displayed for about 8 seconds.

¹⁾ For example, you can view CD/MP3 disc information, such as the track or file number or group name during normal play, or the total play time while the player is stopped.
²⁾ The STANDBY indicator 2 on the unit lights up when the system is off.

Notes on the display information

- The following are not displayed:
 - total playing time for a CD-DA disc depending on the play mode.
 - total playing time for an MP3 disc.
 - remaining playing time for an MP3 file.
- The following are not displayed correctly:
 - elapsed playing time of an MP3 file encoded using a VBR (variable bit rate).
 - group and file names that do not follow either the ISO9660 Level 1, Level 2 or Joliet in the expansion format.
- The following are displayed:
 - ID3 tag information for MP3 files when ID3 version 1 and version 2 tags are used.
 - up to 124 characters of ID3 tag information using uppercase letters (A to Z), numbers (0 to 9), and symbols (<> * +, - / @ [\] _).

Using optional audio components

To connect an optional headphones

Connect headphones to the PHONES jack 19 on the unit.

To connect an optional analog component

Connect additional analog component to the ANALOG IN jack 20 on the unit using an audio analog cord (not supplied). Turn down the volume on the system, and then press FUNCTION 8 repeatedly to select "MD."

To connect an optional digital component

Connect a component with a digital optical input jack to the CD DIGITAL OUT jack 21 on the unit using a digital optical cord (square, not supplied). You can digitally record from a CD-DA disc onto the connected component.

Note

You cannot make a digital recording of copy guarded discs and MP3 tracks using a digital component connected to this system.

Hooking up the system securely

Speakers

Press down on the tab below the jack on the speaker and insert the appropriate speaker cord. Make sure the metal leads (not the part covered with vinyl insulation) are securely inserted into the speaker jacks. Insert the end of the cord marked with a red line into the + jack and the cord with no marking into the - jack.

Make sure to match the projections on the SPEAKER jacks on the unit and the speaker cords, and insert the cords firmly to the SPEAKER jacks.

Antennas

Find a location and an orientation that provide good reception, and then set up the antenna. Keep the antennas away from the speaker cords and the power cord to avoid picking up noise.

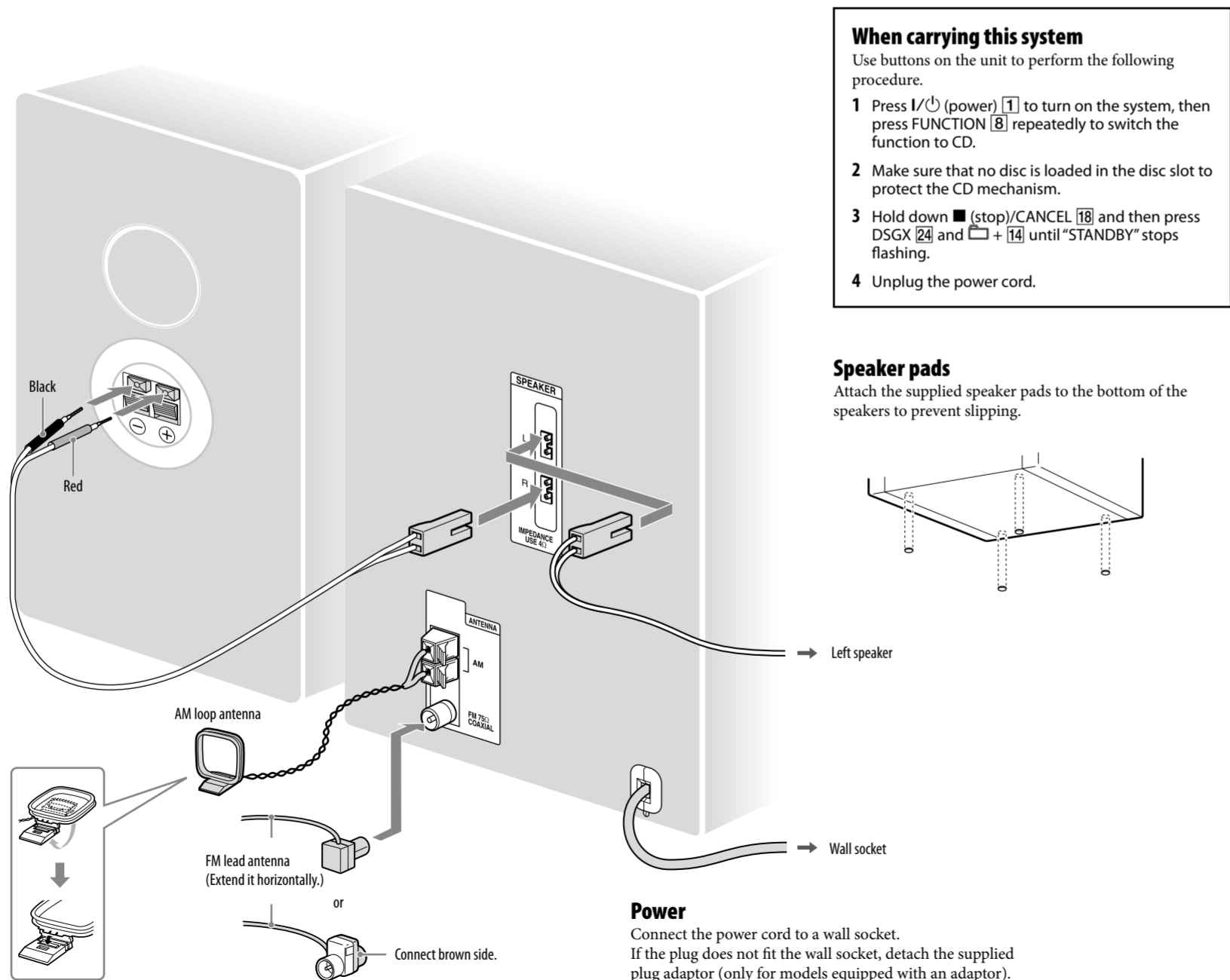

When carrying this system

Use buttons on the unit to perform the following procedure.

- 1 Press I/O (power) 1 to turn on the system, then press FUNCTION 8 repeatedly to switch the function to CD.
- 2 Make sure that no disc is loaded in the disc slot to protect the CD mechanism.
- 3 Hold down ■ (stop)/CANCEL 18 and then press DSGX 24 and □ + 14 until "STANDBY" stops flashing.
- 4 Unplug the power cord.

Power

Connect the power cord to a wall socket. If the plug does not fit the wall socket, detach the supplied plug adaptor (only for models equipped with an adaptor).

Other Operations

Creating your own CD program (Program Play)

Use buttons on the remote to create your own program.

1 Press CD [Ⓜ] to select the CD function.

2 Press PLAY MODE [Ⓟ] repeatedly until “PGM” appears while the player is stopped.

3 Press [◀]/[▶][Ⓜ] repeatedly until the desired track number appears.

When programming MP3 files, press [⏪] +/− [Ⓜ] repeatedly to select the desired group, and then select the desired file.

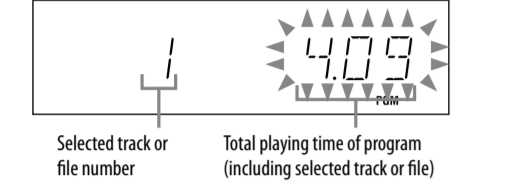

4 Press ENTER [⏏] to add the track or file to the program.

“— . — . —” appears when the total time exceeds 100 minutes for a disc, or when you select a CD track whose number is 21 or over, or when you select an MP3 file.

5 Repeat steps 3 through 4 to program additional tracks or files, up to a total of 25 tracks or files.

6 To play your program of tracks or files, press [▶] (play) [Ⓞ].

The program remains available until you eject the disc. To play the same program again, select the CD function, and press [▶] (play) [Ⓞ].

To cancel Program Play

Press PLAY MODE [Ⓟ] repeatedly until “PGM” disappears while the player is stopped.

To delete the last track or file of the program

Press CLEAR [Ⓟ] while the player is stopped.

To view program information, such as total track number of the program

Press DISPLAY [Ⓕ] repeatedly.

Tip
You can also use the jog dial [Ⓜ] on the unit to select files in step 3. Turn the jog dial [Ⓜ] and press PUSH ENTER [⏏] on the unit to select the desired group, and then select the desired file.

Presetting radio stations

You can preset your favorite radio stations and tune them in instantly by selecting the corresponding preset number.

Use buttons on the remote to preset stations.

1 Tune in the desired station (see “Listening to the radio”).

2 Press TUNER MEMORY [Ⓞ].



3 Press +/− [Ⓜ] repeatedly to select your desired preset number.

If another station is already assigned to the selected preset number, the station is replaced by the new station.

4 Press ENTER [⏏].

5 Repeat steps 1 through 4 to store other stations. You can preset up to 20 FM and 10 AM stations. The preset stations are retained for about half a day even if you disconnect the power cord or if a power failure occurs.

6 To call up a preset radio station, press TUNING MODE [Ⓟ] repeatedly until “PRESET” appears, and then press +/− [Ⓜ] repeatedly to select the desired preset number.

Recording onto a tape

You can record on a TYPE I (normal) tape in two ways:

CD Synchro Recording:

You can record an entire CD onto a tape.

Manual Recording:

You can record just the portions you like from a sound source, including connected audio components.

Use buttons on the unit to control tape recording.

1 Load a recordable tape with the side you want to record facing forward.

2 Prepare the tape deck for recording. Press FUNCTION [Ⓞ] repeatedly to select the tape function. Press DIRECTION [Ⓟ] on the unit repeatedly and select “↔” to record on one side, or “→” or “←” to record on both sides. To switch the recording sides of the tape, press TAPE [◀][▶] (play) [Ⓞ] repeatedly (“▶” appears for recording on the front, and “◀” for the reverse side), and then press TAPE [■] (stop) [Ⓞ].

3 Prepare the recording source. For CD Synchro Recording: Press FUNCTION [Ⓞ] repeatedly to select the CD function. Load the disc you want to record. When recording a group from an MP3 disc, press PLAY MODE [Ⓟ] repeatedly to select “[⏪]” and then press [⏪] +/− [Ⓜ] repeatedly to select the desired group.

To record only your favorite CD tracks in your desired order, perform steps 2 through 5 of “Creating your own CD program.”

For Manual Recording: Select the desired source to record. For Rec Timer: Tune in the preset radio station.

When recording a group from an MP3 disc, press PLAY MODE [Ⓟ] repeatedly to select “[⏪]” and then press [⏪] +/− [Ⓜ] repeatedly to select the desired group.

To record only your favorite CD tracks in your desired order, perform steps 2 through 5 of “Creating your own CD program.”

For Manual Recording: Select the desired source to record.

4 Set the tape deck to stand by for recording.

For CD Synchro Recording: Press CD SYNCHRO [Ⓜ].

For Manual Recording: Press TAPE [●] REC [Ⓞ].

5 Start recording.

While recording, you cannot listen to other sources.

For CD Synchro Recording: Press TAPE [⏏] (pause) [Ⓞ]. When the recording is completed, the CD player and the tape deck stop automatically. If both sides of the tape are being recorded on, and the tape reaches the end of the front side part-way through a track, the entire track is recorded again from the beginning of the reverse side. For Manual Recording: Press TAPE [⏏] (pause) [Ⓞ], and then start playing the desired recording source. If there is noise while recording from the tuner, reposition the appropriate antenna to reduce the noise.

To stop recording

Press TAPE [■] (stop) [Ⓞ] or CD [■] (stop) [Ⓜ] (for CD Synchro Recording only).

To pause recording (Manual Recording only)

Press TAPE [⏏] (pause) [Ⓞ].

Notes

- Recording stops if you change to a different function.
- You cannot eject the disc during CD Synchro Recording.

Tips

- If you stop the CD Synchro Recording by pressing CD [■] (stop) [Ⓜ], the tape stops after making about a 4 seconds blank (unrecorded) space before stopping.
- When you record on both sides, be sure to start from the front side. If you start from the reverse side, recording stops at the end of the reverse side.

Using the Timers

The system offers three timer functions. You cannot activate both the Play Timer and the Rec Timer at the same time. If you use either with the Sleep Timer, the Sleep Timer has priority.

Sleep Timer:

You can fall asleep to music. This function works even if the clock is not set.

Press SLEEP [Ⓞ] on the remote repeatedly. If you select “AUTO,” the system automatically turns off after the current disc or tape stops or in 100 minutes.

Play Timer:

You can wake up to CD, tape or tuner at a preset time.

Rec Timer:

You can record a preset radio station at a specified time. Use buttons on the remote to control the Play Timer and the Rec Timer. Make sure you have set the clock.

1 Prepare the sound source.

For Play Timer: Prepare the sound source, and then press VOLUME +/− [Ⓜ] to adjust the volume. To start from a specific CD track or MP3 file, create your own CD program.

For Rec Timer: Tune in the preset radio station.

2 Press CLOCK/TIMER SET [Ⓞ].

3 Press [◀]/[▶][Ⓜ] repeatedly to select “PLAY SET” or “REC SET” then press ENTER [⏏].

“ON TIME” appears, and the hour indication flashes.

4 Set the time to start playing or recording.

Press [◀]/[▶][Ⓜ] repeatedly to set the hour, and then press ENTER [⏏].

The minute indication flashes. Use the procedure above to set the minute.

5 Use the same procedure as in step 4 to set the time to stop playing or recording.

6 Select the sound source or prepare the tape.

For Play Timer: Press [◀]/[▶][Ⓜ] repeatedly until the desired sound source appears, and then press ENTER [⏏]. The display shows the timer settings.

For Rec Timer: Load a recordable tape and press TAPE [Ⓞ] to select the tape function.

Press DIRECTION [Ⓟ] on the unit repeatedly and select “↔” to record on one side, or “→” or “←” to record on both sides.

To switch the recording sides of the tape, press [▶] (play) [Ⓞ] repeatedly (“▶” appears for recording on the front, and “◀” for the reverse side), and then press [■] (stop) [Ⓜ].

7 Press I/⏏ (power) [Ⓜ] to turn off the system. The system turns on 15 seconds before the preset time. If the system is on at the preset time, the Play Timer and the Rec Timer will not play or record.

To activate or check the timer again
Press CLOCK/TIMER SELECT [Ⓞ], press [◀]/[▶][Ⓜ] repeatedly until “PLAY SEL” or “REC SEL” appears, and then press ENTER [⏏].

To cancel the timer

Repeat the same procedure as above until “TIMER OFF” appears, and then press ENTER [⏏].

To change the setting

- Tips**
- The Play Timer setting remains as long as the setting is not canceled manually.
- The Rec Timer is canceled automatically after the Rec Timer has been activated.
- The volume is reduced to minimum during the Rec Timer.

Troubleshooting

1 Make sure the power cord and speaker cords are correctly and firmly connected.

2 Find your problem in the checklist below, and take the indicated corrective action.

If the issue persists, contact your nearest Sony dealer.

If the STANDBY indicator flashes Immediately unplug the power cord, and check the following item. <ul style="list-style-type: none">If your system has a voltage selector, is the voltage selector set to the correct voltage? Are the + and − speaker cords short-circuited? Are you using only the supplied speakers? Is anything blocking the ventilation holes on the rear of the system? After the STANDBY indicator [2] stops flashing, reconnect the power cord, and turn on the system. If the issue persists, contact your nearest Sony dealer.

General

Sound comes from one channel, or the left and right volumes are unbalanced.

- Place the speakers as symmetrically as possible.
- Connect only the supplied speakers.

Severe hum or noise.

- Move the system away from sources of noise.
- Connect the system to a different wall socket.
- Install a noise filter (available separately) to the power cord.

The remote does not function.

- Remove any obstacles between the remote and the remote sensor [3] on the unit, and position the unit away from fluorescent lights.
- Point the remote at the system’s sensor.
- Move the remote closer to the system.

CD/MP3 player

The sound skips, or the disc will not play.

- Wipe the disc clean, and replace it.
- Move the system to a location away from vibration (for example, on top of a stable stand).
- Move the speakers away from the system, or place them on separate stands. At high volume, speaker vibration may cause the sound to skip.

Play does not start from the first track.

- Return to Normal Play by pressing PLAY MODE [Ⓟ] repeatedly until both “PGM” and “SHUF” disappear.

Starting playback takes more time than usual.

- The following discs take a longer time to start playback.
 - a disc recorded with a complicated tree structure.
 - a disc recorded in multisession mode.
 - a disc that has not been finalized (a disc to which data can be added).
 - a disc that has many groups.

Tuner

Severe hum or noise, or stations cannot be received.

- Connect the antenna properly.
- Find a location and an orientation that provide good reception, and then set up the antenna again.
- Connect a commercially available external antenna.
- Keep the antenna away from the speaker cords and the power cord to avoid picking up noise.
- Consult your nearest Sony dealer if the supplied AM antenna has come off the plastic stand.
- Turn off nearby electrical equipment.

Tape deck

The sound exhibits excessive wow or flutter or dropout.

- Clean the capstans, pinch rollers and tape heads. See “Precautions” for details.

To improve tuner reception

Turn off CD player power by using the CD power management function. By default, CD power is turned on.

1 Press FUNCTION [Ⓞ] repeatedly to select the CD function.
2 Press I/⏏ (power) [Ⓜ] to turn off the system.
3 After “STANDBY” stops flashing, press DISPLAY [Ⓕ] to display the clock, and then press I/⏏ (power) [Ⓜ] while holding down CD [■] (stop) [Ⓜ]. “CD POWER” and “OFF” appear. With CD player power turned off, disc access time is increased. To turn on CD player power, repeat the procedure until “CD POWER” and “ON” appear.

To reset the system to factory settings

If the system still does not operate properly, reset the system to factory settings. Use buttons on the unit to reset the unit to its factory default settings.

1 Disconnect and reconnect the power cord, and then turn on the system.
2 Press TAPE [■] (stop) [Ⓞ], DISPLAY [Ⓕ] and I/⏏ (power) [Ⓜ] at the same time.

All user-configured settings, such as preset radio stations, timer, and the clock, are deleted.

Messages

COMPLETE: The preset operation ended normally.
LOCKED: Contact your nearest Sony dealer.
NO DISC: There is no disc in the player, or you have loaded a disc that cannot be played.
NO STEP: All of the programmed tracks have been erased.

NO TAB: You cannot record because the overwrite protection tab has been removed from the cassette.

NO TAPE: There is no tape in the tape deck.

NOT IN USE: You pressed an invalid button.

OVER: You have reached the end of the disc while pressing [▶] (fast forward) [Ⓜ] during playback or pause.

PUSH SELECT: You tried to set the clock or timer during timer operation.

PUSH STOP: You pressed PLAY MODE [Ⓟ] during playback.

SET CLOCK: You tried to select the timer when the clock is not set.

SET TIMER: You tried to select the timer when the Play Timer or Rec Timer is not set.

STEP FULL: You tried to program more than 25 tracks or files (steps).

TIME NG: The Play Timer or Rec Timer start and end times are set to the same time.

Display	indicates
[2]	2 (two)
[6]	6 (six)
[8]	8 (eight)
[A]	A
[B]	B
[D]	D
[G]	G
[H]	H
[K]	K
[M]	M
[O]	O or 0 (zero)
[Q]	Q
[R]	R
[5]	5 or 5 (five)
[Z]	Z
[,]	,
[@]	@

Precautions

Discs that this system CAN play

- Audio CD
- CD-R/CD-RW (audio data/MP3 files)

Discs that this system CANNOT play

- CD-ROM
- CD-R/CD-RW other than those recorded in music CD format or MP3 format conforming to ISO9660 Level 1/Level 2, Joliet
- CD-R/CD-RW recorded in multisession that have not ended by “closing the session”
- CD-R/CD-RW of poor recording quality, CD-R/CD-RW that have scratches or are dirty, or CD-R/CD-RW recorded with an incompatible recording device
- CD-R/CD-RW which is finalized incorrectly
- Discs containing files other than MPEG 1 Audio Layer-3 (MP3) files
- Discs of non-standard shape (for example, heart, square, star)
- Discs that have adhesive tape, paper, or sticker attached to them
- Rental or used discs with attached seals where the glue extends beyond the seal
- Discs that have labels printed using ink that feels tacky when touched
- An 8 cm disc with an adaptor

Notes on discs

- Before playing, wipe the disc with a cleaning cloth from the center out to the edge.
- Do not clean discs with solvents, such as benzene, thinner, or commercially available cleaners or anti-static spray intended for vinyl LPs.
- Do not expose discs to direct sunlight or heat sources such as hot air ducts, nor leave it in a car parked in direct sunlight.

On safety

- The unit is not disconnected from the AC power source (mains) as long as it is connected to the wall socket, even if the unit itself has been turned off.
- Completely disconnect the power cord (mains lead) from the wall socket (mains) if it is not going to be used for an extended period of time. When unplugging the unit, always grip the plug. Never pull the cord itself.
- Should any solid object or liquid get into the system, unplug the system, and have it checked by qualified personnel before operating it again.
- The AC power cord can be changed only by a qualified service facility.

On placement

- Do not place the system in an inclined position or in locations that are extremely hot, cold, dusty, dirty, or humid or lacking adequate ventilation, or subject to vibration, direct sunlight or a bright light.

- Be careful when placing the unit or speakers on surfaces that have been specially treated (for example, with wax, oil, polish) as staining or discoloration of the surface may result.
- If the system is brought directly from a cold to a warm location or is placed in a very damp room, moisture may condense on the lens inside the CD player, and cause the system to malfunction. In this situation, remove the disc, and leave the system turned on for about a few hours until the moisture evaporates.

On heat buildup

• Heat buildup on the unit during operation is normal and is not cause for alarm.

- Do not touch the cabinet if it has been used continuously at a high volume because the cabinet may have become hot.

- Do not obstruct the ventilation holes.

On the speaker system

This speaker system is not magnetically shielded, and the picture on nearby TV sets may become magnetically distorted. In this situation, turn off the TV, wait 15 to 30 minutes, and turn it back on. If there is no improvement, move the speakers far away from the TV.

Cleaning the cabinet

Clean this system with a soft cloth slightly moistened with a mild detergent solution. Do not use any type of abrasive pad, scouring powder, or solvent, such as thinner, benzine, or alcohol.

To prevent a tape from being accidentally recorded over

Break off the cassette’s overwrite protection tab from side A or B as illustrated.