

# FM/AM Clock Radio

## Operating Instructions

### ICF-C7iP

### DREAM MACHINE

Dream Machine is a trademark of Sony Corporation.



No Power No Problem is a trademark of Sony Corporation.

©2009 Sony Corporation Printed in China

<http://www.sony.net/>



## WARNING

To reduce the risk of fire or electric shock, do not expose this apparatus to rain or moisture.

To reduce the risk of fire, do not cover the ventilation of the apparatus with newspapers, tablecloths, curtains, etc. And do not place lighted candles on the apparatus.

To reduce the risk of fire or electric shock, do not expose this apparatus to dripping or splashing, and do not place objects filled with liquids, such as vases, on the apparatus.

Do not install the appliance in a confined space, such as a bookcase or built-in cabinet.

Do not expose the batteries (battery pack or batteries installed) to excessive heat such as sunshine, fire or the like for a long time.

As the main plug is used to disconnect the unit from the mains, connect the unit to an easily accessible AC outlet. Should you notice an abnormality in the unit, disconnect the main plug from the AC outlet immediately.

### CAUTION

Danger of explosion if battery is incorrectly replaced. Replace only with the same or equivalent type.

**Notice for customers: the following information is only applicable to equipment sold in countries applying EU directives**

The manufacturer of this product is Sony Corporation, 1-7-1 Konan, Minato-ku, Tokyo, 108-0075 Japan. The Authorized Representative for EMC and product safety is Sony Deutschland GmbH, Hedelfinger Strasse 61, 70327 Stuttgart, Germany. For any service or guarantee matters, please refer to the addresses given in separate service or guarantee documents.

## Features

- Wake or sleep to iPod/Radio
- Dual Alarm
- FM/AM 2-band digital synthesized tuner
- 30 Station Presets (20 FM, 10 AM)
- Brightness Control (High/Mid/Low)
- Extendable Snooze system from 10 to 60 min
- No Power No Problem alarm system to keep the clock and the alarm operating during a power interruption with a CR2032 battery installed

## Precautions

- Operate the unit on the power source specified in "Specifications."
- To disconnect the AC power cord (mains lead), pull it out by the plug, not the cord.
- The unit is not disconnected from the AC power source (mains) as long as it is connected to the wall outlet, even if the unit itself has been turned off.
- Since a strong magnet is used for the speaker, keep personal credit cards using magnetic coding or spring-wound watches away from the unit to prevent possible damage from the magnet.
- Do not leave the unit in a location near a heat source such as a radiator or airduct, or in a place subject to direct sunlight, excessive dust, mechanical vibration, or shock.
- Allow adequate air circulation to prevent internal heat build-up. Do not place the unit on a surface (a rug, a blanket, etc.) or near materials (a curtain) which might block the ventilation holes.
- Should any solid object or liquid fall into the unit, unplug the unit and have it checked by qualified personnel before operating it any further.
- To clean the casing, use a soft cloth dampened with a mild detergent solution.
- Never touch the wire of the external FM aerial during a thunderstorm. Furthermore, immediately disconnect the AC power cord from the radio.

### NOTES ON LITHIUM BATTERY

- Wipe the battery with a dry cloth to assure a good contact.
- Be sure to observe the correct polarity when installing the battery.
- Do not hold the battery with metallic tweezers, otherwise a short-circuit may occur.



**Disposal of Old Electrical & Electronic Equipment (Applicable in the European Union and other European countries with separate collection systems)**

This symbol on the product or on its packaging indicates that this product shall not be treated as household waste. Instead it shall be handed over to the applicable collection point for the recycling of electrical and electronic equipment. By ensuring this product is disposed of correctly, you will help prevent potential negative consequences for the environment and human health, which could otherwise be caused by inappropriate waste handling of this product. The recycling of materials will help to conserve natural resources. For more detailed information about recycling of this product, please contact your local Civic Office, your household waste disposal service or the shop where you purchased the product.



**Disposal of waste batteries (applicable in the European Union and other European countries with separate collection systems)**

This symbol on the battery or on the packaging indicates that the battery provided with this product shall not be treated as household waste. On certain batteries this symbol might be used in combination with a chemical symbol. The chemical symbols for mercury (Hg) or lead (Pb) are added if the battery contains more than 0.0005% mercury or 0.004% lead. By ensuring these batteries are disposed of correctly, you will help prevent potentially negative consequences for the environment and human health which could otherwise be caused by inappropriate waste handling of the battery. The recycling of the materials will help to conserve natural resources.

In case of products that for safety, performance or data integrity reasons require a permanent connection with an incorporated battery, this battery should be replaced by qualified service staff only.

To ensure that the battery will be treated properly, hand over the product at end-of-life to the applicable collection point for the recycling of electrical and electronic equipment.

For all other batteries, please view the section on how to remove the battery from the product safely. Hand the battery over to the applicable collection point for the recycling of waste batteries.

For more detailed information about recycling of this product or battery, please contact your local Civic Office, your household waste disposal service or the shop where you purchased the product.

If you have any questions or problems concerning your unit, please consult your nearest Sony dealer.

## Troubleshooting

Should any problem persist after you have made the following checks, consult your nearest Sony dealer.

**The clock flashes "AM12:00" due to a power interruption.**

- The battery is low. Replace the battery. Remove the old battery and install a new one.

**The radio, iPod or buzzer alarm does not sound at the preset alarm time.**

- Check that alarm "A" or alarm "B" is properly displayed.

**The radio or alarm of iPod is activated but no sound comes on at the preset alarm time.**

- Check the alarm volume setting.

**There is no sound from the iPod.**

- Make sure the iPod is securely connected.
- Adjust the **VOLUME**.

**The iPod cannot be operated with this unit.**

- Make sure the iPod is securely connected.

**The iPod cannot be charged.**

- Make sure the iPod is securely connected.

**When daylight saving time begins, the clock does not employ the daylight saving time automatically.**

- Make sure the clock is set correctly.
- Press and hold **CLOCK** and **SNOOZE/DATE/SLEEP OFF** simultaneously for at least 2 seconds to activate the Automatic DST function.

## Specifications

### Section for iPod

DC out: 5V

MAX: 500mA

### Radio section

#### Frequency range

Band	Frequency	Channel step
FM	87.5 MHz – 108 MHz	0.05 MHz
AM	531 kHz – 1 602 kHz	9 kHz

### General

#### Speaker

Approx. 3.8 cm (1 1/2 inches) dia. 8 Ω

#### Input

AUDIO IN jack (ø 3.5 mm stereo minijack)

#### Power output

0.8 W (at 10% harmonic distortion)

#### Power requirements

230 V AC, 50 Hz

For clock back up: 3V DC, one CR2032 battery

#### Dimensions

Approx. 115 mm × 124.7 mm × 97.1 mm (w/h/d) (4 7/16 inches × 4 15/16 inches × 3 7/8 inches) not including projecting parts and controls

#### Mass

Approx. 520 g (1 lb 2.3 oz) including power supply unit

#### Supplied accessories

Remote commander (1)

AM loop aerial (1)

Audio connecting cable (1)

Universal Dock Adapter for iPhone (1)

Universal Dock Adapter for iPhone 3GS & iPhone 3G (1)

Universal Dock Adapter for iPhone 4S & iPhone 4 (1)

Design and specifications are subject to change without notice.

## Compatible iPod/iPhone models

Compatible iPod/iPhone models are as follows. Update your iPod/iPhone to use the latest software before you use it.

iPod touch (4th generation)

iPod touch (3rd generation)

iPod touch (2nd generation)

iPod touch (1st generation)

iPod nano (6th generation)\*

iPod nano (5th generation)

iPod nano (4th generation)

iPod nano (3rd generation)

iPod nano (2nd generation)

iPod nano (1st generation)

iPod with video

iPod with color display

iPod with click wheel

iPod classic

iPod mini

iPhone 4S

iPhone 4

iPhone 3GS

iPhone 3G

iPhone

\* The iPod nano (6th generation) cannot be controlled by the remote when the command of "MENU," "▲," "◆," and "ENTER" is pressed.

### Notes

- In these Operating Instructions, "iPod" is used as a general reference to functions of iPod on an iPod or iPhone, unless otherwise specified by the text or illustrations.
- The connector of the unit is for sole use with an iPod. If you use devices that do not match with the connector, connect to the **AUDIO IN** terminal of this unit with the supplied audio connecting cable.
- Sony cannot accept responsibility in the event that data recorded to an iPod is lost or damaged when using an iPod connected to this unit.

## Connecting the aerial

### To connect the AM loop aerial

The shape and the length of the aerial is designed to receive AM signals. Do not dismantle or roll up the aerial.

- 1 Remove only the loop part from the plastic stand.
- 2 Set up the AM loop aerial.

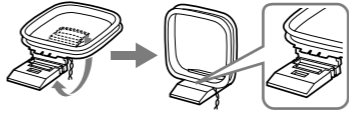

- 3 Connect the cords to the AM aerial terminals.

Cord (A) or cord (B) can be connected to either terminal.

**Insert the cord while pushing down the terminal clamp.**

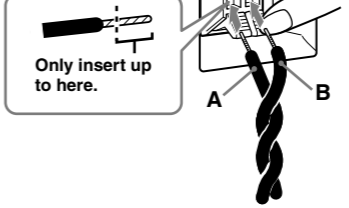

- 4 Make sure the AM loop aerial is connected firmly by pulling softly.

### Adjusting the AM loop aerial

Find a place and an orientation that provide good reception.

- Do not place the AM loop aerial near the unit or other AV equipment, as noise may result.

### Tip

Adjust the direction of the AM loop aerial for best AM broadcast sound.

## Preparing the remote commander

Before using the card remote commander for the first time, remove the insulation film.

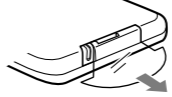

### When to replace the battery

With normal use, the battery (CR2025) should last for about six months. When the remote commander no longer operates the unit, replace the battery with a new one.

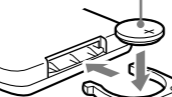
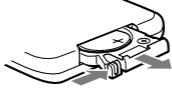

### Notes

- Do not attempt to charge the battery.
- If you are not going to use the remote commander for a long time, remove the battery to avoid any damage that may be caused by leakage and corrosion.

## About the backup battery

To keep accurate time, this unit contains a CR2032 battery inside of the unit as a backup power source.

The battery keeps the clock operating in the event of a power interruption.

### Note for customers in the UK

The clock is preset at the factory, and its memory is powered by the preinstalled Sony CR2032 battery. If the "AM 12:00" appears in the display when the unit is connected to AC outlet for the first time, the battery may be weak. In this case, consult a Sony dealer. The preinstalled CR2032 battery is considered part of the product, and is covered by the warranty.

You are required to show "Note for customers in the UK" (in this instruction) to a Sony dealer in order to validate the warranty for this product.

### Knowing when to replace the battery

When the battery becomes weak, "⏰" appears in the display.

If a power interruption occurs while the battery is weak, the current time and alarm will be erased. Replace the battery with a Sony CR2032 lithium battery. Use of another battery may cause a fire or explosion.

### Replacing the battery

- 1 Keep the AC plug connected to the AC outlet, remove the screw that secures the battery holder at the bottom of the unit using a screwdriver, and remove the battery holder.
- 2 Replace a new battery in the battery holder with the side facing up.
- 3 Insert the battery holder back into the unit and secure it with the screw.
- 4 Press **iPod & iPhone ►II, RADIO BAND, AUDIO IN** or **SNOOZE/DATE/SLEEP OFF** to turn "⏰" off in the display.

### Note

When you replace the battery, do not disconnect the plug from the AC outlet. Otherwise, the calendar, current time, alarm and station presets will be erased.

①

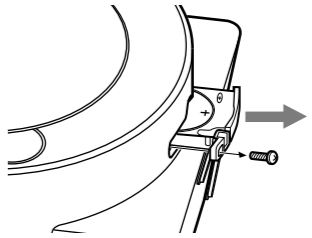

②

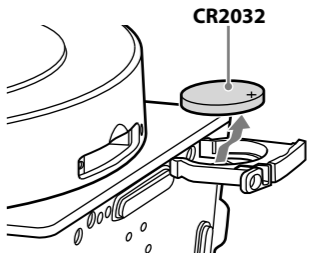

③

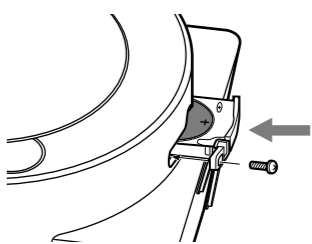

### If the time in the display is incorrect after the battery is changed (Reset)

Press the Reset button with a pointed device. The Reset button is in the small hole located near the battery holder.

