

Portable MiniDisc Player

Operating instructions
Mode d'emploi



Printed on 100% recycled paper using VOC (Volatile Organic Compound)-free vegetable oil based ink.

Sony Corporation © 2001 Printed in Japan

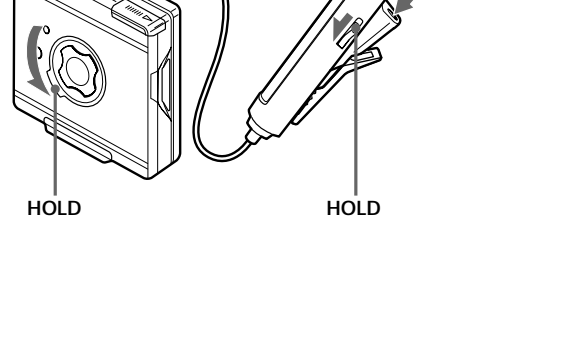
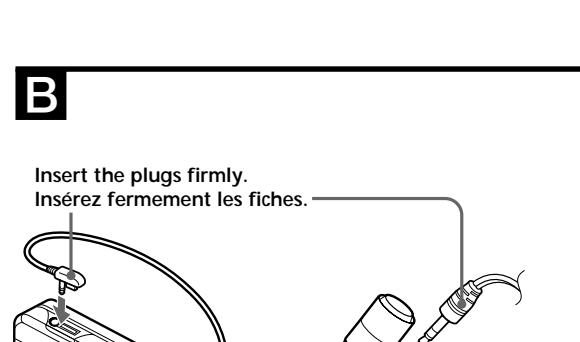
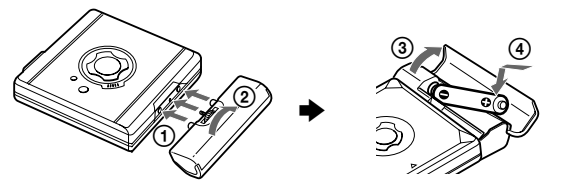
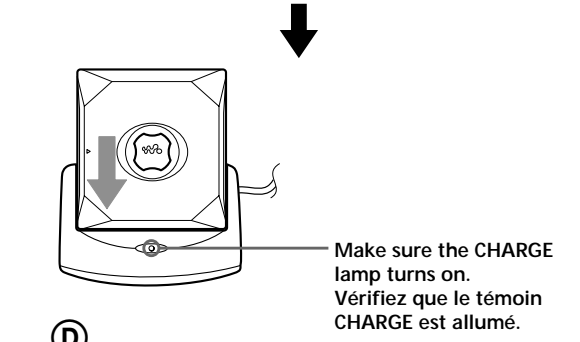
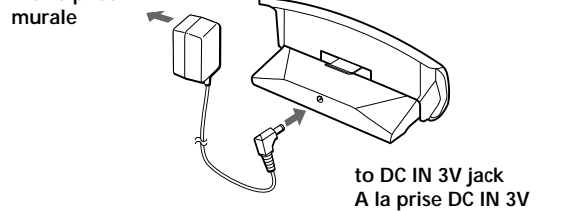
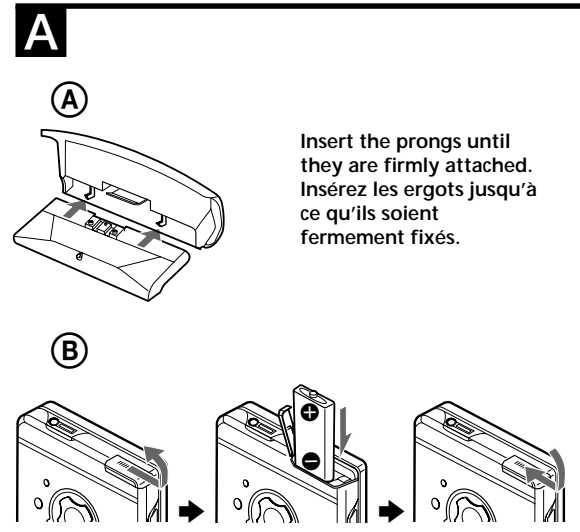

A

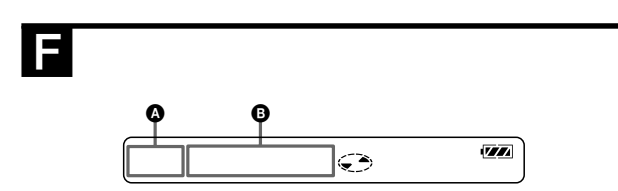
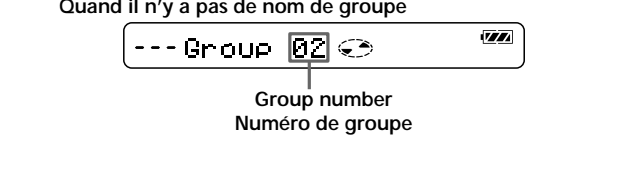
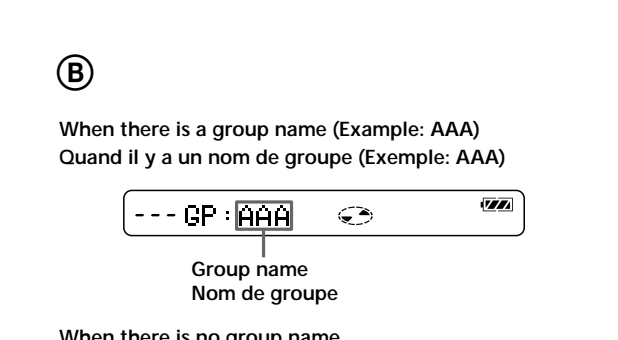
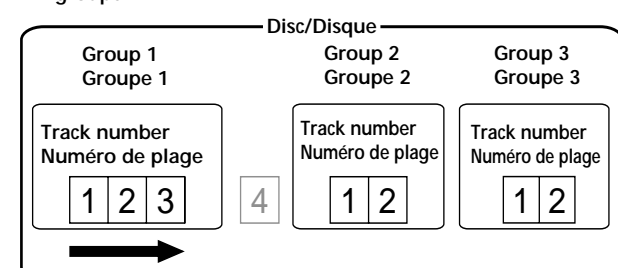
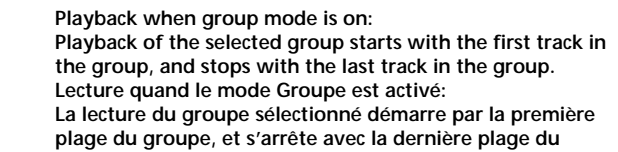
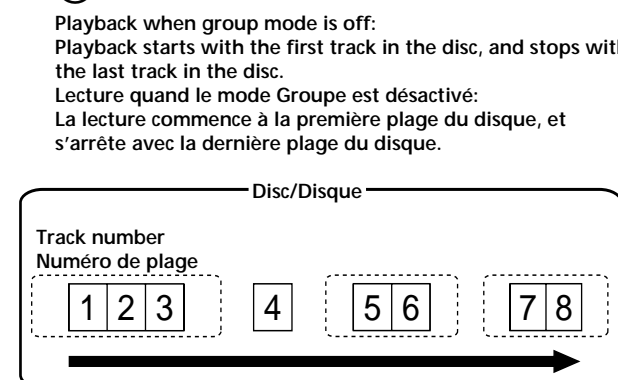
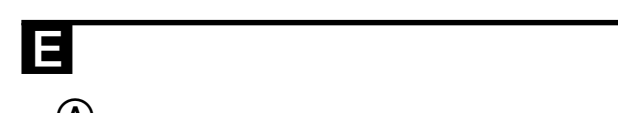
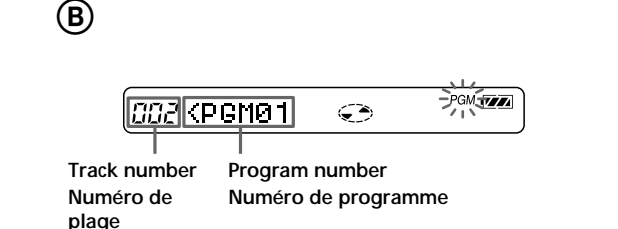
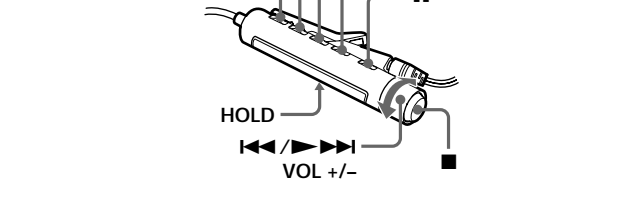
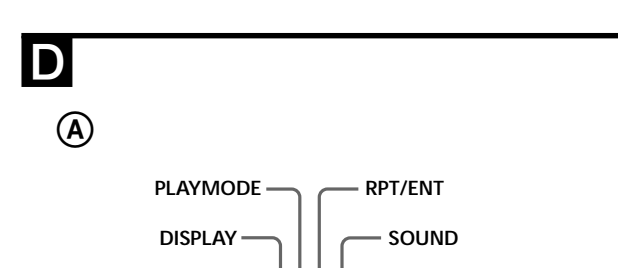
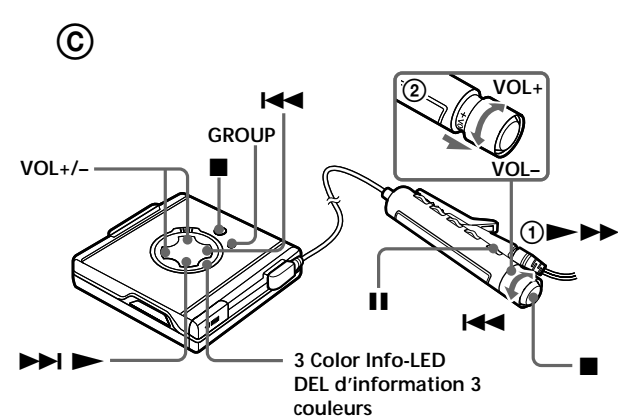
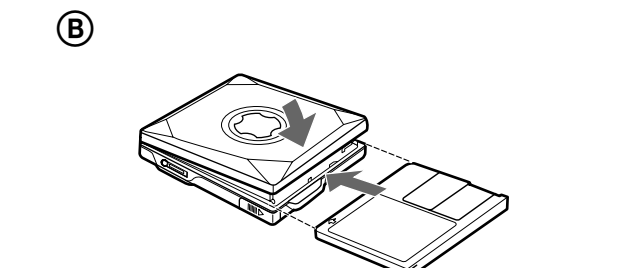
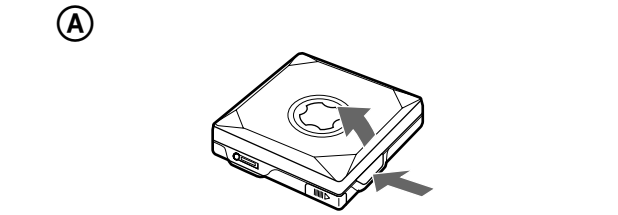

English

WARNING

To prevent fire or shock hazard, do not expose the unit to rain or moisture.

Do not install the appliance in a confined space, such as a bookcase or built-in cabinet.

To prevent fire, do not cover the ventilation of the apparatus with news papers, table cloths, curtains, etc. And don't place lighted candles on the apparatus.

To prevent fire or shock hazard, do not place objects filled with liquids, such as vases, on the apparatus.

Certain countries may regulate disposal of the battery used to power this product. Please consult with your local authority. CAUTION — INVISIBLE LASER RADIATION WHEN OPEN DO NOT STARE INTO BEAM OR VIEW DIRECTLY WITH OPTICAL INSTRUMENTS

Information

IN NO EVENT SHALL SELLER BE LIABLE FOR ANY DIRECT, INCIDENTAL OR CONSEQUENTIAL DAMAGES OF ANY NATURE, OR LOSSES OR EXPENSES RESULTING FROM ANY DEFECTIVE PRODUCT OR THE USE OF ANY PRODUCT.

Getting started

Preparing a power source

Using the rechargeable battery

Charge the supplied rechargeable battery before using it for the first time. Assemble the battery charging stand as shown in Fig. A ④.

- 1 Insert the supplied rechargeable battery NH-14WM into the rechargeable battery compartment with correct polarity (see Fig. A ④).
- 2 Connect the supplied AC power adaptor to the battery charging stand and plug the AC power adaptor into an electrical outlet (see Fig. A ③).
- 3 Place the player on the battery charging stand. The CHARGE lamp will light up. Full charging takes about 6 hours. The CHARGE lamp will go off when charging is complete (see Fig. A ③).

- 1 Do not operate the player when you place it on the battery charging stand or during charging. If you do so, it may cause the player to malfunction or prevent the battery from charging.
- The supplied battery charging stand is for use with the NH-14WM only. It cannot be used with the NC-6WM.

Using a dry battery (see Fig. A-③)

Attach the supplied battery case to the player, and then insert one LR6 (size AA) battery with correct polarity. Be sure to insert the minus (-) terminal of the battery first.

When to replace or recharge the battery

You can check the battery condition with the battery indication on the remote control and the 3 Color Info-LED on the player while using the player.

- Battery power decreasing
- Weak battery
- The battery has gone out. "LOW BATT" flashes in the display on the remote control, and the power goes off.

- The LED lights up. There is sufficient battery power.
- The LED flashes slowly. Battery power decreasing
- The LED flashes quickly. The battery is low. Soon, the LED will turn off and the supply of power will stop.

- Notes
- The battery indication may show the battery to be fully charged even when it is not. Charging the battery shorter than the prescribed time will result in a shorter operating time on the player.
- The battery indication will show a low charge during a forward or backward operation when the operating temperature is extremely low.

Battery life Batteries	(Unit: Approx. hours) (JEITA*)		
	SP Stereo (normal)	LP2 Stereo	LP4 Stereo
Ni-MH rechargeable battery NH-14WM (A) ¹⁾	29	33	37
LR6 (SG) Sony Alkaline dry battery ²⁾	43	51	60
LR6 (SG) ³⁾ and NH-14WM (A) ³⁾	76	87	100

- ¹⁾ Measured in accordance with the JEITA (Japan Electronics and Information Technology Industries Association) standard (using a Sony MDW-series Mini-disc).
 - ²⁾ With a fully charged battery
 - ³⁾ When using a Sony LR6 (SG) "STAMINA" alkaline dry battery (produced in Japan).
- Note
The battery performance may be shorter than the specified duration, depending on the operating conditions, the temperature of the location, and the type of battery being used.

Connecting the headphones/earphones (see Fig.B)

Connect the supplied headphones/earphones to the remote control. Connect the remote control to the jack on the player. Slide HOLD on the remote control and the player to the directions of the arrows shown in the illustration.

MD playing

Playing an MD (see Fig.C)

- 1 Insert an MD.
 - ① Press OPEN (see Fig. C ④).
 - ② Insert the MD with the label side facing up, and press the lid down to close (see Fig. C ④).
- 2 Play the MD (see Fig. C ④).
 - ① Turn the control towards ►►► on the remote control (or press ►►► on the player).
 - ② Pull and turn VOL +/- on the remote control (or press VOL +/- on the player) to adjust the volume. The volume indicator will appear on the remote control, allowing you to check the volume level. After you adjust the volume, push back the control.

F

When there is a group name (Example: AAA)
Quand il y a un nom de groupe (Exemple: AAA)

When there is no group name
Quand il n'y a pas de nom de groupe

About the 3 Color Info-LED on the player

The 3 Color Info-LED indicates the current operating status by the lighting up in the following colors:

LED color	Operating status
Red	Normal play (The LED lights up continuously)
Green	Group mode* (The LED lights up continuously)
Orange	Group skip mode* (The LED lights for about 5 seconds)

* For more details, see "Using the Group Function."
When the battery is exhausted, the LED flashes. For more details, see "When to recharge or replace the battery."

Other disc operation

To this (Beeps*) in the headphones/earphones when the remote control is operated)
Pause Press II on the remote control (Continuous short beeps). Press II on the remote control again to resume playback.²⁾

Find the beginning of the current track / the beginning of the previous track Turn the control towards ◀◀◀ on the remote control once (Three short beeps). (Or press ◀◀◀ on the player once.) Turn the control towards ◀◀◀ on the remote control repeatedly. (Continuous three short beeps). (Or press ◀◀◀ on the player repeatedly.)

Find the beginning of the next track Turn the control towards ►►► on the remote control (Two short beeps). Press ►►► on the player once.

Go backwards while playing²⁾ Turn and hold the control towards ◀◀◀ on the remote control. Hold down ◀◀◀ on the player.

Go forward while playing²⁾ Turn and hold the control towards ►►► on the remote control. Hold down ►►► on the player.

Remove the MD Press ■, and then press OPEN.³⁾

- ¹⁾ You can turn off the beep sound. For more details, see "Turning off the beep sound."
- ²⁾ When you press ◀◀◀ or ►►► on the player during pause, the player resumes playback. If you turn and hold the control towards ◀◀◀ or ►►► on the remote control (or hold down ◀◀◀ or ►►► on the player) during pause, you can fast forward/rewind without listening to the playback sound.
- ³⁾ Once you open the lid, the point to start playback changes to the beginning of the first track.

About the G-PROTECTION function

The G-PROTECTION function has been developed to provide excellent protection against sound skipping during many active uses. This function provides a higher level of shock protection during playback than the traditional one.

Tips

- The player can play the track recorded by 2 × or 4 × long playing mode (LP2 or LP4). Normal stereo playback, LP2 stereo playback, LP4 stereo playback or monaural playback is automatically selected to match the audio source.
- During the operation of the unit, the 3 Color Info-LED on the player turns on. After you press ■ to stop the playback, the 3 Color Info-LED turns off.
- The display on the remote control will turn off shortly after you press ■.

- When removing the disc, make sure to press ■ first, and then press OPEN.
- Sound may skip if:
 - the player receives stronger continuous shock than expected.
 - a dirty or scratched MiniDisc is played.

Various ways of playback

Selecting the play mode (see Fig.D)

You can select from various play modes using PLAYMODE and RPT/ENT on the remote control.

1 Press PLAYMODE repeatedly to select one of the four play modes, as follows:

Play mode display	Playback status
(none) (normal play)	All the tracks are played once.
"T" (single play)	A single track is played once.
"SHUF" (shuffle play)	All the tracks are played in random order.
"PGM" (program play)	Tracks are played in the order that you specified.

Listening to tracks in a desired sequence (Program Play)

- 1 During playback, press PLAYMODE on the remote control repeatedly until "PGM" flashes in the display.
- 2 Turn the control on the remote control repeatedly to select a track number (see Fig. D ②).
- 3 Press RPT/ENT on the remote control. The track is entered.
- 4 Repeat steps 2 and 3 to select other tracks in the desired sequence.
- 5 Press RPT/ENT for 2 seconds or more. The settings are entered and playback starts from the first programmed track.

- Notes
- All program settings are lost when the disc is removed from the player.
- If no settings are made for 5 minutes while the player is stopped, the settings made up to that point are entered.
- If you use the group function during program play, the program setting will be lost.

Repeat play

You can use this function to repeat playback in normal play, single play, shuffle play, or program play mode.

- 1 Press RPT/ENT on the remote control during playback. "C" appears in the display.

Using the group function (See Fig.E)

The MZ-E501 can be used with a disc which has group settings. The group function is useful for playing a great number of tracks, or tracks that have been recorded in MDLP (LP2/LP4) mode.

What is a disc with group settings?

This is a disc with settings that organize tracks into groups, and which allow those groups to be selected. The MZ-E501 does not support the recording of group settings. If your recorder has a function for editing disc names, you can use it to register groups.

Listening to tracks in a specific group (Group Mode Playback) (see Fig. E-④)

- 1 Insert a disc which has group settings into the player, and then play the disc.
- 2 Press DISPLAY on the remote control for 2 seconds or more.
- 3 Turn the control on the remote control repeatedly until "GROUP" flashes, and then press ■ on the remote control.
- 4 Turn the control on the remote control repeatedly until "GROUP ON" flashes, and then press ■ on the remote control. (Or on the player, press GROUP for 2 seconds or more.) "G" (group mode) appears in the display of the remote control and then group mode is turned on. The 3 Color Info-LED on the player lights up green. Playback stops at the end of the last track in the selected group. For details on selecting another group, see "Selecting and playing desired groups."

Tip
When group mode is on, it is possible to do repeat play, shuffle play, or program play. For details on the respective operations, see "Selecting the play mode."

To turn off group mode

Select "GROUP OFF" and press ■ in step 4. (Or on the player, hold down GROUP for 2 seconds or more.) The 3 Color Info-LED lights up red and group mode turns off.

- Notes
- Group mode is cancelled when the lid is opened.
- If you try to turn on group mode with a track that does not belong to any group, "Invalid GP" will flash in the display. If this happens, change to group skip mode and select a track that belongs to a group (see "Selecting and playing desired groups"). Then repeat step 2.
- If "NO GROUP" appears in the display on the remote control in step 4, it means that you are using a disc that has no group settings. Insert a disc with group settings and repeat step 1.
- If group mode is off and you try to play a disc that has group settings, the following text string may appear in the display.

Example:
① Favorites / 1-5:Rock / 1-6-9:Pop /

- ① Disc name "Favorites"
- ② Group name "Rock": registered tracks 1 to 5
- ③ Group name "Pop": registered tracks 6 to 9

Selecting and playing desired groups (Group Skip Function)

With a disc which has group settings, you can skip from the currently playing group to any other group on the MD.

- 1 Insert a disc which has group settings into the player and play the disc.
- 2 Hold down PLAYMODE on the remote control until "----" flashes in the display. (Or on the player, press GROUP.) The 3 Color Info-LED on the player lights up orange, and the player enters group skip mode.
- 3 While the LED lights up orange (for 5 seconds), turn the control on the remote control repeatedly until the name or number of the desired group appears (see Fig. E ②). During playback in group mode, playback of the selected group starts with the first track in the group and stops with the last track in the group. During normal playback, playback of the selected group starts with the first track in the group and stops with the last track on the disc.

Tip
The group skip function can be used at any time during playback, regardless of whether the player is in group mode or not.

- Notes
- If no operation is performed within 5 seconds after step 2, group skip mode is cancelled. To continue the procedure, start from step 1 again.
- Group skip mode cannot be used with a disc that has no group settings.

Other operations

knowing the track name and playing time (see Fig.F)

Press DISPLAY on the remote control. Each time you press DISPLAY, the display changes the indications as the follows (See Fig. F):

Track number	The elapsed time
Track number	Track name ¹⁾
The number of total tracks in the group	Group name ²⁾
The number of total tracks	Disc name ³⁾
Track number	Track mode ³⁾

- ¹⁾ Appears only with MDs that have been electronically labeled. "♫" appears when no track name is recorded, and "Ⓢ" appears when no disc name is recorded.
- ²⁾ Appears only when the group function is on. If a group has no name, the group number appears.
- ³⁾ The mode for each track is indicated as follows:
 - "Mode: SP" Standard mode (stereo)
 - "Mode: LP2" 2 × mode (2 × normal playing time)
 - "Mode: LP4" 4 × mode (4 × normal playing time)
 - "Mode: MONO" Monaural

Tip
The group name appears when you select the group on group skip mode. For more details, see "Selecting and playing desired groups" in "Using the group function."

Remplacement ou recharge de la pile

Vous pouvez contrôler l'état de la pile à l'indication de pile sur la télécommande et à la DEL d'information 3 couleurs du lecteur pendant le fonctionnement du lecteur.

- Capacité de la pile diminuant
- Pile affaiblie
- Pile épuisée. "LOW BATT" clignote sur l'affichage de la télécommande, et l'alimentation est coupée.

Indication de la DEL d'information 3 couleurs du lecteur
La DEL s'allume. Capacité suffisante de la pile
La DEL clignote lentement. Capacité de la pile diminuant
La DEL clignote rapidement. Pile affaiblie. La DEL s'éteindra sous peu et l'alimentation sera coupée.

Remarques

- L'indication de pile peut indiquer que la pile est entièrement chargée même si elle n'est pas. Une charge de la pile plus courte que le temps prescrit peut résulter en un temps de fonctionnement plus court du lecteur.
- L'indication de pile indiquera une charge faible pendant la marche en avant ou en arrière quand la température de fonctionnement est extrêmement basse.

Vie de service de la pile (Unité : env. heures) (JEITA*)

Pile	(Unité : env. heures) (JEITA*)		
	SP stéréo (normal)	LP2 stéréo	LP4 stéréo
Pile rechargeable Ni-MH NH-14WM (A) ¹⁾	29	33	37
Pile alcaline sèche Sony LR6 (SG) ²⁾	43	51	60
LR6 (SG) ³⁾ et NH-14WM (A) ³⁾	76	87	100

- ¹⁾ Mesure conformément aux normes JEITA (Japan Electronics and Information Technology Industries Association) (avec un MiniDisc de série MDW Sony).
- ²⁾ Avec une pile entièrement chargée.
- ³⁾ Avec une pile sèche "STAMINA" LR6 (SG) Sony (fabriquée au Japon).

Remarque

Le fonctionnement de la pile peut être plus court que celui spécifié, selon les conditions de fonctionnement, la température sur place et le type de pile utilisé.

Français

AVERTISSEMENT

Pour prévenir tout risque d'incendie ou d'électrocution, gardez cet appareil à l'abri de la pluie ou de l'humidité.

N'installez pas l'appareil dans un espace confiné comme dans une bibliothèque ou un meuble encastré.

Pour prévenir tout risque d'incendie, n'obstruez pas orifices de ventilation de l'appareil avec des journaux, nappes, rideaux, etc. et ne placez pas de bougies allumées sur l'appareil.

Pour prévenir tout risque d'incendie ou d'électrocution, ne placez pas d'objets remplis de liquides (p. ex. un vase) sur l'appareil.

Certains pays réglementent la mise au rebut des piles utilisées pour alimenter le produit. Veuillez consulter les autorités locales.

ATTENTION — ÉMISSION DE RAYON LASER INVISIBLE SI L'APPAREIL EST OUVERT
NE PAS REGARDER FIXEMENT LE RAYON OU LE REGARDER AVEC UN INSTRUMENT OPTIQUE.

A pleine puissance, l'écoute prolongée du baladeur peut endommager l'oreille de l'utilisateur.

EN AUCUN CAS, LE VENDEUR NE POURRA ÊTRE TENU RESPONSABLE DE TOUT DOMMAGE DIRECT OU INDIRECT DE QUELQUE NATURE QUE CE SOIT, OU DE TOUTE PERTE OU DEPENSE RESULTANT D'UN PRODUIT DEFECTUEUX OU DE L'UTILISATION DE TOUT PRODUIT.

Démarrage

Emploi de la pile rechargeable

Chargez la pile rechargeable fournie avant de l'utiliser pour la première fois. Assemblez le support de charge de pile comme indiqué sur la Fig. A ④.

- 1 Insérez la pile rechargeable NH-14WM dans le logement de pile rechargeable en respectant les polarités (voir Fig. A ④).
- 2 Raccordez l'adaptateur secteur fourni au support de charge de pile et branchez l'adaptateur secteur dans une prise murale (voir Fig. A ③).
- 3 Placez le lecteur sur le support de charge de pile. Le témoin CHARGE s'allume. La charge complète exige environ 6 heures. Le témoin CHARGE s'éteint quand la charge est terminée (voir la Fig. A ③).

- 1 Ne pas opérer le lecteur à son positionnement sur le support de charge de pile ou pendant la charge. Cela pourrait causer une anomalie de fonctionnement ou empêcher la charge de la pile.
- Le support de charge de pile fourni est prévu uniquement pour la pile NH-14WM. Il ne peut pas être utilisé avec la NC-6WM.

Utilisation d'une pile sèche (voir la Fig. A-③)

Fixez le boîtier à pile sèche au lecteur, puis insérez une pile sèche alcaline LR6 (format AA) en respectant les polarités. Insérez bien le bout ◯ de la pile en premier.

Remplacement ou recharge de la pile

Vous pouvez contrôler l'état de la pile à l'indication de pile sur la télécommande et à la DEL d'information 3 couleurs du lecteur pendant le fonctionnement du lecteur.

- Capacité de la pile diminuant
- Pile affaiblie
- Pile épuisée. "LOW BATT" clignote sur l'affichage de la télécommande, et l'alimentation est coupée.

Indication de la DEL d'information 3 couleurs du lecteur
La DEL s'allume. Capacité suffisante de la pile
La DEL clignote lentement. Capacité de la pile diminuant
La DEL clignote rapidement. Pile affaiblie. La DEL s'éteindra sous peu et l'alimentation sera coupée.

Remarques

- L'indication de pile peut indiquer que la pile est entièrement chargée même si elle n'est pas. Une charge de la pile plus courte que le temps prescrit peut résulter en un temps de fonctionnement plus court du lecteur.
- L'indication de pile indiquera une charge faible pendant la marche en avant ou en arrière quand la température de fonctionnement est extrêmement basse.

Vie de service de la pile (Unité : env. heures) (JEITA*)

Pile	(Unité : env. heures) (JEITA*)		
	SP stéréo (normal)	LP2 stéréo	LP4 stéréo
Pile rechargeable Ni-MH NH-14WM (A) ¹⁾	29	33	37
Pile alcaline sèche Sony LR6 (SG) ²⁾	43	51	60
LR6 (SG) ³⁾ et NH-14WM (A) ³⁾	76	87	

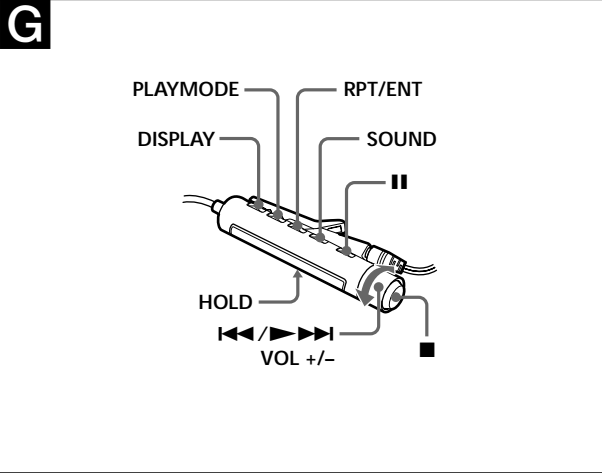

English

Adjusting the sound quality (Digital Sound Preset) (See Fig. G, H)

You can make adjustments to the sound quality to suit your taste, and then store two sets of these adjustments.

- Press SOUND on the remote control repeatedly to select "SOUND1" or "SOUND2". (see Fig. H, G)
- During playback, press SOUND on the remote control for 2 seconds or more (see Fig. G, H).
The player changes to the bass-setting mode. Pressing SOUND for 2 seconds again changes the player to the treble-setting mode.
- Turn the control on the remote control repeatedly to adjust the bass or the treble (see Fig. H, G).
When you press SOUND for more than 2 seconds while adjusting the bass, the display switches to the treble (or vice-versa).
When you press SOUND for a short time while adjusting the bass or the treble, the setting for that sound is entered and the display switches to the other sound setting.
- Press RPT/ENT on the remote control.
The sound settings are stored and the playback display appears again.

To select a preset sound

Press SOUND on the remote control repeatedly to select "SOUND1" or "SOUND2".
Selecting no display turns off the digital sound preset function.

Digital sound preset factory settings

The digital sound preset factory settings are as follows:

- "SOUND1": bass +1, treble ±0
- "SOUND2": bass +3, treble ±0

Tip

You can also set the digital sound preset when playback is momentarily paused.

- Settings cannot be changed through the operation buttons on the player.
- When you use the digital sound preset function, the sound may become distorted depending on the settings or the track. In this case, change the settings of the sound quality.

Protecting your hearing (AVLS) (See Fig. G, H)

AVLS (Automatic Volume Limiter system) function keeps down the maximum volume to protect your ears.

- During playback, press DISPLAY on the remote control for 2 seconds or more.
- Turn the control on the remote control repeatedly until "AVLS" flashes in the display and press ■ on the remote control.
- Turn the control on the remote control repeatedly until "AVLS ON" flashes in the display and press ■ on the remote control.
"AVLS ON" appears in the display.

To set the AVLS function on the player
During playback, slide HOLD towards ▶ and then while pressing VOL ←, slide HOLD in the opposite direction.

To cancel the AVLS function
On the remote control, select "AVLS OFF" and press ■ on the remote control in step 3. Or on the player, during playback, slide ▶ HOLD in the direction of ▶ and then while pressing VOL ←, slide HOLD in the opposite direction.

Turning off the beep sound (See Fig. G)

You can turn off the beep sound in the headphones/earphones.

- Press DISPLAY on the remote control for 2 seconds or more.
- Turn the control on the remote control repeatedly until "BEEP" flashes in the display, and then press ■ on the remote control.
- Turn the control repeatedly until "BEEP OFF" flashes in the display, and then press ■ on the remote control.

To turn on the beep sound
Select "BEEP ON" and press ■ on the remote control in step 3.

Locking the controls (HOLD) (See Fig. I)

- Slide HOLD on the remote control in the direction of the ▶ to lock the controls on the remote control and slide HOLD on the player in the direction of the ▶ to lock the controls of the player.

To unlock the controls
Slide HOLD to the opposite directions of the arrows.

►Additional information

Precautions

On safety

- Make sure to keep the player in the supplied carrying pouch. If the terminals on the player, battery charging stand, or battery case are accidentally brought into contact with a metallic object, they may short-circuit and begin to heat up.
- Keep the terminals on the player or on the battery case away from metallic objects or surfaces. Such contact may short-circuit the terminals and cause dangerous heat generation. When carrying the player with you, always keep the battery case attached to the player and the player in the supplied carrying pouch.
- When you carry the supplied rechargeable battery, be sure to put it in the supplied rechargeable battery carrying case. Carrying the rechargeable battery without the case may cause a short-circuit with metallic objects such as coins, key rings, or necklaces. As a result, heat may be generated.
- Do not put any foreign objects in the DC IN 3V jack.
- Do not carry or store the dry battery or battery case in the same place with metallic objects such as coins, key rings, or necklaces. This may cause a short-circuit to occur and heat to generate.
- Incorrect battery usage may lead to leakage of battery fluid or bursting batteries. To prevent such accidents, observe the following precautions:
 - Install batteries with the + and - poles aligned correctly.
 - Do not charge dry batteries.
 - If a battery leak should develop, carefully and thoroughly wipe away battery fluid from the battery compartment before inserting new one.
 - If you are not going to use this player for a long time, be sure to disconnect the power supply (AC power adaptor, dry battery, rechargeable battery, or battery charging stand). To remove the AC power adaptor from the electrical outlet, grasp the adaptor plug itself; never pull the cord.

On the AC power adaptor (for the supplied battery charging stand)

- For use in your house: Use the supplied AC power adaptor AC-E30HG. Do not use any other AC power adaptor since it may cause the player to malfunction.
- Position the player within easy reach of the electrical outlet. Should you notice an abnormality in the player, disconnect the AC power adaptor from the electrical outlet immediately.

On charging

- The supplied battery charging stand can be used only with the MZ-E501. It cannot be used to charge all other models.
- Do not use the MZ-E501 to charge any other battery besides the one designated for it.
- Though the battery charging stand and the battery may become hot during the charging procedure, this poses no danger.
- Because of the battery's character, the capacity of the battery may be smaller than normal when it is used for the first time or after a long period of disuse. In this case, charge and discharge the battery several times. The normal battery life will be restored.
- If the capacity of the rechargeable battery becomes half the normal life, replace it with a new one.
- As soon as charging is complete, remove the player from the battery charging stand and disconnect the battery charging stand from the electrical outlet. Leaving it connected may result in reduced battery performance.
- The CHARGE lamp will go off about 6 hours after you place the player on the battery charging stand. If you remove the player from the battery charging stand for 3 seconds or more while it is charging, the CHARGE lamp will go off and it will take about 6 hours for the lamp to go on from the next time you place the player on the battery charging stand.

On Handling

- Do not drop or bump the player. This may cause the player to malfunction.
- Do not pull on the remote control or headphones/earphones cords.
- Do not place the player in the following places:
 - An extremely hot place (over 60°C (140°F))
 - A place exposed to direct sunlight or near a heater
 - In a car with the windows rolled up (especially in the summer)
 - In a damp place such as a bathroom
 - Near a source of electromagnetic fields such as a magnet, speaker, or TV
 - In a dusty place

On heat build-up

Heat may build up in the player if it is used for an extended period of time. This, however, is not a malfunction.

On mechanical noise

The player gives out mechanical noise while operating, which is caused by the power-saving system of the player. This is not a malfunction.

On installation

- Never use the player where it will be subjected to extremes of light, temperature, moisture or vibration.
- Never wrap the player in anything when it is being used with the AC power adaptor. Heat build-up in the player may cause malfunction or injury.

On the remote control

The supplied remote control is designed for use with the MZ-E501 only. Note also that the player cannot be controlled by remote controls for other models.

On the MiniDisc cartridge

- Do not touch the internal disc directly. Forcing the shutter open may damage the internal disc.
- When transporting a MiniDisc, keep it in its case.
- Do not place the cartridge where it will be subjected to light, temperature, moisture or dust.
- Do not affix the label outside of the specified area on the MD. Make sure the label is placed within the recessed space on the disc.

On the headphones/earphones

Road safety

- Do not use headphones/earphones while driving, cycling, or operating any motorized vehicle. It may create a traffic hazard and is illegal in many areas. It can also be potentially dangerous to play your player at high volume while walking, especially at pedestrian crossings. You should exercise extreme caution or discontinue use in potentially hazardous situations.
- If you experience an allergic reaction to the supplied headphones/earphones, stop using them at once and consult a doctor or a Sony service center.

Preventing hearing damage

Avoid using headphones/earphones at high volume. Hearing experts advise against continuous, loud and extended play. If you experience a ringing in your ears, reduce the volume or discontinue use.

Caring for others

Keep the volume at a moderate level. This will allow you to hear outside sounds and to be considerate of the people around you.

On the battery case

The supplied battery case is designed for use with the MZ-E501 only.

On cleaning

- After wiping the player casing with a soft cloth slightly moistened with water, wipe it again with a dry cloth. Do not use any type of abrasive pad, scouring powder or solvent such as alcohol or benzene as it may mar the finish of the casing.
- Wipe the disc cartridge with a dry cloth to remove dirt.
- Dust on the lens may prevent the unit from operating properly. Be sure to close the disc compartment lid after inserting or ejecting an MD.
- A dirty plug may cause noise or intermittent breaks in the sound during playback. To maintain good sound quality, use a soft cloth to clean the plugs of the headphones/earphones and remote control.

On maintenance (see Fig. K)

If you have any questions or concerns concerning your player, please consult your nearest Sony dealer. If (a trouble occurred when the disc was in the player, we recommend that the disc be left in the player when you consult your Sony dealer so that the cause of trouble may be better understood.)

Troubleshooting

The player does not work or works poorly.

- You tried to play with no disc in the player ("NO DISC" flashes on the remote control).
 - Insert an MD.
- The hold function is activated and the controls are locked. (If you press any of the operation buttons on the player, "HOLD" flashes on the remote control.)
 - Slide HOLD against the direction of the arrow to release the hold function.
- When the remote control is enabled for the making settings ("MENU" appears on the remote control when the buttons on the player are pressed.)
 - End the procedure for making settings using the remote control or disconnect the remote control plug.
- Moisture has condensed inside the player.
 - Take the MD out and wait for several hours until the moisture evaporates.
- The rechargeable battery or dry battery is weak ("LOW BATT" flashes on the remote control).
 - Replace a new dry battery or recharge the battery.
- The rechargeable battery or dry battery has been installed incorrectly.
 - Install the battery with correct polarity.
- An MD with no recording on it is inserted ("BLANKDISC" flashes on the remote control).
 - Insert a recorded MD.
- The player cannot read the disc. (It's scratched or dirty) ("DISC ERR" flashes on the remote control.)
 - Reinsert or replace the disc.
- While operating, the player received a mechanical shock, too much static, abnormal power voltage caused by lightning etc.
 - Restart as follows:
 - Disconnect all the power sources.
 - Leave the player for about 30 seconds.
 - Connect the power source.

The MD does not play normally.

- The player is set to repeat mode. ("C" is displayed on the remote control.)
 - Press PLAYMODE repeatedly until "C" disappears, then start playing.
- The disc is playing in group mode.
 - Turn off group mode.

The digital sound preset function does not function.

- The digital sound preset function is off.
 - Press SOUND on the remote control repeatedly to select "SOUND1" or "SOUND2."

Playback sound skips.

- The player is placed where it receives continuous vibration.
 - Put the player on a stable place.
- A very short track may cause sound to skip.

Sound has a lot of static.

- Strong magnetism from a television or such device is interfering with operation.
 - Move the player away from the source of strong magnetism.

Momentary noise is heard.

- The sound was recorded in LP4 stereo mode.
 - Because of the nature of the compression method used in LP4 mode, noise may be heard on very rare occasions when playing back sound recorded in this mode.

The rechargeable battery does not start charging.

- The terminal of the battery charging stand is dirty.
 - Wipe the terminal with a dry cloth.
- The rechargeable battery is not inserted in the player. (When the player is on the battery charging stand, "NO BATT" appears on the remote control when you press one of the operation buttons on the player or the remote control in order to check the battery level.)
 - Insert the rechargeable battery into the player.

The CHARGE lamp does not turn on.

- The rechargeable battery is not inserted in the player.
 - Insert the rechargeable battery into the player.

The player does not operate properly.

- The player is operating while placed on the battery charging stand.
 - Remove the player from the battery charging stand.
- An attempt was made to enter group mode with program play selected.
 - Change to group mode before selecting program play.

No sound comes through the headphones/earphones.

- The headphones/earphones plug is not firmly connected.
 - Connect the headphones/earphones plug firmly to the remote control.
 - Connect the headphones/earphones plug firmly to the jack.
- AVLS is on.
 - Cancel the AVLS function. For more details, see "To cancel the AVLS function" in "Protecting your hearing."

The group function (group mode/group skip mode) does not function.

- An attempt was made to enter group mode while using a disc that has no group settings. ("NO GROUP" appears on the remote control.)
 - Use a disc with group settings.
- An attempt was made to enter group mode while playing a track that belongs to no group. ("Invalid GP" appears on the remote control.)
 - ◆ The group function cannot be used while a track that belongs to no groups is playing. Select the track that belongs to group using group skip mode. For more details, see "Selecting and playing desired groups."
- An attempt was made to enter group mode with program play selected.
 - Change to group mode before selecting program play.

Specifications

Audio playing system
MiniDisc digital audio system
Laser diode properties
Material: GaAlAs
Wavelength: λ = 790 nm
Emission duration: continuous
Laser output: less than 44.9 mW
* This output is the value measured at a distance of 200 mm from the objective lens surface on the optical pick-up block with 7 mm aperture.
Revolutions
Approx. 300 rpm to 2,700 rpm
Error correction
ACIRC (Advanced Cross Interleave Reed Solomon Code)
Sampling frequency
44.1 kHz
Coding
ATRAC (Adaptive Transform Acoustic Coding)
ATRAC3: LP2
ATRAC3: LP4
Modulation system
EFM (Eight to Fourteen Modulation)
Number of channels
2 stereo channels
1 monoaural channel
Frequency response
20 to 20,000 Hz ± 3 dB
Wow and Flutter
Below measurable limits
Outputs
Headphones/earphones: stereo mini-jack, maximum output level 5 mW + 5 mW, load impedance 16 Ω
Power requirements
Nickel metal hydride rechargeable battery
One NH-14WM (supplied); 1.2V, 1,350 mAh (MIN)
One LR6 (size AA) battery (not supplied)
External power jack (for the battery charging stand): Power rating 3V DC
Battery operation time
See "When to replace or recharge the battery"
Dimensions
Approx. 74.5 × 80.5 × 17.9 mm (w/h/d) (3 × 3 1/4 × 7/16 in.) (not including projecting parts and controls)
Mass
Approx. 80 g (2.8 oz) (the player only)
Supplied accessories
Headphones/earphones with a remote control (1)
Battery charging stand (assembly needed)(1)
AC power adaptor (1)
Rechargeable battery (1)
Rechargeable battery carrying case (1)
Dry battery case (1)
Carrying pouch (1)
AC plug adaptor (1) (world model only)
US and foreign patents licensed from Dolby Laboratories.

Design and specifications are subject to change without notice.

Optional accessories
NH-14WM Nickel metal hydride rechargeable battery
CPA-9C Car connecting pack
MDR series stereo headphones/earphones*
SRS series Active Speakers
Carrying pouch
* Whether you should plug the headphones/earphones directly to the jack on the main unit or to a remote control, use only headphones/earphones with stereo mini plugs. Headphones/earphones with a microplug cannot be used.
Your dealer may not handle some of the above listed accessories. Please ask the dealer for detailed information about the accessories in your country.

Français

Ajustement de la qualité sonore (Préréglage du son numérique) (Voir les Fig. G, H)

Vous pouvez ajuster la qualité sonore à vos préférences, et stocker deux lots de ces réglages.

- Appuyez plusieurs fois sur SOUND sur la télécommande pour sélectionner "SOUND1" ou "SOUND2" (voir la Fig. H, G)
- Pendant la lecture, appuyez plusieurs fois sur SOUND sur la télécommande au moins 2 secondes (voir la Fig. H, G).
Le lecteur passe en mode de réglage des graves. Une nouvelle pression de SOUND pendant 2 secondes fait passer le lecteur au mode de réglage des aigus.
- Tournez plusieurs fois la commande sur la télécommande pour ajuster les graves ou les aigus (voir la Fig. H, G).
Si vous appuyez sur SOUND plus de 2 secondes en ajustant les graves, l'affichage commute aux aigus (ou vice versa).
Si vous appuyez sur SOUND brièvement en ajustant les graves ou les aigus, le réglage pour ce son est entré et l'affichage commute à l'autre réglage du son.
- Appuyez sur RPT/ENT sur la télécommande.
Les réglages sonores sont stockés et l'affichage de lecture réapparaît.

Pour sélectionner un son préréglé
Appuyez plusieurs fois sur SOUND sur la télécommande pour sélectionner "SOUND1" ou "SOUND2".

La sélection de pas d'affichage désactive la fonction de préréglage du son numérique.

Préréglages usine du son numérique
Les préréglages usine du son numérique sont comme suit:

- "SOUND1": graves +1, aigus ±0
- "SOUND2": graves +3, aigus ±0

Conseil

Vous pouvez aussi régler un son numérique préréglé pendant une pause de lecture.

Remarques

- Les réglages ne sont pas modifiables aux touches d'opération du lecteur.
- A l'emploi de la fonction de préréglage de son numérique, le son peut être coupé ou déformé si le volume est réglé trop haut, selon les réglages ou la plage. Dans ce cas, modifiez les réglages de qualité du son.

Protection de l'ouïe (AVLS) (Voir les Fig. G, H)

La fonction AVLS (Automatic Volume Limiter System) maintient le volume maximum à un niveau modéré pour protéger votre ouïe.

- Pendant la lecture, appuyez sur DISPLAY sur la télécommande au moins 2 secondes.
- Tournez plusieurs fois la commande sur la télécommande jusqu'à ce que "AVLS" clignote sur l'affichage, puis appuyez sur ■ sur la télécommande.
- Tournez plusieurs fois la commande sur la télécommande jusqu'à ce que "AVLS ON" clignote sur l'affichage, puis appuyez sur ■ sur la télécommande.
"AVLS ON" s'affiche.

Pour régler la fonction AVLS sur le lecteur
Pendant la lecture, faites glisser HOLD vers ▶, puis en pressant VOL ←, faites glisser HOLD dans le sens opposé.

Pour annuler la fonction AVLS

Sur la télécommande, sélectionnez "AVLS OFF" et appuyez sur ■ sur la télécommande à l'étape 3. Ou sur le lecteur, pendant la lecture, faites glisser HOLD dans le sens de ▶, puis en appuyant sur VOL ←, faites glisser HOLD dans le sens opposé.

Désactivation de la tonalité bip (Voir la Fig. G)

Vous pouvez désactiver la tonalité bip dans le casque/écouteurs.

- Appuyez sur DISPLAY sur la télécommande au moins 2 secondes.
- Tournez plusieurs fois la commande sur la télécommande jusqu'à ce que "BEEP" clignote sur l'affichage, puis appuyez sur ■ sur la télécommande.
- Tournez plusieurs fois la commande sur la télécommande jusqu'à ce que "BEEP OFF" clignote sur l'affichage, puis appuyez sur ■ sur la télécommande.

Pour annuler le réglage

Sélectionnez "BEEP ON", puis appuyez sur ■ sur la télécommande à l'étape 3.

Verrouillage des commandes (HOLD) (Voir la Fig. I)

- Faites glisser HOLD sur la télécommande dans le sens de ▶ pour verrouiller les commandes de la télécommande et faites glisser HOLD dans le sens de ▶ pour verrouiller les commandes du lecteur.

Pour déverrouiller les commandes
Faites glisser HOLD dans le sens opposé aux flèches.

►Informations complémentaires

Précautions

Règles de sécurité

- Conservez bien le lecteur dans le sac de transport fourni. Si les prises du lecteur, le support de charge de la pile ou le boîtier à pile entrent accidentellement au contact d'un objet métallique, un court-circuit est possible et un échauffement peut commencer.
- Maintenez les prises sur le lecteur ou sur le boîtier à pile à l'écart des objets ou surfaces métalliques. Un tel contact pourrait court-circuiter les prises et provoquer une production de chaleur dangereuse. En portant le lecteur, maintenez toujours le boîtier à pile fixé au lecteur et le lecteur dans le sac de transport fourni.
- Au transport de la pile rechargeable fournie, placez-la dans le sac de transport pour pile rechargeable fourni. Sinon un court-circuit est possible en cas de contact avec des objets métalliques tels que pièces de monnaie, porte-clés ou colliers. Cela pourrait se traduire par une production de chaleur.
- Ne placez aucun objet étranger dans la prise DC IN 3V.
- Ne transportez pas et ne rangez pas la pile sèche ou le boîtier à pile avec des objets métalliques tels que pièces de monnaie, porte-clés ou colliers. Cela pourrait provoquer un court-circuit et une production de chaleur.
- Un emploi incorrect de la pile peut entraîner une fuite de liquide ou un éclatement de la pile. Respectez les précautions suivantes pour éviter de tels incidents:
 - Installez la pile en respectant les polarités + et -.
 - Ne chargez pas des piles sèches.
- En cas de fuite de pile, essayez soigneusement tout le liquide dans le logement de la pile avant d'en insérer une nouvelle.
- Si le lecteur doit rester inutilisé pendant une période prolongée, déconnectez le cordon d'alimentation (adaptateur secteur, pile sèche, pile rechargeable ou support de charge de pile). Séchez l'adaptateur secteur proprement dit pour le débrancher de la prise murale. Ne tirez pas sur le cordon.

Adaptateur secteur (pour le support de charge de pile fourni)

- Pour l'utilisation chez vous: Utilisez l'adaptateur secteur AC-E30HG fourni. N'utilisez aucun autre adaptateur secteur parce qu'il pourrait provoquer un mauvais fonctionnement du lecteur.



- Placez le lecteur à portée de la prise électrique. Si vous remarquez une anomalie, retirez le lecteur immédiatement l'adaptateur secteur de la prise électrique.

Charge

- Le support de charge de pile fourni est seulement utilisable avec le MZ-E501. Il ne peut être utilisé avec aucun autre modèle.
- N'utilisez pas le MZ-E501 pour charger d'autres piles que celles spécifiées pour lui.
- Le support de charge de pile et la pile peuvent chauffer pendant la charge, mais cela ne présente aucun risque.
- Vu les caractéristiques de la pile, sa capacité peut être inférieure à la normale quand elle est utilisée pour la première fois ou après une longue période de non-utilisation. Dans ce cas, chargez et déchargez la pile plusieurs fois. Son autonomie normale sera rétablie.
- Si la capacité de la pile rechargeable baisse à la moitié de la normale, remplacez-la par une neuve.
- Dès que la charge est terminée, retirez le lecteur du support de charge de pile et déconnectez le support de charge de pile de la prise électrique. Le laisser connecté pourrait réduire les performances de la pile.
- Le témoin CHARGE s'éteindra environ 6 heures après l'installation du lecteur sur le support de charge de pile. Si vous retirez le lecteur du support de charge de pile 3 secondes ou plus pendant la charge, le témoin CHARGE s'éteindra. Il faudra alors 6 heures pour que le témoin CHARGE s'éteigne à partir du moment où le lecteur est remis sur le support de charge de pile.

Manipulation

- Ne faites pas tomber et ne heurtez pas le lecteur. Cela pourrait provoquer un mauvais fonctionnement.
- Ne tirez pas sur la télécommande ou les cordons du casque/écouteurs.
- Ne placez pas le lecteur aux emplacements suivants.
 - Un endroit très chaud (plus de 60°C (140°F))
 - Un endroit exposé en plein soleil ou près d'un appareil de chauffage
 - Dans une voiture à fenêtres fermées (en particulier en été)
 - Au endroit humide, une salle de bains par exemple
 - Près d'une source de champ électromagnétique telle qu'aimant, encoche ou téléviseur.
 - Au endroit poussiéreux.

Concentration de chaleur

De la chaleur peut être concentrée sur le lecteur s'il est utilisé pendant une période prolongée. Il ne s'agit pas d'une anomalie.

Bruit mécanique

Le lecteur émet un bruit mécanique pendant le fonctionnement, dû à son système d'économie d'énergie. Il ne s'agit pas d'une anomalie.

Installation

- N'utilisez pas le lecteur à un endroit où il sera soumis à une lumière, des températures, une humidité ou des vibrations excessives.
- N'enveloppez jamais le lecteur dans quelque chose pendant son utilisation avec l'adaptateur secteur. La concentration de chaleur à l'intérieur pourrait causer un mauvais fonctionnement ou des blessures.

Télécommande

La télécommande fournie est conçue pour être utilisée uniquement avec le MZ-E501. Notez que le lecteur ne peut pas être contrôlé avec la télécommande d'autres modèles.

Cartouche de MiniDisc

- N touchez pas directement le disque à l'intérieur. Ouvrir de force le volet peut endommager le disque à l'intérieur.