

Digital Still Camera
Read This First

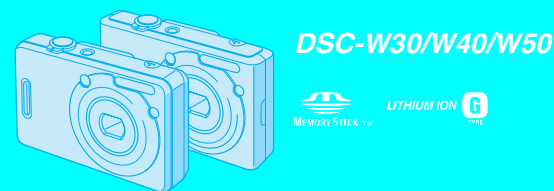

Operating Instructions
Before operating the unit, please read this manual and "User's Guide/Troubleshooting" (separate volume) thoroughly, and retain them for future reference.



Printed on 100% recycled paper using VOC (Volatile Organic Compound)-free vegetable oil based ink.

Checking the accessories supplied

- Battery charger BC-CSG (1)
- USB cable (1) (DSC-W30/W40)
- Power cord (mains lead) (1)
- Wrist strap (1) (DSC-W30/W50)
- Rechargeable battery pack NP-BG1 (1)/Battery case (1)
- Neck strap (1) (DSC-W40)
- Soft carrying case (1) (DSC-W40)
- USB, A/V cable for multi-use terminal (1) (DSC-W50)
- CD-ROM (Cyber-shot application software) (1)
- Operating instructions: "Read This First" (this manual) (1)
- Operating instructions: "User's Guide/Troubleshooting" (1)

A "Memory Stick Duo" is not supplied.

The camera has its own internal memory (32 MB), however, purchase of a "Memory Stick Duo" is recommended for shooting more images.

"Memory Stick Duo": you can use a "Memory Stick Duo" with your camera.



"Memory Stick": you cannot use a "Memory Stick" with your camera.



Other memory cards cannot be used.

For details on "Memory Stick Duo" → "User's Guide/Troubleshooting" (page 95)

Notes

- Charge the battery pack (supplied) before using the camera for the first time.
- The LCD screen is manufactured using extremely high-precision technology so over 99.99% of the pixels are operational for effective use. However, there may be some tiny black points and/or bright points (white, red, blue or green in color) that constantly appear on the LCD screen. These points are normal in the manufacturing process and do not affect the recording in any way.
- The camera is a precision instrument. Be careful not to bump the lens or the LCD screen, and not to apply force to it. Attach the strap to prevent the camera from damage by being dropped, etc.

Designed for use with compatible Sony batteries.

Additional information on this product and answers to frequently asked questions can be found at our Customer Support Website.

1 Prepare the battery pack

1 Insert the battery pack.

Push the battery pack gently until it clicks into place.

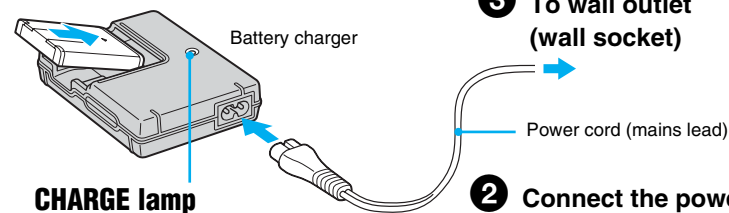

CHARGE lamp

Light on: Charging

Light off: Completed (Practical charge)

If you continue charging the battery pack for about one more hour (until it is fully charged), the charge will last slightly longer.

- Connect the battery charger to an easily accessible wall outlet (wall socket) close by.
- Even if the CHARGE lamp is not lit, the battery charger is not disconnected from the AC power source (mains) as long as it is connected to the wall outlet (wall socket). If some trouble occurs while using the battery charger, immediately shut off the power by disconnecting the plug from the wall outlet (wall socket).
- When charging is finished, disconnect the power cord (mains lead) from the wall outlet (wall socket), and remove the battery pack from the battery charger.
- The time required to fully charge the battery pack (supplied) from when it is completely discharged at a temperature of 25°C (77°F) is approximately 330 min., and the practical charging time is approximately 270 min. Charging may take longer under certain circumstances or conditions.

4 Insert the charged battery pack.

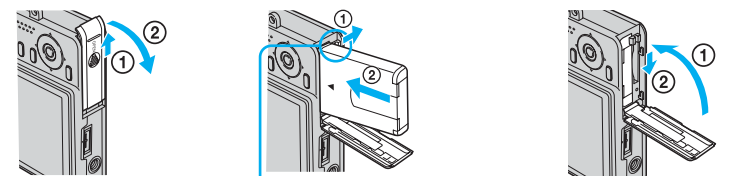

Open the battery/"Memory Stick Duo" cover. Insert the battery pack while pressing the battery eject lever with the tip of the battery. Close the battery/"Memory Stick Duo" cover.

2 Turn the camera on/set the clock

1 Select [CAM].



2 Press the POWER button.

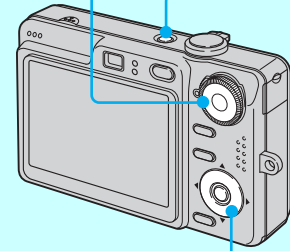
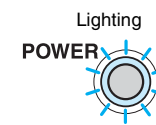

3 Set the clock with the control button.

1 Select the date display format with ▲/▼, then press ●.

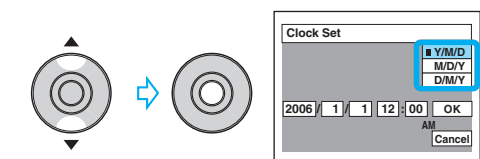

2 Select each item with ◀/▶ and set the numeric value with ▲/▼, then press ●.

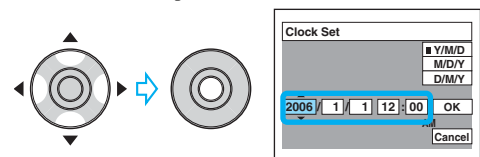

3 Select [OK] with ▶, then press ●.

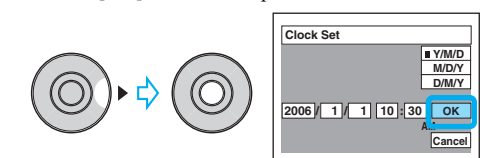

To cancel, select [Cancel] and press ●.

3 Insert a "Memory Stick Duo" (not supplied)

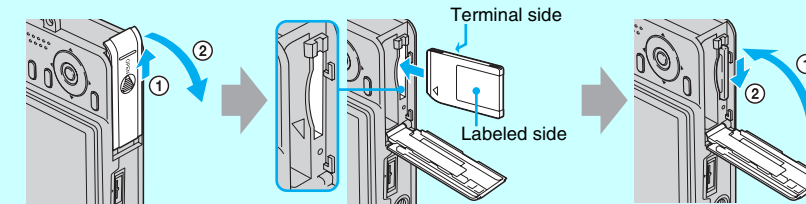

Insert the "Memory Stick Duo" all the way in until it clicks.

When there is no "Memory Stick Duo" inserted

The camera records/plays back images using the internal memory (32 MB). → "User's Guide/Troubleshooting" (page 26)

4 Select the image size for use

1 Select a mode.

Still image:



Movie:



2 Press [MENU]/[Image Size].

3 Select the size with ▲/▼.

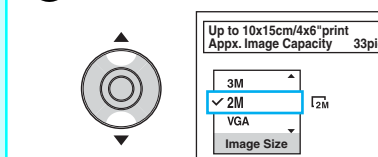

- The screen above is for still images.
- For movies, select [640(Fine)] ("Memory Stick PRO Duo" only), [640(Standard)] or [160].

4 Press [MENU]/[Image Size] to complete the setting.

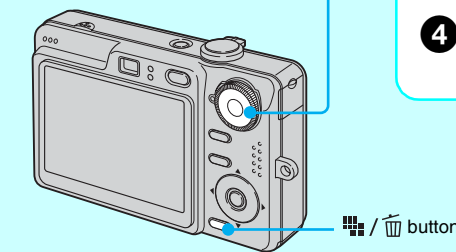

Using the AC Adaptor

You can connect the camera to a wall outlet (wall socket) using the AC-LS5K AC Adaptor (not supplied). → "User's Guide/Troubleshooting" (page 18).

To check the remaining battery time

Press POWER button to turn on and check the remaining battery on the LCD screen.

Battery remaining indicator					
Battery remaining guidelines	Sufficient power remaining	Battery half full	Battery low, recording/playback will stop soon.	Change the battery with fully charged one, or charge the battery. (The warning indicator flashes.)	

- It takes about one minute until the correct battery remaining indicator appears.
- The displayed battery remaining indicator may not be correct under certain circumstances.

To remove the battery pack

Slide the battery eject lever to pull the battery pack out. Be sure not to drop the battery pack when pulling it out.

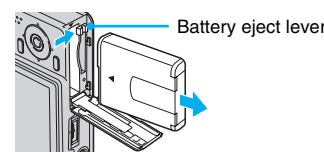

To use your camera abroad — Power sources

You can use your camera, the battery charger, and the AC-LS5K AC Adaptor (not supplied) in any country or region where the power supply is within 100 V to 240 V AC, 50/60 Hz.

Do not use an electronic transformer (travel converter), as this may cause a malfunction.

To change the date and time

Select [Clock Set] in the [Setup] screen and perform the procedure in step 3 above. → "User's Guide/Troubleshooting" (pages 46 and 55)

On the clock display

- Midnight is indicated as 12:00 AM, and noon as 12:00 PM.
- If you selected [D/M/Y] in step 1, set the time on a 24-hour cycle.

When turning on the power

- Unless you set the clock, the Clock Set screen appears each time the camera is turned on.
- Do not touch the lens portion as the cover opens and the lens portion extends. Also, do not leave the camera with the lens portion extended for a long period of time with the power off as this may cause malfunction.
- The following screen appears when the camera is turned on for the second time or afterwards.

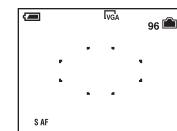

To turn off the power

Press the POWER button again.

- If the camera is running on battery power and you do not operate the camera for about three minutes, the camera turns off automatically to prevent wearing down the battery pack (Auto power-off function).

Changing the language setting

You can change the screen display to show messages in a specified language. To change the language setting, press MENU to display the menu screen. Select [Setup] with the control button, then, select [Language] in [Setup1], and select the desired language. → "User's Guide/Troubleshooting" (page 53)

On still image sizes

For details on the image size → "User's Guide/Troubleshooting" (page 15)

The default settings are marked with ✓.

Image size	Guidelines	No. of images	Printing
✓ 6M	Up to A4/8×10" print	Less ↑ ↓ More	Fine ↑ ↓ Rough
3:2 ¹⁾	Match 3:2 Aspect Ratio		
3M	Up to 13×18cm/5×7" print		
2M	Up to 10×15cm/4×6" print		
VGA	For E-mail		
16:9 ²⁾	Display On 16:9 HDTV ³⁾		

¹⁾ Images are recorded in the same 3:2 aspect ratio as photograph printing paper or postcards, etc.
²⁾ Both edges of the image may be cut off when printing → "User's Guide/Troubleshooting" (page 89)
³⁾ By using a Memory Stick slot or USB connection, you can enjoy higher quality images.

On the recordable number of still images and recordable time of movies

Recordable number of still images and recordable time of movies vary depending on the image size selected.

For details on recordable number or time → "User's Guide/Troubleshooting" (page 24)

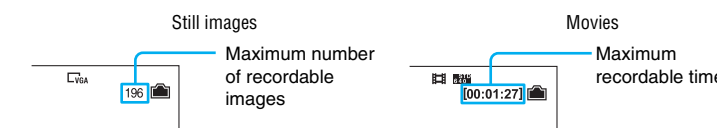

- The number of recordable images and time can differ according to shooting conditions.

To remove a "Memory Stick Duo"

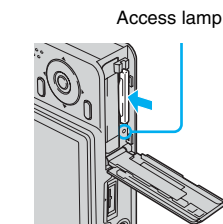

Open the battery/"Memory Stick Duo" cover, then push the "Memory Stick Duo" in once.

When the access lamp is lit

Never remove the battery/"Memory Stick Duo" or turn off the power. The data may be corrupted.

